



Denmark Hill | London | SE5 8EB

Freehold

£600,000

- Three double bedrooms
- Period mansion block
- Garage
- Off street parking
- Pretty views
- Herne Hill
- Sought after school catchment
- Dulwich Village
- Ruskin Park
- Balcony



Rutland Court is a sought-after period mansion block, located at the top of Denmark Hill, near Ruskin Park. A charming, bright, very spacious, three double bedrooms apartment with French doors onto a balcony giving pretty view over the communal gardens. Architectural and period features throughout the building including a fully refurbished brass passenger lift. A desirable location with easy access to Dulwich Village & Herne Hill. Off street parking, garages & communal gardens. Location is very convenient for Denmark Hill, & North Dulwich Stations, catchment for excellent local schools.



Energy Efficiency Rating		
	Current	Potential
<i>Very energy efficient - lower running costs</i>		
(92+) A		
(81-91) B		83
(69-80) C	77	
(55-68) D		
(39-54) E		
(21-38) F		
(1-20) G		
<i>Not energy efficient - higher running costs</i>		
England & Wales	EU Directive 	

FIRST FLOOR
1022 sq.ft. (94.9 sq.m.) approx.

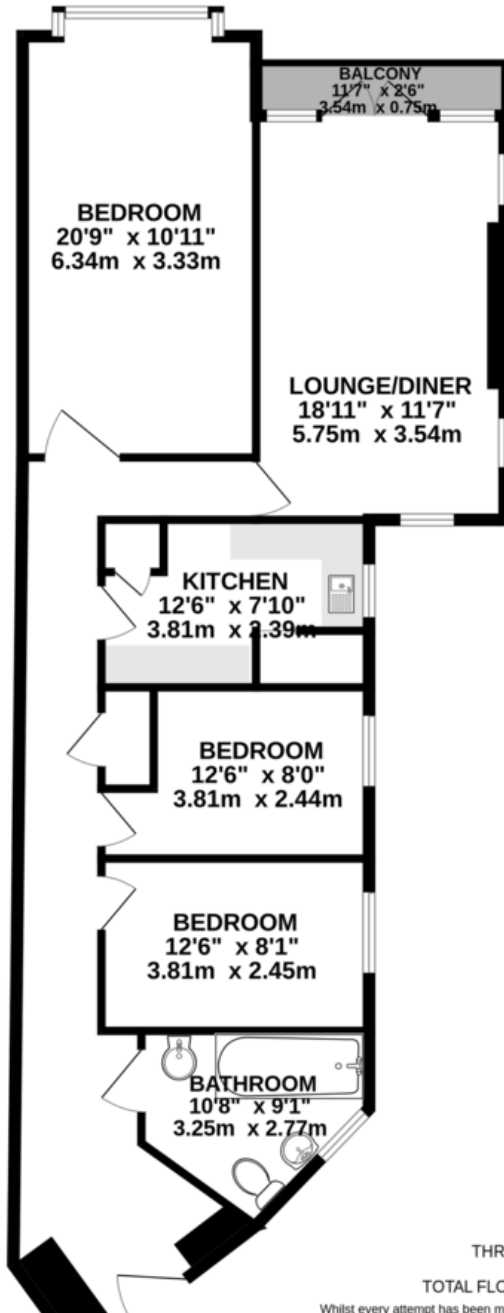

THREE BEDROOM, FIRST FLOOR FLAT

TOTAL FLOOR AREA : 1109sq.ft. (103.0 sq.m.) approx.

Whilst every attempt has been made to ensure the accuracy of the floorplan contained here, measurements of doors, windows, rooms and any other items are approximate and no responsibility is taken for any error, omission or mis-statement. This plan is for illustrative purposes only and should be used as such by any prospective purchaser. The services, systems and appliances shown have not been tested and no guarantee as to their operability or efficiency can be given.
Made with Metropix ©2024

Viewing Arrangements

Strictly by appointment

Contact Details

121 Denmark Hill

London

SE5 8EN

www.urbanvillagehomes.co.uk

sales@urbanvillagehomes.com

020 3519 9121

Agents Note: Whilst every care has been taken to prepare these sales particulars, they are for guidance purposes only. All measurements are approximate and for general guidance purposes only and whilst every care has been taken to ensure their accuracy, they should not be relied upon and potential buyers are advised to recheck the measurements