



Camberwell Grove | London | SE5

%tenure%

£1,400 pcm

- Camberwell Grove
- Basement
- Large apartment
- Period features
- Small rear yard
- Modern Kitchen
- Well presented
- Excellent location
- Available now
- Part / mostly furnished

Urban Village. A well presented, spacious and light apartment on the very popular Camberwell Grove, SE5. The basement floor of an elegant Georgian Townhouse, approached through a pretty front garden, with iron spiral staircase to the lower ground floor. A double bedroom, with two fitted cupboards, large lounge, with a period fireplace and wood burning stove, slightly open plan to a heritage style kitchen with butcher block work surfaces and stylish fittings. There is a very small yard at the rear, enabling you to have the back door open on summer evenings. Excellent for Denmark Hill Station, Kings College Hospital, Camberwell. Available 9th June, part / mostly furnished.

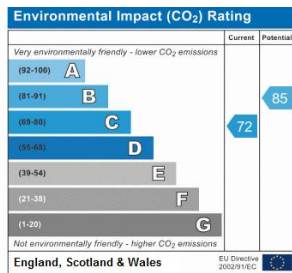
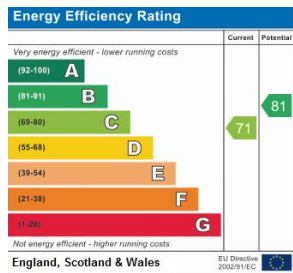

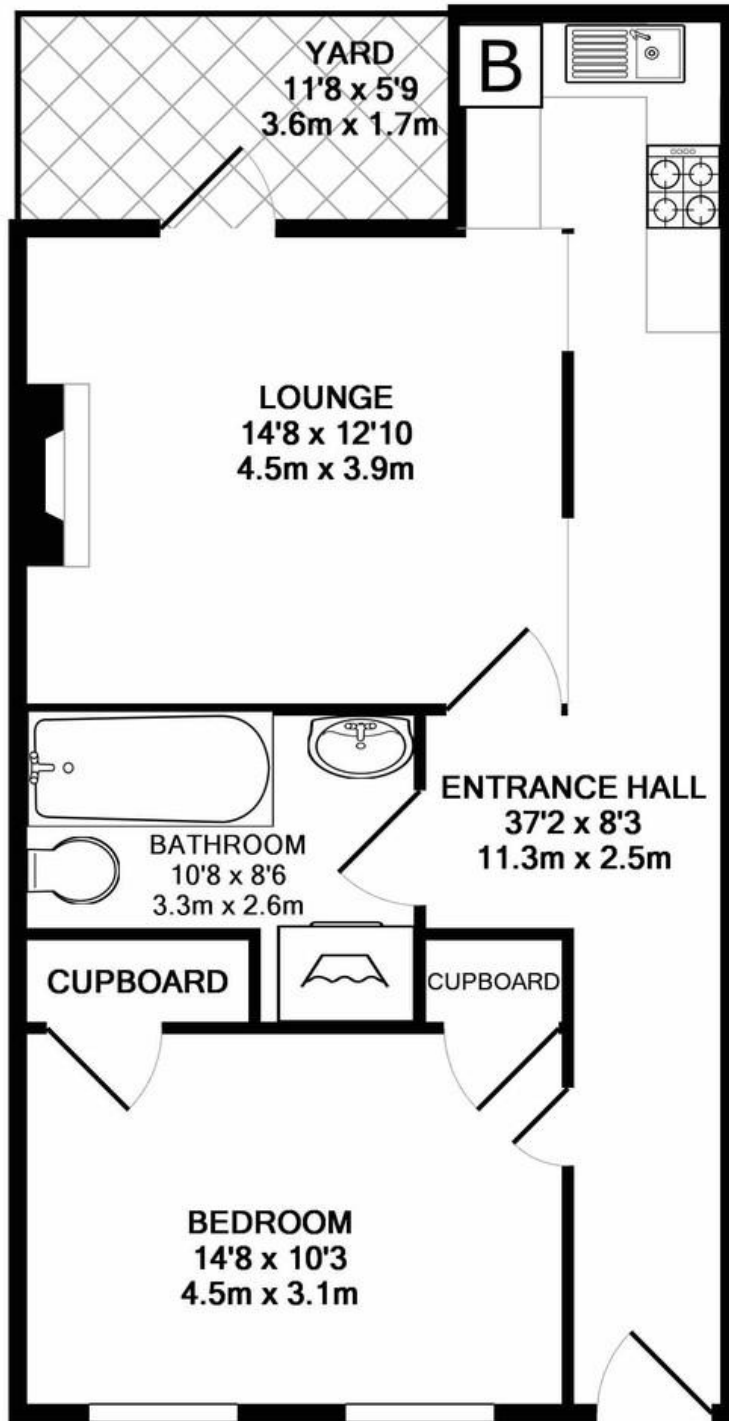

Viewing Arrangements

Strictly by appointment

Contact Details

121 Denmark Hill

London

SE5 8EN

www.urbanvillagehomes.co.uk

lettings@urbanvillagehomes.com

020 3519 9121

APPROX. FLOOR AREA 638 SQ.FT. (59.2 SQ.M.)

It has been made to ensure the accuracy of the floor plan contained here, measurements and any other items are approximate and no responsibility is taken for any error, omissions or inaccuracy. This plan is for illustrative purposes only and should be used as such by any prospective buyers. Any services, systems and appliances shown have not been tested and no guarantee as to their operability or efficiency can be given.

Made with Metropix ©2017

Agents Note: Whilst every care has been taken to prepare these sales particulars, they are for guidance purposes only. All measurements are approximate and for general guidance purposes only and whilst every care has been taken to ensure their accuracy, they should not be relied upon and potential buyers are advised to recheck the measurements.