



Grovelands Close | London | SE5

- One double bedroom
- Ground floor
- Private front garden
- Quiet development
- Kings College Hospital
- Denmark Hill Station
- Local amenities
- Off Camberwell Grove
- Ruskin Park
- Unfurnished

£1,350 pcm



One double bedroom apartment with private front garden, very close to Denmark Hill Station and Kings College Hospital. Available to rent, in the popular Groveland's Close development, off of Camberwell Grove, allowing excellent access to shops, bars, restaurants and transport. Available furnished 16/03/2022. Would suit a single occupant or professional couple.



Energy Efficiency Rating		
	Current	Potential
<i>Very energy efficient - lower running costs</i>		
(92-100) A		
(81-91) B		81
(69-80) C	70	
(55-68) D		
(39-54) E		
(21-38) F		
(1-20) G		
<i>Not energy efficient - higher running costs</i>		

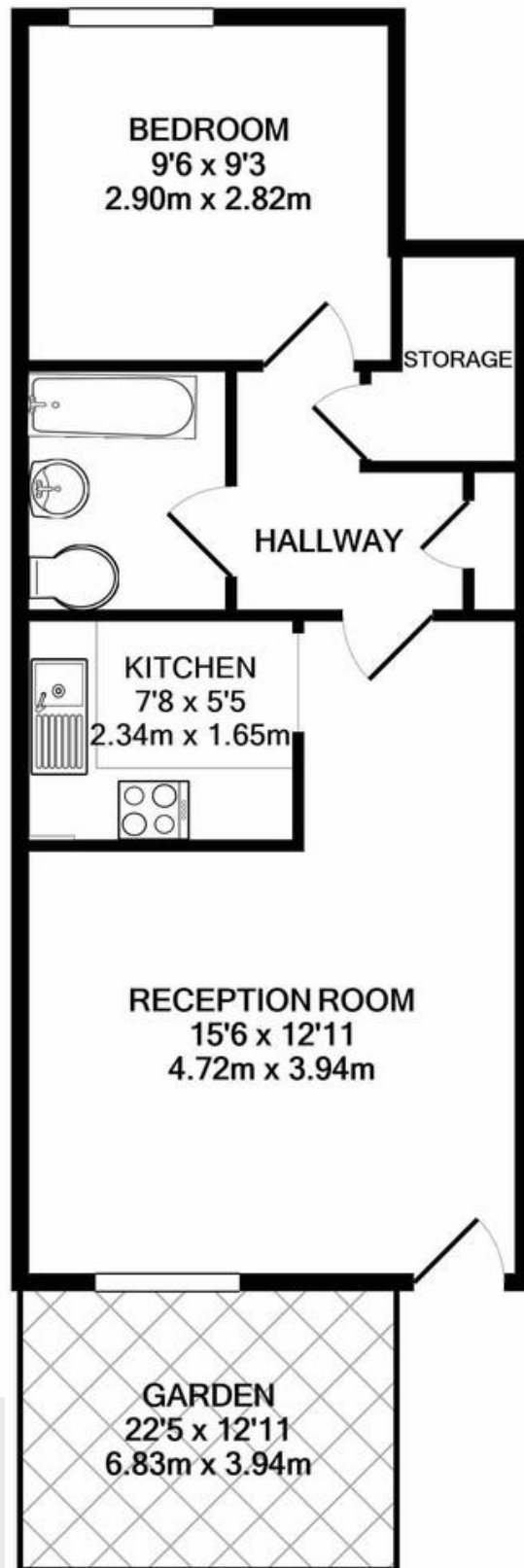

Viewing Arrangements

Strictly by appointment

Contact Details

121 Denmark Hill

London

SE5 8EN

www.urbanvillagehomes.co.uk

lettings@urbanvillagehomes.com

020 3519 9121

APPROX. FLOOR AREA 455 SQ.FT. (42.3 SQ.M.)

It has been made to ensure the accuracy of the floor plan contained here, measurements are approximate and any other items are approximate and no responsibility is taken for any error, omission or inaccuracy. This plan is for illustrative purposes only and should be used as such by any prospective buyer. Services, systems and appliances shown have not been tested and no guarantee as to their operability or efficiency can be given.

Agents Note: Whilst every care has been taken to prepare these sales particulars, they are for guidance purposes only. All measurements are approximate and for general guidance purposes only and whilst every care has been taken to ensure their accuracy, they should not be relied upon and potential buyers are advised to recheck the measurements.