



Peckham Road | London | SE5

£1,400 pcm

- Two double bedrooms
- Fully furnished
- Third floor
- Lots of natural light
- Peckham
- Camberwell
- Kings College Hospital
- Excellent bus routes
- Local parks and green spaces
- Local shops and bars



Two bed flat on the third floor of a purpose built block. The flat is in good condition and comprises of: 2 double bedrooms, a bathroom, a separate kitchen and a light reception room. Peckham Rye Station is your closest 8 minutes walk. Denmark Hill Station isn't much further a 10 minute walk. Both offer main line and London Overground services. Camberwell and Peckham are both close for buses, places to eat, drink, and things to do. Offered fully furnished and available immediately

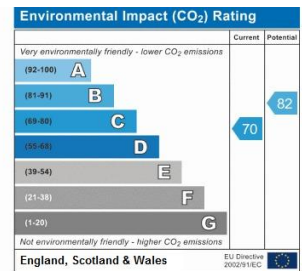
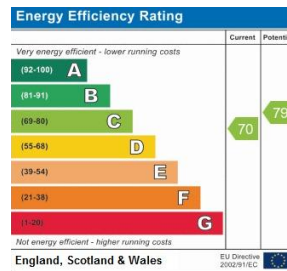

Address:
37 longleigh house
Reference:
37 longleigh house

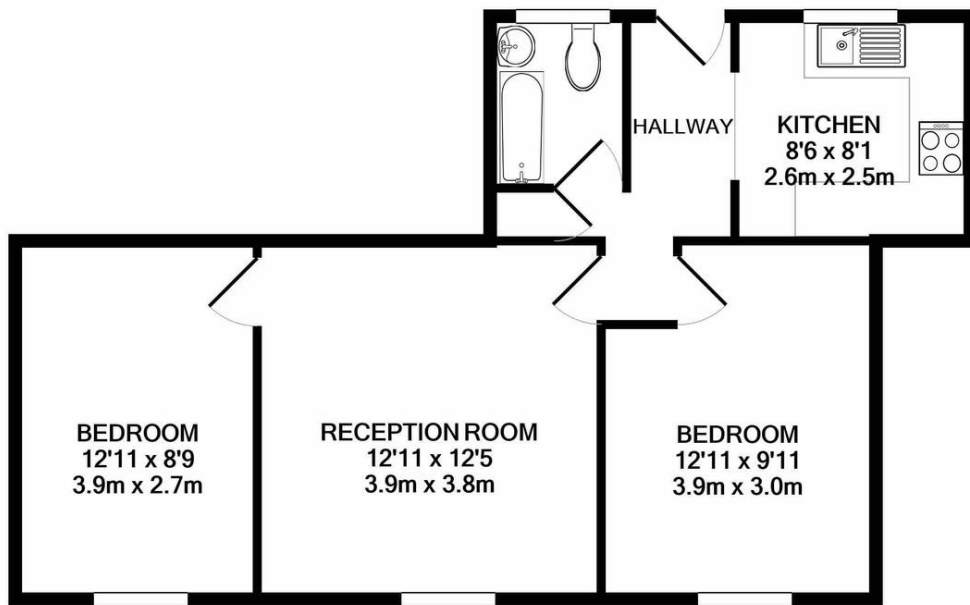

TOTAL APPROX. FLOOR AREA 542 SQ.FT. (50.3 SQ.M.)

Whilst every attempt has been made to ensure the accuracy of the floor plan contained here, measurements of doors, windows, rooms and any other items are approximate and no responsibility is taken for any error, omission, or mis-statement. This plan is for illustrative purposes only and should be used as such by any prospective purchaser. The services, systems and appliances shown have not been tested and no guarantee as to their operability or efficiency can be given

Made with Metropix ©2020

Viewing Arrangements

Strictly by appointment

Contact Details

121 Denmark Hill

London

SE5 8EN

www.urbanvillagehomes.co.uk

lettings@urbanvillagehomes.com

020 3519 9121

Agents Note: Whilst every care has been taken to prepare these sales particulars, they are for guidance purposes only. All measurements are approximate and are for general guidance purposes only and whilst every care has been taken to ensure their accuracy, they should not be relied upon and potential buyers are advised to recheck the measurements