



Finsen Road | London | SE5

Freehold

£1,400,000

- Four double bedrooms
- Side return extension
- High specification
- Separate laundry / utility
- Lovely views!
- Overlooking Ruskin Park
- Denmark Hill & Herne Hill
- Farmers Market
- Brixton Restaurants & Tube
- Potential to extend into loft adding 2 rooms



An impeccable four-bedroom house on the desirable Finsen Road overlooking Ruskin park; one of the most photographed roads in London (Telegraph press). The house is very well presented and has a large extension to the side and bi-fold glass doors framing the back garden. The front room can be used as a 4th bedroom (as marketed now). There is also scope to extend into the large loft and add 2 further bedrooms and a bathroom. The kitchen dining room, is very high specification and features a separate self contained, laundry and utility area. Upstairs there are three double bedrooms; with views over Ruskin Park and the London Skyline. A large double sized modern family bathroom (incorporating the old 4th bedroom to make it bigger). Walking distance to Herne Hill, Camberwell and Denmark Hill



GROUND FLOOR
974 sq.ft. (90.5 sq.m.) approx.



1ST FLOOR
754 sq.ft. (70.1 sq.m.) approx.

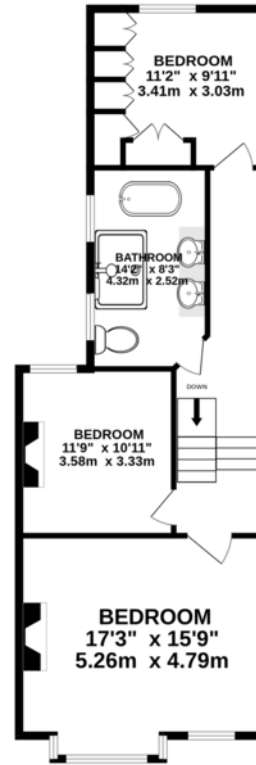

TOTAL FLOOR AREA : 1195sq.ft. (111.0 sq.m.) approx.

Whilst every attempt has been made to ensure the accuracy of the floorplan contained here, measurements of doors, windows, rooms and any other items are approximate and no responsibility is taken for any error, omission or mis-statement. This plan is for illustrative purposes only and should be used as such by any prospective purchaser. The services, systems and appliances shown have not been tested and no guarantee as to their operability or efficiency can be given.
Made with Metropix ©2024

Viewing Arrangements

Strictly by appointment

Contact Details

121 Denmark Hill

London

SE5 8EN

www.urbanvillagehomes.co.uk

sales@urbanvillagehomes.com

020 3519 9121

Agents Note: Whilst every care has been taken to prepare these sales particulars, they are for guidance purposes only. All measurements are approximate and for general guidance purposes only and whilst every care has been taken to ensure their accuracy, they should not be relied upon and potential buyers are advised to recheck the measurements