

Urban Village

www.urbanvillagehomes.com

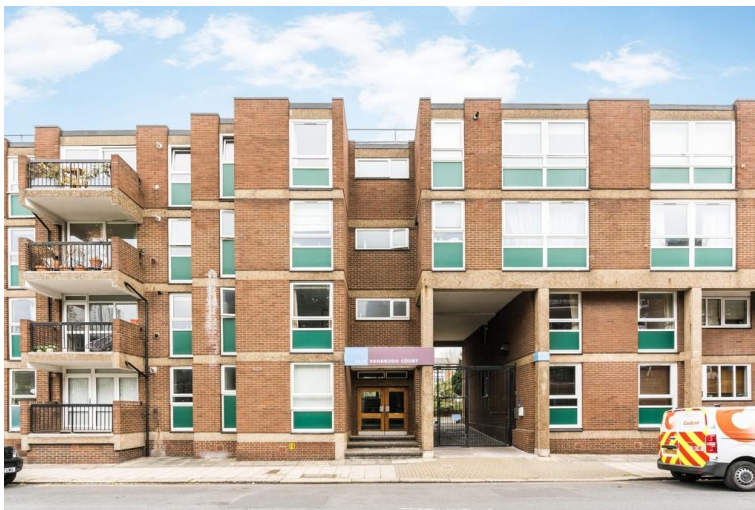

Wincott Street | London | SE11 4NS

Leasehold

£500,000

- Popular 1970s building
- Ground floor
- Communal garden
- Sought after building
- Two bedrooms
- Good natural light
- Excellent location
- Southbank
- Kennington / Waterloo
- Lease 109 years



Vanburgh Court is an Austere 1970s building in Southwark within walking distance to Waterloo and the Southbank. This apartment has two double bedrooms, a good sized lounge with sliding doors leading to a balcony. There is a good amount of natural light throughout and the apartment is in good decorative order. Transport is excellent from this part of Central London and Covent Garden, Westminster and Borough Market are all within easy reach. Currently rented out on an assured shorthold tenancy, the property will be sold chain free.



%epcGraph_c_1_300%

GROUND FLOOR
762 sq.ft. (70.8 sq.m.) approx.

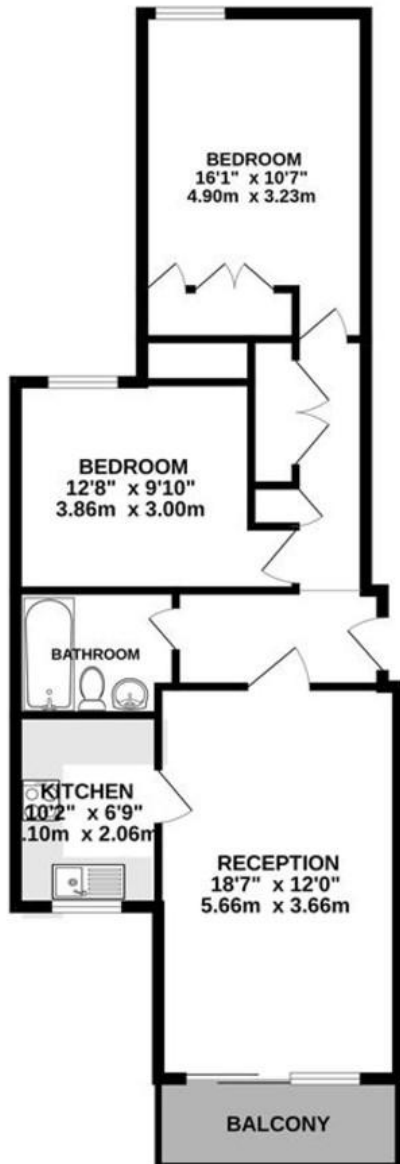

Viewing Arrangements

Strictly by appointment

Contact Details

121 Denmark Hill

London

SE5 8EN

www.urbanvillagehomes.co.uk

sales@urbanvillagehomes.com

020 3519 9121

TOTAL FLOOR AREA : 762 sq.ft. (70.8 sq.m.) approx.

Whilst every attempt has been made to ensure the accuracy of the floorplan contained here, measurements of doors, windows, rooms and any other items are approximate and no responsibility is taken for any error, omission or mis-statement. This plan is for illustrative purposes only and should be used as such by any prospective purchaser. The services, systems and appliances shown have not been tested and no guarantee as to their operability or efficiency can be given.
Made with Metropix ©2023

Agents Note: Whilst every care has been taken to prepare these sales particulars, they are for guidance purposes only. All measurements are approximate and are for general guidance purposes only and whilst every care has been taken to ensure their accuracy, they should not be relied upon and potential buyers are advised to recheck the measurements