



16 Wingmore Road | London | SE24
OAS

%tenure%

£2,900 pcm

- Victorian townhouse
- Three floors
- Three double bedrooms
- Large bathroom
- Ground floor W.C
- Pretty rear garden (small)
- New Kitchen
- Redecorated
- Brixton tube & Loughborough J
- Available 28/07/2023



Urban Village. A beautifully presented mid terrace Victorian Townhouse. Located within walking distance of Brixton tube, Loughborough Junction and Denmark Hill Stations. Arranged over three floors with a pretty rear garden. There are three double bedrooms a bathroom and ground floor W.C. New kitchen and recently re decorated. Open plan light and spacious reception room, modern and well presented kitchen. The house is offered for a long term, part - furnished let. Available 28/07/2023

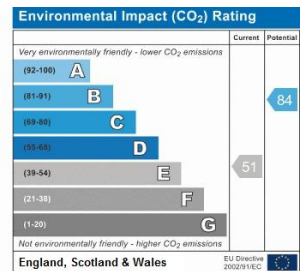
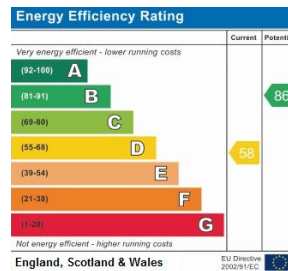

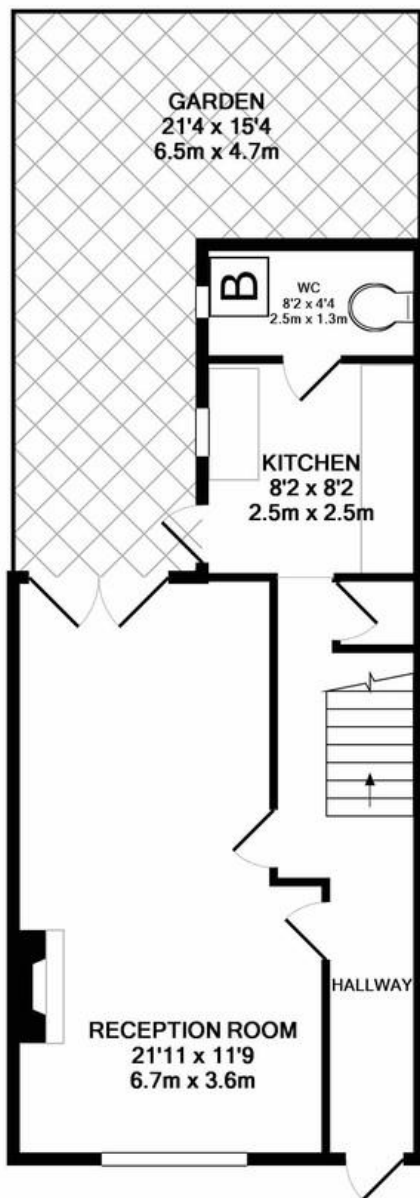

GROUND FLOOR
APPROX. FLOOR
AREA 439 SQ.FT.
(40.7 SQ.M.)

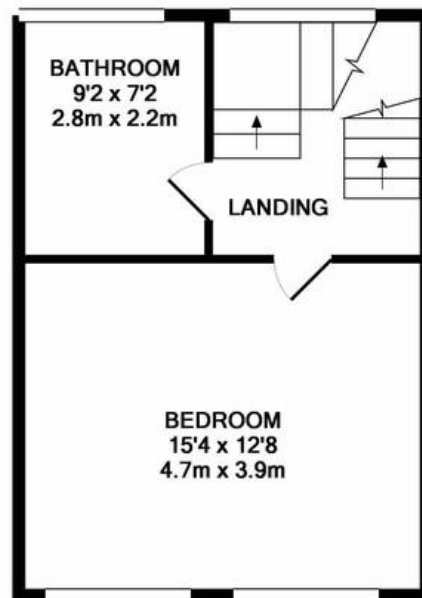

1ST FLOOR
APPROX. FLOOR
AREA 336 SQ.FT.
(31.2 SQ.M.)

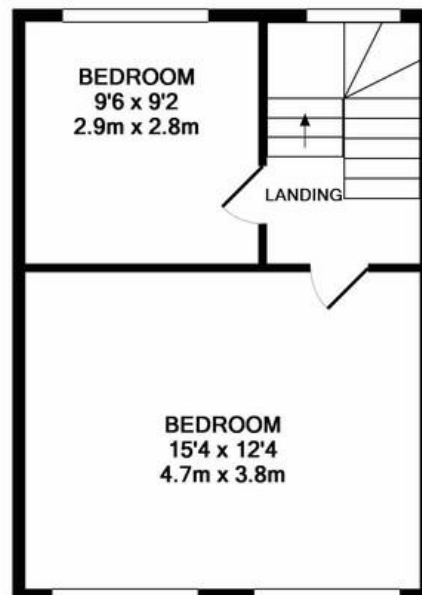

2ND FLOOR
APPROX. FLOOR
AREA 336 SQ.FT.
(31.2 SQ.M.)

TOTAL APPROX. FLOOR AREA 1110 SQ.FT. (103.1 SQ.M.)

Whilst every attempt has been made to ensure the accuracy of the floor plan contained here, measurements of doors, windows, rooms and any other items are approximate and no responsibility is taken for any error, omission, or mis-statement. This plan is for illustrative purposes only and should be used as such by any prospective purchaser. The services, systems and appliances shown have not been tested and no guarantee as to their operability or efficiency can be given

Made with Metropix ©2018

Viewing Arrangements

Strictly by appointment

Contact Details

121 Denmark Hill

London

SE5 8EN

www.urbanvillagehomes.co.uk

lettings@urbanvillagehomes.com

020 3519 9121

Agents Note: Whilst every care has been taken to prepare these sales particulars, they are for guidance purposes only. All measurements are approximate and for general guidance purposes only and whilst every care has been taken to ensure their accuracy, they should not be relied upon and potential buyers are advised to recheck the measurements