



PERSEVERANCE WORKS

25 Hackney Rd, London E2 7NX

THE WORKPLACE CO. 



DESCRIPTION

Completely unique to the industry, The Lordship Residency was created in order to preserve the famous location house Lordship Park, which has recently decided to close its doors. Previously ZONE, we transformed our studio so that it would replicate Lordship by moving in all of the most iconic features, including a copper wall, swing chair, velvet antique sofa, Parisian bed, and two French doorways, creating beautiful shoot opportunities. With different backdrops catching your eye each way you turn, The Lordship Residency resembles a Palace of Versailles with a wave of retro 60's eclecticism. It also features shutter windows with an abundance of daylight, bespoke kitchen, private toilets and easy access.

PRICE: Offers in the excess of £2,100,000.

LEGAL COSTS Each party is to be responsible for their own professional and legal costs incurred in the transaction. If you would like to discuss the property or arrange a viewing, please contact the sole selling agents: Nick Simmonds

AMENITIES

- Total Area: 2250 SQ FT/ 310 SQM
- Ceiling Height: 3.4M / 11 FT
- U/B HEIGHT 3.2M / 10 FT
- Power: 1 X 63AMP 2 X 32AMP 21 X 13AMP
- Shoot Kitchen
- Dressing room
- Hair and Makeup Area
- Daylight & Blackout
- 1 toilet + access to lounge bathrooms



CONTACT

Nick Simmonds

07900247577

ns@theworkplacecompany.co.uk



UNIT 202-203, 1ST FLOOR SMITHFIELD MARKET,
EAST POULTRY AVENUE, LONDON, EC1A 9LH

Misrepresentation Act 1967: These particulars are believed to be correct but their accuracy is not guaranteed and they do not form part of any contract. Unless otherwise stated, all prices and rents are quoted exclusive of VAT

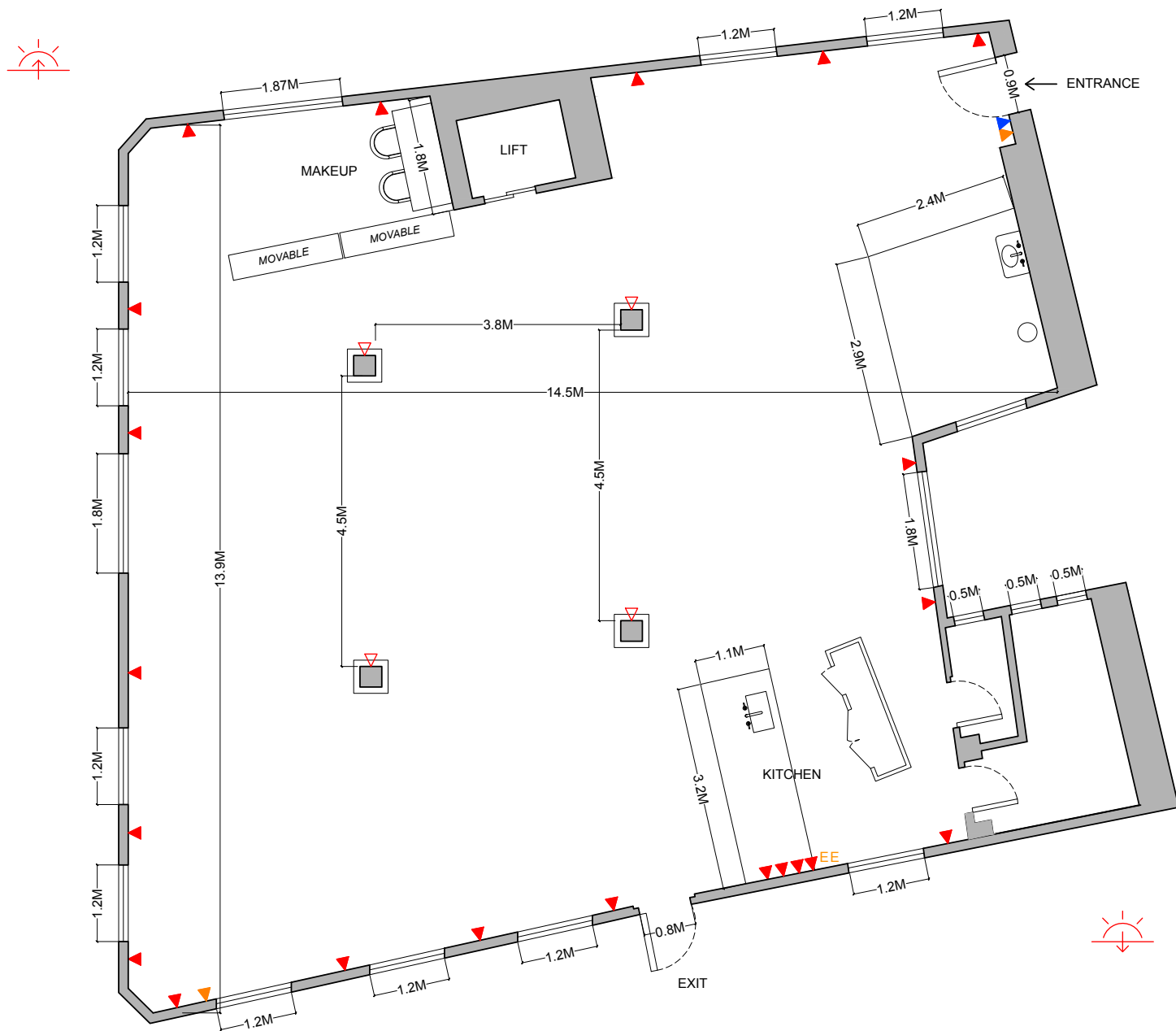

FLOORPLAN

25 Hackney Rd, London E2 7NX