



5 Bull Lane

, Bristol, BS5 8AB

£225,000



Nestled in the charming area of Bull Lane, Bristol, this delightful property offers a perfect blend of comfort and modern living. With a well-designed layout spanning 603 square feet, it features two inviting bedrooms, ideal for a small family or professionals seeking a peaceful retreat. The single reception room provides a warm and welcoming space, perfect for relaxation or entertaining guests.

The property boasts a contemporary bathroom, ensuring convenience and style for everyday living. Built in 2003, it benefits from modern construction standards, providing a sense of security and efficiency. Crews Hole is close to Troopers Hill & Conham Nature Reserve. Boasting lovely views

Situated in a vibrant community, residents will enjoy easy access to local amenities, parks, river and transport links, making it an excellent choice for those who appreciate both tranquility and connectivity. This property is a wonderful opportunity for anyone looking to settle in a desirable part of Bristol. Don't miss the chance to make this charming residence your new home.



Hallway

Entrance door, airing cupboard, door to:-

Lounge/Diner 14'1" x 12'0" (4.30m x 3.66m)

Double glazed french doors, double glazed window, electric heater, opening to:-

Kitchen 10'2" x 7'1" (3.11m x 2.16m)

Matching range of wall and base units with worktop space over, sink unit, built in cooker, fridge/freezer, space for washing machine, double glazed window

Bathroom 6'7" x 6'6" (2.01m x 1.99m)

Three piece suite comprising of panelled bath with shower over, low level wc, wash hand basin, double glazed window, electric heater

Bedroom 1 11'10" x 9'9" (3.62m x 2.99m)

Double glazed window, two wardrobes, small storage cupboard, electric heater

Bedroom 2 11'6" x 10'5" (3.51m x 3.18m)

Double glazed window, electric heater

Area Map



Floor Plans

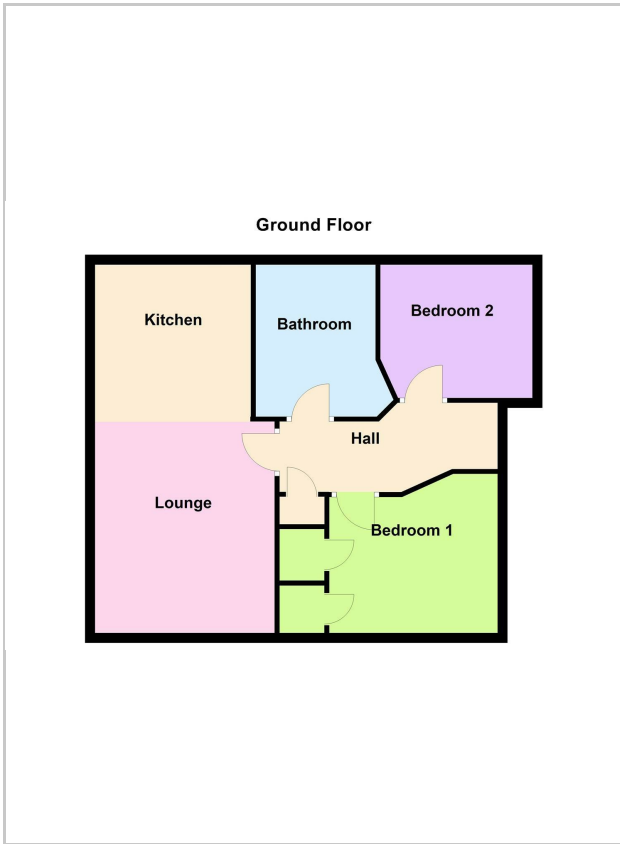

Energy Efficiency Graph

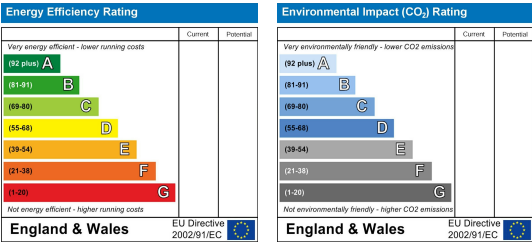

These particulars, whilst believed to be accurate are set out as a general outline only for guidance and do not constitute any part of an offer or contract. Intending purchasers should not rely on them as statements of representation of fact, but must satisfy themselves by inspection or otherwise as to their accuracy. No person in this firms employment has the authority to make or give any representation or warranty in respect of the property.