



12 Siston Common

, Bristol, BS30 5LP

Offers In The Region Of £389,950



PERFECTLY SET IN A POSITION OVERLOOKING SISTON COMMON - TWO BEDROOM END TERRACE COTTAGE. Offering lots of original features throughout, , open plan living space to the ground floor, lounge with feature stone fireplace housing log burner, utility area, downstairs shower room with underfloor heating, and two good sized bedrooms to the first floor. The property benefits from Large Garden, Parking To Rear, Gas Central Heating System.



- Kitchen 11'5" x 8'7" (3.48m x 2.63m)
- Dining Area 13'4" x 10'11" (4.08m x 3.34m)
- Lounge 12'0" x 11'5" (3.68m x 3.49m)
- Shower Room
2.62m x 1.67m
- Utility/Boot Room 9'8" x 8'8" (2.97m x 2.65m)
- Half Landing
- Bedroom 1 12'0" x 11'7" (3.68m x 3.55m)
- Bedroom 2 14'0" x 8'3" (4.27m x 2.52m)
- Garden
- Parking

Area Map



Floor Plans

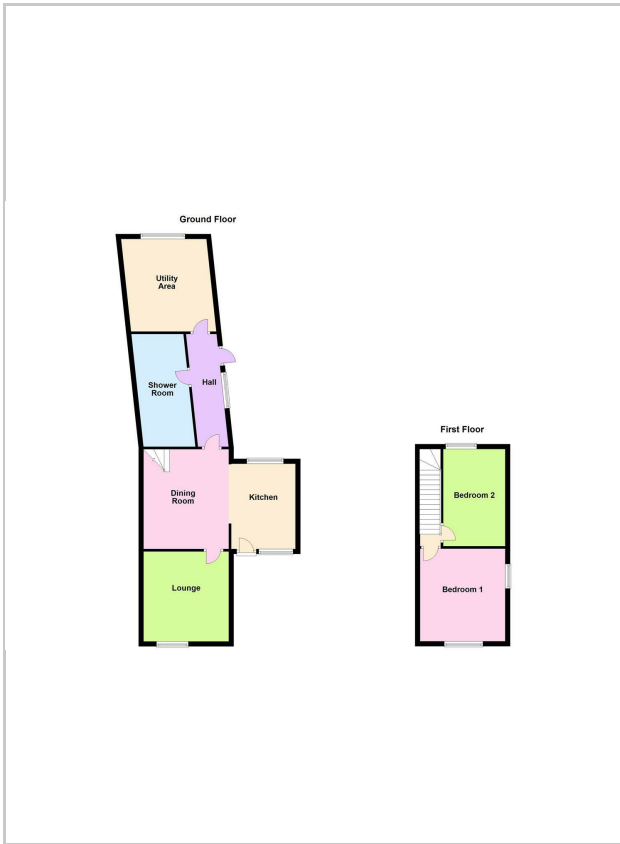

Energy Efficiency Graph

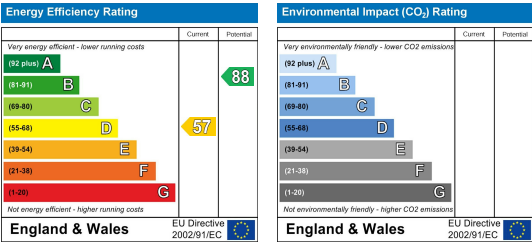

These particulars, whilst believed to be accurate are set out as a general outline only for guidance and do not constitute any part of an offer or contract. Intending purchasers should not rely on them as statements of representation of fact, but must satisfy themselves by inspection or otherwise as to their accuracy. No person in this firms employment has the authority to make or give any representation or warranty in respect of the property.