



Aintree Way, Dudley DY1 2SL

welcome to

Aintree Way, Dudley

**** FOUR BEDROOM DETACHED PROPERTY ** SPACIOUS LOUNGE ** KITCHEN DINER ** UTILITY ** D/STAIRS SHOWER ROOM & FAMILY BATHROOM
** GARAGE AND DRIVEWAY ** HIGHLY DESIRABLE AREA ** WALKING DISTANCE TO LOCAL SCHOOLS ** GREAT TRANSPORT LINKS ** IDEAL FAMILY
HOME ** NO CHAIN ****



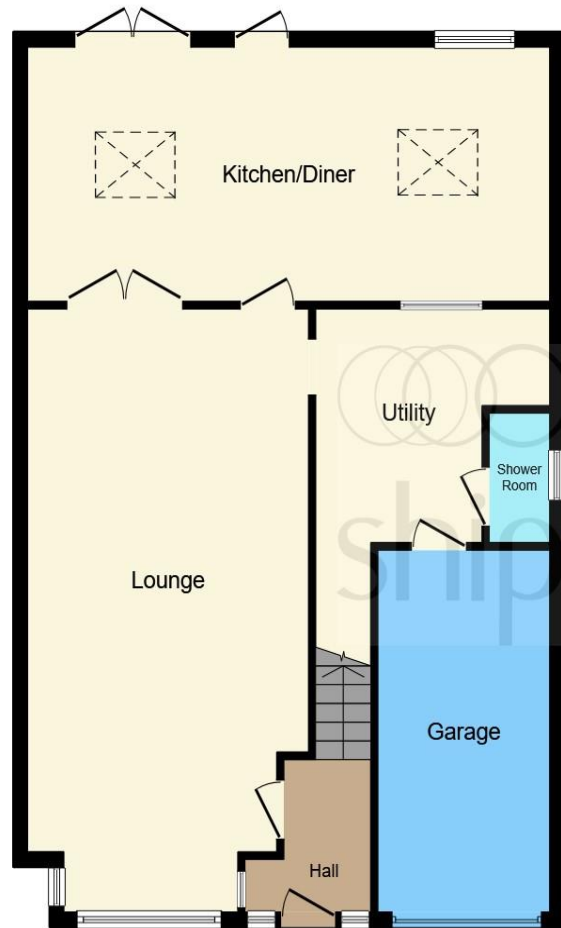

Ground Floor



First Floor

Entrance Hall

Lounge

26' 8" into bay x 13' 10" (8.13m into bay x 4.22m)

Kitchen Diner

24' 9" x 11' 3" (7.54m x 3.43m)

Utility Room

6' 6" ex bay x 10' 4" ex bay (1.98m ex bay x 3.15m ex bay)

Downstairs Shower Room

Hallway

Bedroom One

13' 5" x 10' 10" (4.09m x 3.30m)

Bedroom Two

10' 8" x 7' 11" (3.25m x 2.41m)

Bedroom Three

11' 5" x 8' (3.48m x 2.44m)

Bedroom Four

9' 6" x 7' 7" (2.90m x 2.31m)

Bathroom

Garage

15' 10" x 9' 10" (4.83m x 3.00m)

Front Garden

Rear Garden

Agents Note

This floor plan is for illustrative purposes only. It is not drawn to scale. Any measurements, floor areas (including any total floor area), openings and orientation are approximate. No details are guaranteed, they cannot be relied upon for any purpose and they do not form part of any agreement. No liability is taken for any error, omission or misstatement. A party must rely upon its own inspection(s). Powered by www.focalagent.com

welcome to

Aintree Way, Dudley

- Well-presented four bedroom detached house
- Spacious lounge
- Fitted kitchen and Utility
- Downstairs shower room and upstairs family bathroom
- Garage and Driveway

Tenure: Freehold EPC Rating: C

offers over

£395,000



Please note the marker reflects the postcode not the actual property

view this property online shipways.co.uk/Property/DLY105329



Property Ref:
DLY105329 - 0004

1. MONEY LAUNDERING REGULATIONS Intending purchasers will be asked to produce identification documentation at a later stage and we would ask for your co-operation in order that there is no delay in agreeing the sale. 2. These particulars do not constitute part or all of an offer or contract. 3. The measurements indicated are supplied for guidance only and as such must be considered incorrect. Potential buyers are advised to recheck measurements before committing to any expense. 4. We have not tested any apparatus, equipment, fixtures or services and it is in the buyers interest to check the working condition of any appliances. 5. Where an EPC, or a Home Report (Scotland only) is held for this property, it is available for inspection at the branch by appointment. If you require a printed version of a Home Report, you will need to pay a reasonable production charge reflecting printing and other costs. 6. We are not able to offer an opinion either written or verbal on the content of these reports and this must be obtained from your legal representative. 7. Whilst we take care in preparing these reports, a buyer should ensure that his/her legal representative confirms as soon as possible all matters relating to title including the extent and boundaries of the property and other important matters before exchange of contracts.

Shipways is a trading name of Sequence (UK) Limited which is registered in England and Wales under company number 4268443, Registered Office is Cumbria House, 16-20 Hockliffe Street, Leighton Buzzard, Bedfordshire, LU7 1GN. VAT Registration Number is 500 2481 05.

shipways



01384 238779



dudley@shipways.co.uk



216 High Street, DUDLEY, West Midlands, DY1 1PB



shipways.co.uk