



Metropolitan Lofts, Parsons Street, Dudley, DY1 1JE

welcome to

Metropolitan Lofts, Parsons Street, Dudley

Shipways are pleased to present this STUNNING two bedroom penthouse apartment located in the heart of Dudley, Having local transport links into Birmingham City Centre and benefiting from the up and coming metro line, local amenities, schools and a short commute to Duncan Edwards Leisure Centre.



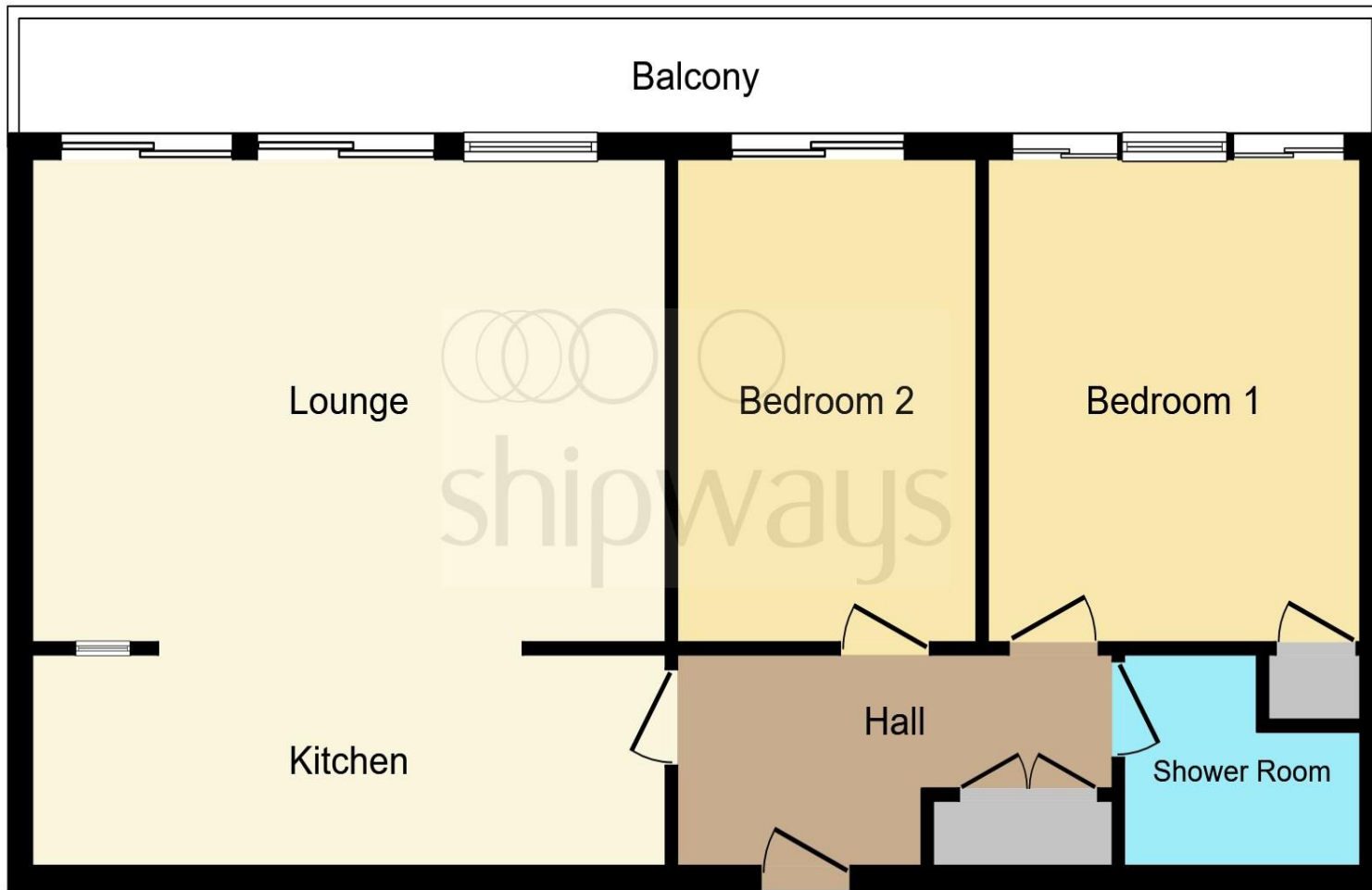

Entrance Hall

Kitchen/ Lounge

16' 6" x 16' 7" (5.03m x 5.05m)

Bedroom One

12' 8" x 10' 10" (3.86m x 3.30m)

Bedroom Two

12' 9" x 7' 1" (3.89m x 2.16m)

Bathroom

6' 10" x 4' 10" (2.08m x 1.47m)

Agents Notes

This floor plan is for illustrative purposes only. It is not drawn to scale. Any measurements, floor areas (including any total floor area), openings and orientation are approximate. No details are guaranteed, they cannot be relied upon for any purpose and they do not form part of any agreement. No liability is taken for any error, omission or misstatement. A party must rely upon its own inspection(s). Powered by www.focalagent.com

welcome to

Metropolitan Lofts Parsons Street, Dudley

- TWO BEDROOM PENTHOUSE
- OFFERED WITH NO ONWARD CHAIN
- OPEN PLAN LIVING
- SHOWER ROOM
- SECURE PARKING

Tenure: Leasehold EPC Rating: D

This is a Leasehold property with details as follows; Term of Lease 125 years from 29 Sep 2001. Should you require further information please contact the branch. Please Note additional fees could be incurred for items such as Leasehold packs.

offers over

£120,000



Please note the marker reflects the postcode not the actual property

view this property online shipways.co.uk/Property/DLY105137



Property Ref:
DLY105137 - 0006

1. MONEY LAUNDERING REGULATIONS Intending purchasers will be asked to produce identification documentation at a later stage and we would ask for your co-operation in order that there is no delay in agreeing the sale. 2. These particulars do not constitute part or all of an offer or contract. 3. The measurements indicated are supplied for guidance only and as such must be considered incorrect. Potential buyers are advised to recheck measurements before committing to any expense. 4. We have not tested any apparatus, equipment, fixtures or services and it is in the buyers interest to check the working condition of any appliances. 5. Where an EPC, or a Home Report (Scotland only) is held for this property, it is available for inspection at the branch by appointment. If you require a printed version of a Home Report, you will need to pay a reasonable production charge reflecting printing and other costs. 6. We are not able to offer an opinion either written or verbal on the content of these reports and this must be obtained from your legal representative. 7. Whilst we take care in preparing these reports, a buyer should ensure that his/her legal representative confirms as soon as possible all matters relating to title including the extent and boundaries of the property and other important matters before exchange of contracts.

shipways



01384 238779



dudley@shipways.co.uk



216 High Street, DUDLEY, West Midlands, DY1 1PB



shipways.co.uk