



Taylors

KINGSWINFORD, 58 Lifton Croft

£240,000

🛏 2 🚿 1 🛋 1



Available with NO UPWARD CHAIN, this SEMI DETACHED BUNGALOW is well located in a desirable 'cul de sac', upon the fringes of the 'Crestwood Park' development and offers a GOOD SIZED TWO BEDROOM layout. The property is set beyond the BLOCK PAVED DRIVEWAY and to the rear is a GOOD SIZED REAR GARDEN.

The accommodation requires updating, includes GAS CENTRAL HEATING (new boiler 2024), DOUBLE GLAZING and comprises: reception hall, lounge/ diner, kitchen, TWO GOOD SIZED BEDROOMS and bathroom.

The BLOCK PAVED DRIVEWAY provides off road parking and to the rear, the garden features good sized lawns with surrounding borders.

Lifton Croft forms a desirable cul de sac, which is well placed on 'Crestwood Park'. There are shops, bus routes nearby and there is easy access into the centre of Kingswinford. The Merry Hill Shopping Centre is also within easy reach.

Tenure: Freehold. Construction: brick with a pitched tiled roof.
Services: All mains services are connected. Broadband/Mobile coverage: Visit: checker.ofcom.org.uk/en-gb/broadband-coverage.
Council Tax Band B. EPC D. KINGSWINFORD OFFICE

Reception Hall - 3.56m x 0.94m (11'8" x 3'1")

Lounge Diner - 5.77m x 3.66m (18'11" x 12'0")

Kitchen - 2.64m x 2.39m (8'8" x 7'10")

Bedroom 1 - 3.61m x 3.1m (11'10" x 10'2")

Bedroom 2 - 3.05m x 2.69m (10'0" x 8'10")

Bathroom - 2.08m x 1.68m (6'10" x 5'6")





- NO UPWARD CHAIN
- TWO BEDROOMS
- BLOCK PAVED DRIVEWAY
- CONVENIENT FOR SHOPS & AMENITIES
- DOUBLE GLAZING
- SEMI DETACHED BUNGALOW
- CUL DE SAC
- REAR GARDEN
- GAS CENTRAL HEATING (NEW BOILER 2024)

Ground Floor

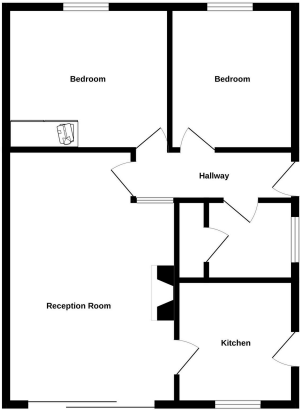

Measurements are approximate. See us in person. Measure the property if you are buying it.

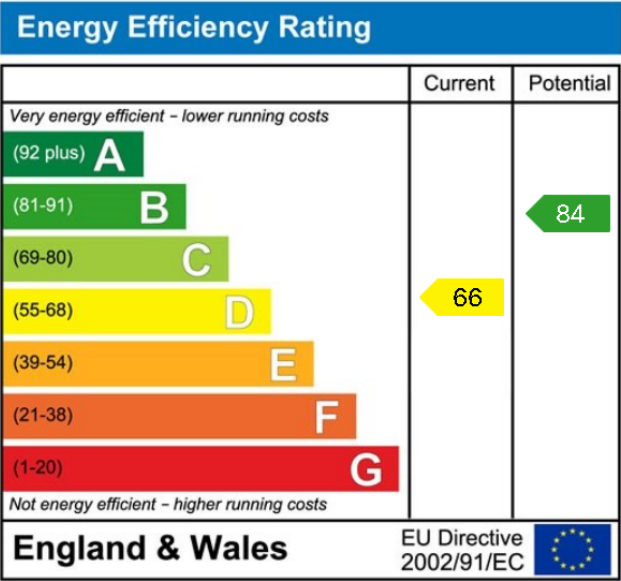

MISREPRESENTATION ACT 1967: These particulars do not constitute any part of an offer or a contract. Whilst every care is taken to ensure accuracy, no responsibility for errors or misdescription is accepted. Any intending purchaser must satisfy themselves by inspection or otherwise as to the correctness of each of the statements in these particulars. The vendor does not make nor give, and neither Taylors nor any person in their employment has any authority to make or give any representation or warranty whatsoever about this property. As the seller's estate agents, we are not surveyors or conveyancing experts, and we cannot comment on the property's condition or issues relating to the title or other legal issues that may affect this property unless we have been made aware of such matters. Interested parties should employ professionals to make such enquiries before making transactional decisions. **EPC:** can be supplied free of charge. **CONSUMER PROTECTION REGULATIONS (2008):** These particulars have been prepared with care and approved by the vendors (where possible) but are intended as a guide only, with measurements being approximate and usually the maximum size, which may include alcoves, recesses or otherwise as described, and you must NOT rely on them for any other purpose. The appearance of an item in any photograph does not mean that it forms part of the property or sale price. **FIXTURES AND FITTINGS:** Only those items specifically mentioned in these sales particulars are included in the sale price. Taylors have NOT tested any apparatus, equipment, fixture or fitting and cannot verify they are in working order or fit for their purpose. **PLANNING PERMISSION / BUILDING REGULATIONS:** Any reference to the property being extended, altered or converted in any way does not infer that planning permission or building regulations have been granted or applied for, nor do Taylors accept any responsibility for such not having been obtained. **FLOOR PLAN:** This plan is for illustrative purposes only. The services, systems and appliances shown have not been tested and no guarantee as to their operability or efficiency can be given.