

# ParaBar Estates



## St. Ediths Court, Billericay

£1,400 Per Month

- TWO BEDROOM APARTMENT
- SOUTH FACING BALCONY
- LIFT TO ALL FLOORS AND SECURITY ENTRY SYSTEM
- AVAILABLE NOW
- ENSUITE TO MASTER BEDROOM
- ALLOCATED PARKING SPACE
- SHORT WALK TO BILLERICAY STATION
- MODERN FITTED KITCHEN
- STONES THROW TO HIGH STREET
- 18FT LOUNGE

106 High Street, Billericay, Essex, CM12 9BY  
01277 65 65 63

info@parabar.co.uk  
www.parabar.co.uk

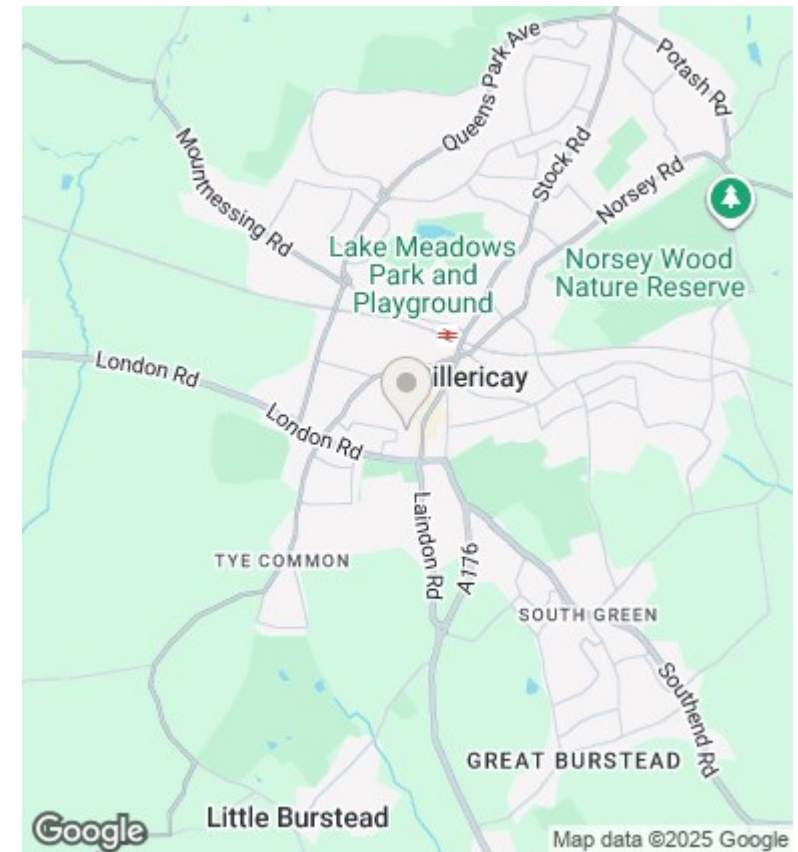
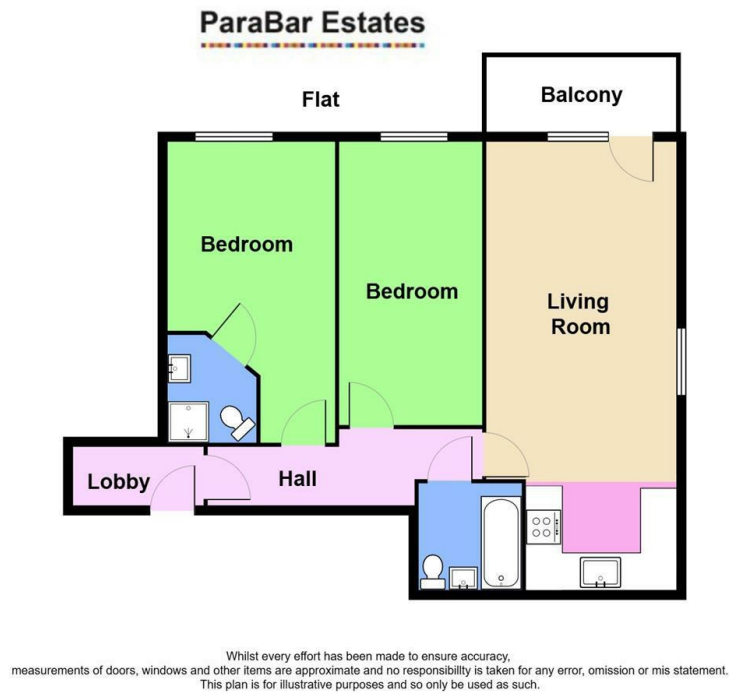

## Directions

106 High Street, Billericay, Essex, CM12 9BY  
01277 65 65 63

## Viewings

Viewings by arrangement only. Call 01277 65 65 63 to make an appointment.

## Council Tax Band

D

## EPC Rating:

B

Energy Efficiency Rating		
	Current	Potential
Very energy efficient - lower running costs		
(92 plus) <b>A</b>		
(81-91) <b>B</b>	85	85
(69-80) <b>C</b>		
(55-68) <b>D</b>		
(39-54) <b>E</b>		
(21-38) <b>F</b>		
(1-20) <b>G</b>		
Not energy efficient - higher running costs		
<b>England &amp; Wales</b>	EU Directive 2002/91/EC	

info@parabar.co.uk  
www.parabar.co.uk