

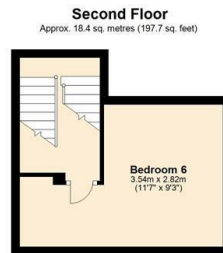

90 Mount Pleasant Road, Exeter, EX4 7AD

£3,380 Per Month

- £165.00 Per Person Per Week - 24/25
- Separate Utility
- Six Double Bedrooms With Study Space
- Courtyard Garden
- Open Plan Kitchen, Dining and Sitting Room
- Permit Parking

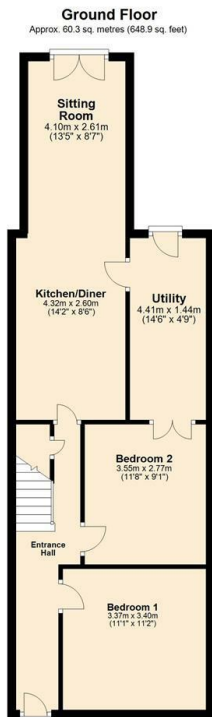

Total area: approx. 129.9 sq. metres (1398.7 sq. feet)



Directions

Viewings

Viewings by arrangement only. Call 01803 504000 to make an appointment.

Council Tax Band

C

EPC Rating:

D

Energy Efficiency Rating		Current	Potential
Very energy efficient - lower running costs			
(92 plus)	A		
(81-91)	B		75
(69-80)	C		
(55-68)	D	59	
(39-54)	E		
(21-38)	F		
(1-20)	G		
Not energy efficient - higher running costs			
England & Wales		EU Directive 2002/91/EC	