



**Keegan White**  
ESTATE AGENTS

23 The Roperies | £420,000



## Features

- Four Double Bedrooms
- Kitchen & Separate Living Room
- End of Cul-de-Sac
- Overlooking Park
- Well Presented Throughout
- Walk to Station

Occupying an enviable location overlooking the park, this modern townhouse provides four double bedrooms, two bathrooms, kitchen, guest WC and living room presented in excellent order throughout. The front door opens into the entrance hallway that has under stairs storage and the guest cloakroom. To the front is a modern fitted kitchen with plenty of storage units above and below the worktop. There is an integral oven with gas hob and the boiler, which provides gas central heating to radiators is also fitted in the kitchen. To the rear of the ground floor is a large living room which has

window and back door that gives access to the rear garden. The first floor has one bedroom to the front, and a second bedroom that has windows to rear and benefits from having an ensuite shower room. The second floor has two further double bedrooms and the family bathroom.

The rear garden is landscaped with fencing to borders and there is allocated parking for one car, with visitor bays available in the development.



The Roperies was built just over fifteen years ago and is a modern development in Totteridge, which is a suburb to the east of High Wycombe's town centre. The location is convenient for Highcrest Academy secondary school which is within a short walk, as well as local stores and a supermarket. For road commuters, both Junctions 3 & 4 of the M40 are less than three miles away providing good access to Oxford to the west, and London, Heathrow Airport, and the M25 to the east. For rail commuters, taking a short-cut walk across the park can have you at the eastbound platform which has fast trains into London Marylebone

on the well regarded Chiltern Railways in under half an hour. Many people relocate to High Wycombe for the highly regarded schooling, with a number of primary and secondary schools, along with the three Grammar Schools. The town itself has every convenience and facilities you could wish for, with the Eden Centre at the heart of it, which has a host of retail, leisure and hospitality venues.

EPC Rating - C(77)



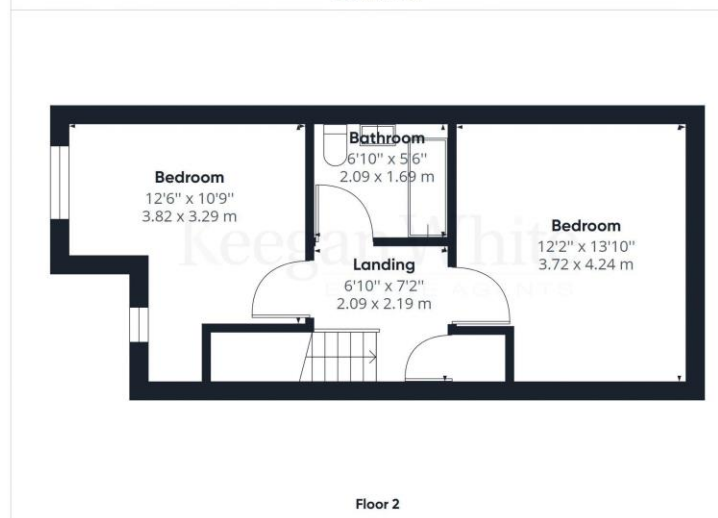

These particulars are not an offer or contract, nor part of one. You should not rely on statements by Keegan White Ltd. in the particulars or by word of mouth or in writing as being factually accurate about the property, its condition or its value. Keegan White Ltd. has no authority to make any representations about the property, and accordingly any information given is entirely without responsibility on the part of the agents, seller(s) or lessor(s). The photographs show only certain parts of the property as they appeared at the time they were taken. Areas, measurements and distances given are approximate only. Any reference to alterations to, or use of, any part of the property does not mean that any necessary planning, building regulations or other consent has been obtained. A buyer or lessee must find out by inspection or in other ways that these matters have been properly dealt with and that all information is correct. Keegan White Ltd. is a limited company registered in England & Wales with company number 9726292. Our registered office is 102-104 High Street, Great Missenden, Bucks, HP16 0BE

33 Crendon Street, High Wycombe, Buckinghamshire HP13 6LJ  
 Tel: 01494 417007  
 Email: wyc@keeganwhite.co.uk  
 keeganwhite.co.uk

**Keegan White**  
 ESTATE AGENTS