

Red Kite
Community Housing



Keegan White
ESTATE AGENTS

Plot 8, 27 Crispin Gardens | £150,000

Plot 8, 27 Crispin Gardens | Lower Shiplake | RG9 4FN

- Shared Ownership
- Three Bedroom House
- 10 Year Build Warranty
- Air Source Heat Pump
- Appliances Included
- Higher Share Ownership Available

The house is due for build completion in Autumn '25 and will be prepared for immediate occupancy. The front door opens into the hallway that gives access to the ground floor accommodation and has the staircase to the first floor. The kitchen has a range of storage units above and below the kitchen worktop, with stainless steel sink & drainer, electric oven, ceramic hob, extractor fan, washer/dryer, dishwasher and integral fridge/freezer. There is a downstairs guest cloakroom, and the living room is of a good size and has patio doors to the garden. The first floor has two double bedrooms and the family bathroom suite that comprises of a panel bath with overhead shower, hand basin, WC, heated towel rail and extractor fan. Externally, there is allocated parking for two vehicles, and side access to the back garden. The property's heating has a low carbon impact with air source heat pump to radiators.

Lower Shiplake is situated a short distance from the River Thames and offers a good range of sporting and leisure clubs. The village has a Post Office, convenience store, a well-regarded butcher, and a few local pubs. There is a Church of England School and a highly regarded private school in the village, with further options in the neighbouring towns of Henley-on-Thames and Twyford.

Shared ownership options:

25% share purchase price £150,000 - 2.5% rent on the unowned share = £938 pcm

50% share purchase price £300,000 - 2.5% rent on the unowned share = £625 pcm

75% share purchase price £450,000 - 2.5% rent on the unowned share = £313 pcm

There are onsite service charges for the roads, drainage, communal gardens and insurance, which is currently £653.16 pa, or £54.43 pcm, these figures are to be verified by a solicitors.

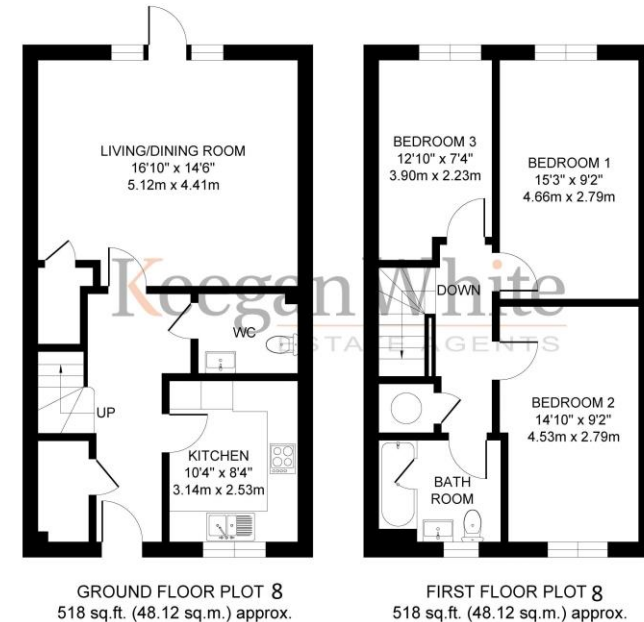
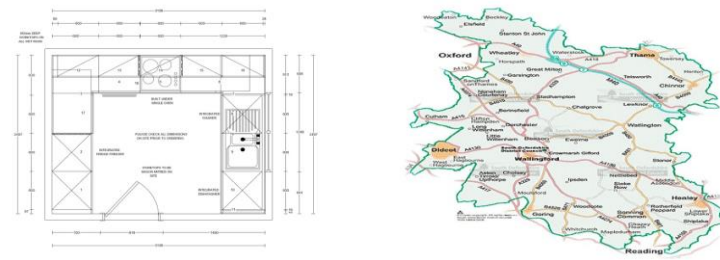

TOTAL FLOOR AREA : 1036 sq.ft. (96.24 sq.m.) approx
Whilst every attempt has been made to ensure the accuracy of the floor plans contained here, measurements of doors, windows rooms and any other items are approximate and no responsibility is taken for any error, omission or mis-statement. This plan is for illustrative purposes only and should be used as such by any prospective purchaser. The services, systems and appliances shown have not been tested and no guarantee as to their operability or efficiency can be given.
Made with Metropix ©2023

These particulars are not an offer or contract, nor part of one. You should not rely on statements by Keegan White Ltd. in the particulars or by word of mouth or in writing as being factually accurate about the property, its condition or its value. Keegan White Ltd. has no authority to make any representations about the property, and accordingly any information given is entirely without responsibility on the part of the agents, seller(s) or lessor(s). The photographs show only certain parts of the property as they appeared at the time they were taken. Areas, measurements and distances given are approximate only. Any reference to alterations to, or use of, any part of the property does not mean that any necessary planning, building regulations or other consent has been obtained. A buyer or lessee must find out by inspection or in other ways that these matters have been properly dealt with and that all information is correct. Keegan White Ltd. is a limited company registered in England & Wales with company number 9726292. Our registered office is 102-104 High Street, Great Missenden, Bucks, HP16 0BE

33-35 Crendon Street, High Wycombe, Buckinghamshire HP13 6LJ

Tel: 01494 417007

Email: wyc@keeganwhite.co.uk

keeganwhite.co.uk

Keegan White
ESTATE AGENTS