



**Red Kite**  
Community Housing



**Keegan White**  
ESTATE AGENTS

Plot 14, 20 Elsfield House | Lower Shiplake | £110,000



## Plot 14, 20 Elsfield House | Lower Shiplake | RG9 4FN

- Shared Ownership Options
- First Floor With Balcony
- Private Entrance
- Two Bedrooms
- Allocated Car Parking
- 10 Year Building Warranty

This first floor maisonette is due for build completion in July and will be prepared for immediate occupancy. The private front door opens to the entrance lobby with stairs rising to the first floor with the secondary front door giving access to the apartment. The property is very suitable for modern living with an open plan kitchen living room that also has twin doors that open onto a balcony. The kitchen area has a range of storage units above and below the kitchen worktop, with stainless steel sink & drainer, electric oven, ceramic hob, extractor fan, washer/dryer, and integral fridge/freezer. The two bedrooms are both doubles and the family bathroom suite is complete with a panel bath with overhead shower, hand basin, WC, heated towel rail and extractor fan. Externally, there is allocated parking for one car, and communal gardens. The property's heating has a low carbon impact with air source heat pump to radiators.

Lower Shiplake is situated a short distance from the River Thames and offers a good range of sporting and leisure clubs. The village has a Post Office, convenience store, a well-regarded butcher, and a few local pubs. There is a Church of England School and a highly regarded private school in the village, with further options in the neighbouring towns of Henley-on-Thames and Twyford.

Please note that in accordance with the planning requirements, any purchaser must be approved by the local authority and that they must have a local connection to South Oxfordshire.

Shared ownership options:

25% share purchase price £110,000 - 2.5% rent on the unowned share = £688 pcm

50% share purchase price £220,000 - 2.5% rent on the unowned share = £458 pcm

75% share purchase price £330,000 - 2.5% rent on the unowned share = £229 pcm

There are onsite service charges for the roads, drainage, communal gardens and insurance, which is currently £653.16 pa, or £54.43 pcm. To be verified by solicitor

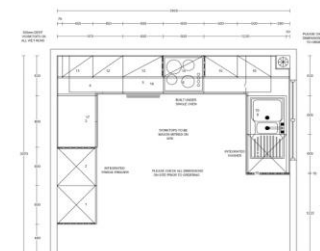

These particulars are not an offer or contract, nor part of one. You should not rely on statements by Keegan White Ltd. in the particulars or by word of mouth or in writing as being factually accurate about the property, its condition or its value. Keegan White Ltd. has no authority to make any representations about the property, and accordingly any information given is entirely without responsibility on the part of the agents, seller(s) or lessor(s). The photographs show only certain parts of the property as they appeared at the time they were taken. Areas, measurements and distances given are approximate only. Any reference to alterations to, or use of, any part of the property does not mean that any necessary planning, building regulations or other consent has been obtained. A buyer or lessee must find out by inspection or in other ways that these matters have been properly dealt with and that all information is correct. Keegan White Ltd. is a limited company registered in England & Wales with company number 9726292. Our registered office is 102-104 High Street, Great Missenden, Bucks, HP16 0BE

33-35 Crendon Street, High Wycombe, Buckinghamshire HP13 6LJ

Tel: 01494 417007

Email: [wyc@keeganwhite.co.uk](mailto:wyc@keeganwhite.co.uk)

[keeganwhite.co.uk](http://keeganwhite.co.uk)

**Keegan White**  
ESTATE AGENTS