



**Keegan White**  
ESTATE AGENTS

7 Lane End Road | £475,000





## Features

- Self Contained Annexe
- Open Plan Living / Kitchen Area
- Ensuite Bathroom
- Driveway Parking for several cars
- Good sized Rear Garden
- Loft Room

A semi detached family home benefitting from a one bedroom annexe with its own access providing a kitchen, shower room, bedroom/living area and secluded decking area.

The main home provides an entrance hall leading to an open plan kitchen with integrated appliances and a large island ideal for dining and entertaining, patio doors leading to a good sized rear garden and there is also access to the annexe. The sitting area has an attractive bay window and a wood burning stove.

To the first floor are three bedrooms, a shower room and ensuite bathroom to the master bedroom with a loft room accessed via a staircase from the landing.

Externally to the front is a driveway with parking for 3 cars and a separate front door to the annexe. To the rear is a large garden, incorporating a sandstone patio and decked area with feature fruit tree and a garden shed. The rear of the property can also be accessed from New Road and there is a potential to make this area into additional parking, or increase the size of the garden.





Sands is a suburb to the west side of High Wycombe and provides easy vehicular access to Junction 4 of the M40. There are schools and local shops in the vicinity with access to wonderful Chiltern countryside walks just a few hundred metres away. High Wycombe itself is a busy market town, with Eden Shopping at its centre, a large array of schools, the extensive Wycombe Sports and Leisure Centre, Swan Theatre and the mainline railway station which offers a regular and reliable service and links London Marylebone in approximately 25 minutes. High Wycombe's location is ideal for commuters by road, being in close

proximity to Junctions 3 & 4 of the M40 motorway which links the M25 Motorway in about 7 miles.

Property Details: EPC rating TBC, Council tax band D (These should be verified by a solicitor).

Overall Approximate Floor Area: 1356 ft<sup>2</sup> / 126 m<sup>2</sup>



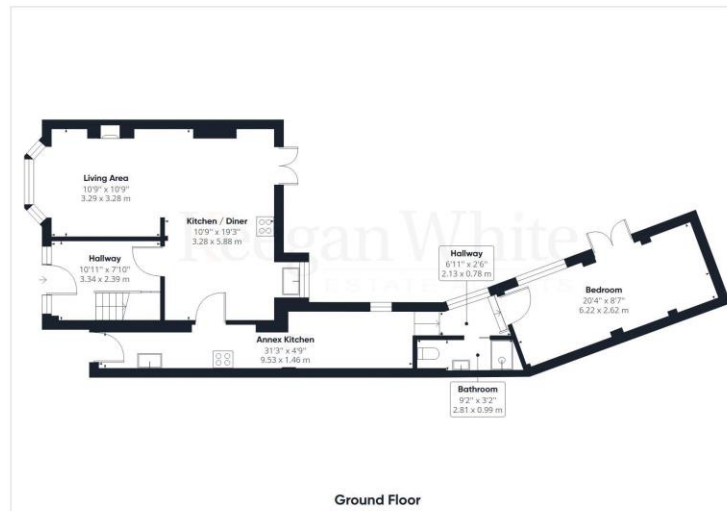

These particulars are not an offer or contract, nor part of one. You should not rely on statements by Keegan White Ltd. in the particulars or by word of mouth or in writing as being factually accurate about the property, its condition or its value. Keegan White Ltd. has no authority to make any representations about the property, and accordingly any information given is entirely without responsibility on the part of the agents, seller(s) or lessor(s). The photographs show only certain parts of the property as they appeared at the time they were taken. Areas, measurements and distances given are approximate only. Any reference to alterations to, or use of, any part of the property does not mean that any necessary planning, building regulations or other consent has been obtained. A buyer or lessee must find out by inspection or in other ways that these matters have been properly dealt with and that all information is correct. Keegan White Ltd. is a limited company registered in England & Wales with company number 9726292. Our registered office is 102-104 High Street, Great Missenden, Bucks, HP16 0BE

33 Crendon Street, High Wycombe, Buckinghamshire HP13 6LJ

Tel: 01494 417007

Email: [wyc@keeganwhite.co.uk](mailto:wyc@keeganwhite.co.uk)

[keeganwhite.co.uk](http://keeganwhite.co.uk)

**Keegan White**  
ESTATE AGENTS