

Location

Location Map

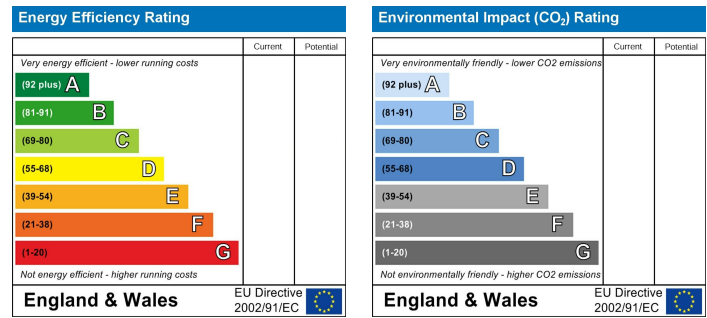

EPC Graph



Important Note

Centro Residential Sales and Lettings limited have not tested any services, heating system, electrical system, appliances, fixtures and fittings, that may be included in this property and would advise interested parties to satisfy themselves as to their condition or investigating the presence of any deleterious materials.

Viewing: Strictly by appointment through:

CENTRO RESIDENTIAL SALES AND LETTINGS LIMITED

Tel: 020 8401 5000

E-mail: residential@centro.plc.uk

See a selection of our properties at www.centro.plc.uk

£2,500 Per Month - 11th July 2025

Barrington Road, Sutton, SM3 9PR



Description

- NEW FITTED KITCHEN BEING ADDED
- NEW SHOWER ROOM
- NEWLY DECORATED
- SEMI DETACHED
- THREE BEDROOMS
- EPC RATING : D
- COUNCIL TAX BAND : D

Features

- Double glazing
- Gas central heating
- Rear Garden

What you need to know

- Term: 12 Months
- Rent: £2500pcm exclusive of bills
- Security deposit: £2884.00
- Council tax: D
- Energy rating: D



Floor Plan

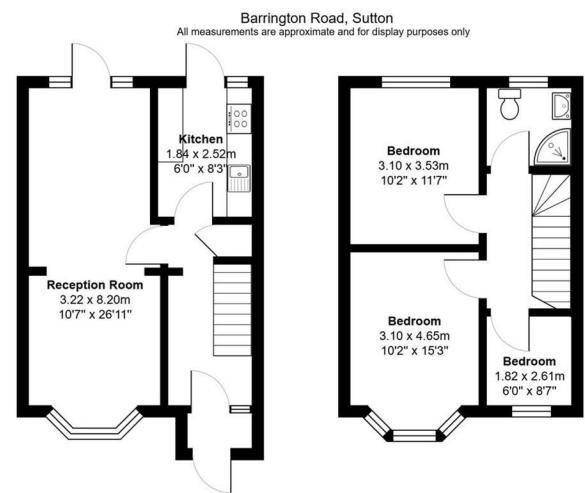

For illustration purposes only



All dimensions and measurements are approximate and for guidance only.

Just Centro's Opinion...

Located on Barrington Road in Sutton, this newly decorated three bedroom semi-detached house offers a perfect blend of comfort and modern living. The house comprises a large through lounge, brand new fitted kitchen, large rear garden, three bedrooms and a brand new shower room.

Located in a desirable area, this home is walking distance to local stations, supermarkets and local schools such as Glenthorne High School and Westbourne Primary School.

Offered unfurnished and available to view now.

Additional Photos

