



Orchard Lodge The Pippin  
£372,950

**Rutfield  
Breach**



## Floor Plan

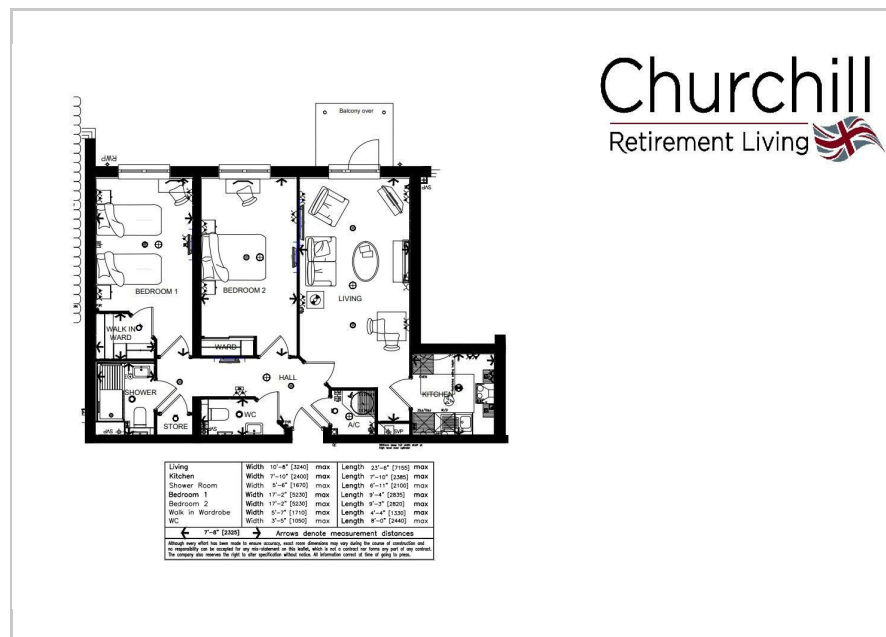

## Area Map

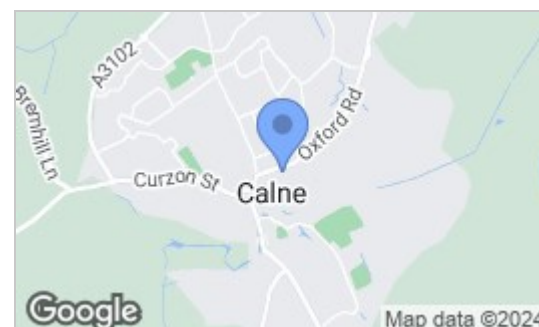

## Energy Efficiency Graph

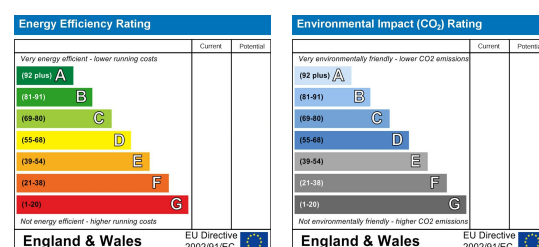

## Viewing

Please contact our Calne Office on 01249 821110 if you wish to arrange a viewing appointment for this property or require further information.

- TWO DOUBLE BEDROOMS
- COVERED PATIO
- OWNERS LOUNGE
- FITTED KITCHEN
- GUEST CLOAKROOM
- LARGE LIVING ROOM
- SHOWER ROOM
- PARKING
- COMMUNAL GARDENS
- NEW HOME

This brand new retirement development, located in our historic market town, has been thoughtfully designed, making life easier and safer, allowing homeowners to enjoy their retirement. Apartment two is a spacious, two double-bedroom apartment, which is placed on the Owners Lounge floor- ideal for interacting with other residents. There is a living room, shower room, guest cloakroom fitted kitchen and a covered patio. Orchard Lodge features just 39 one and two-bedroom apartments. Many of the apartments have balconies or patios overlooking landscaped gardens. Homeowners will also have full use of the south-facing Owners' Lounge, a beautifully designed space with access to a patio. The development is placed right on the doorstep of amenities and bus links. Special incentives available!



These particulars, whilst believed to be accurate are set out as a general outline only for guidance and do not constitute any part of an offer or contract. Intending purchasers should not rely on them as statements of representation of fact, but must satisfy themselves by inspection or otherwise as to their accuracy. No person in this firm's employment has the authority to make or give any representation or warranty in respect of the property.