





CASTLETON HAMLETT

Castleton

CONTACT US

-  The Place, Mill Lane, Alderley Edge, Cheshire SK9 7TY
-  moving@maison.haus
-  01625 919 079

Castleton Hamlett

- Open Canal Views
- Sought After Location
- Detached Family Home
- Driveway & Garage
- Enclosed Private Garden
- Modern Interior



Castleton

Beautifully presented deceptively spacious four bedroom detached home, situated in a sought after residential backwater location overlooking the Rochdale canal. The property was built only 6 years ago to a high specification.



Offering superb family accommodation and new carpets throughout, the property briefly comprising of: Entrance porch, lounge, fully fitted dining kitchen with French doors leading to the rear garden, utility and w.c.

To the first floor there are four good sized double bedrooms of which the master benefits from en-suite facilities and a Juliet balcony with stunning views of the canal and fields beyond, whilst the remaining three bedrooms are serviced by a large three-piece family bathroom suite. Externally, there is off road parking on the driveway and a single integral garage. To the rear is a private enclosed garden with patio area and lawn. Castleton Hamlett is conveniently located on the doorstep of key motorway networks making commutes to Manchester City Centre, Leeds and Liverpool easily accessible. The main bus routes to Rochdale and Manchester are every ten minutes and the property is only a five minute walk to Castleton Train Station.

A private showing is advised to appreciate what is on offer.



Ground Floor



First Floor

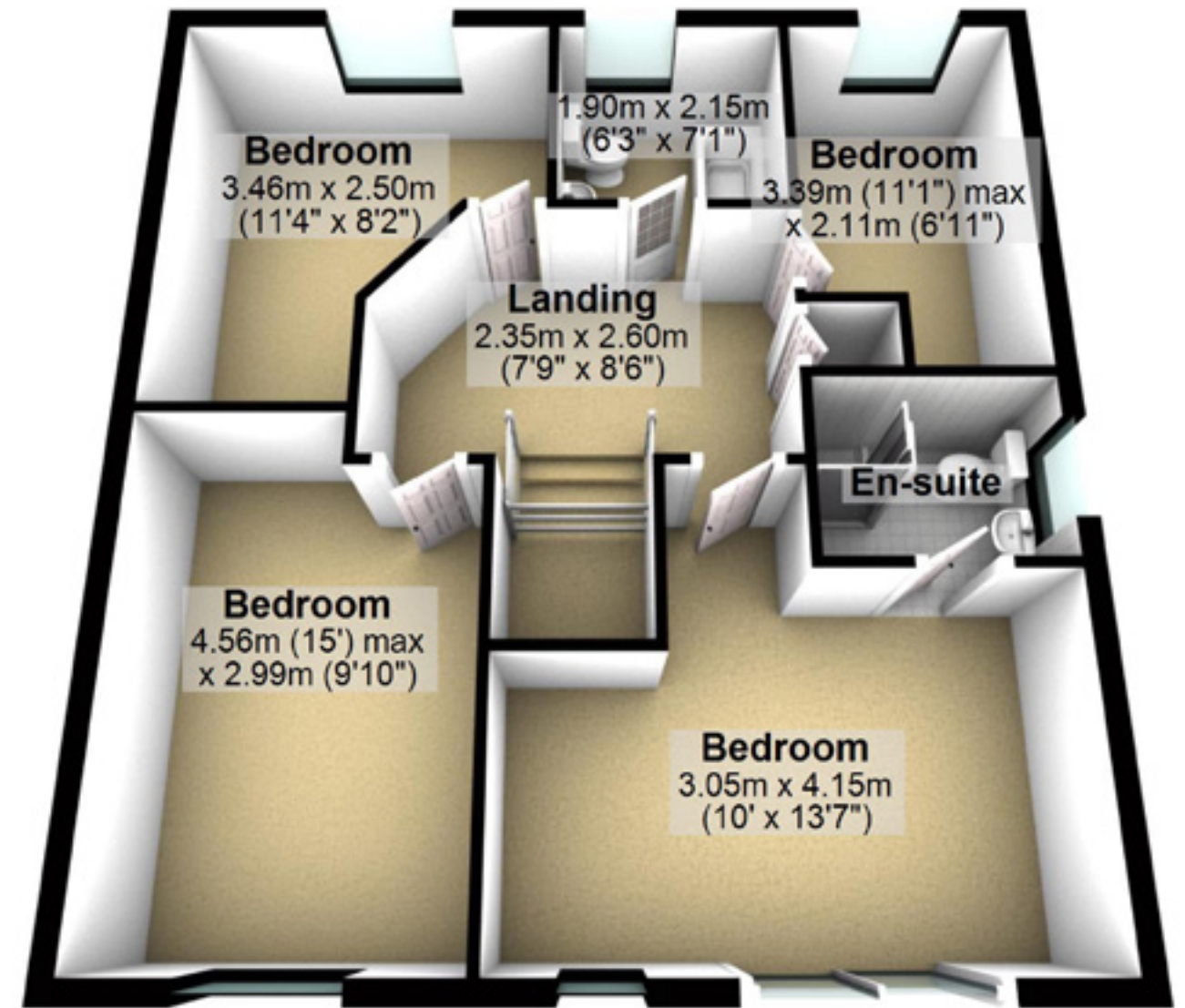

MAISON HAUS
SALES

Maison Haus Guarantees to work harder to achieve the best price for you, we have pre-qualified buyers waiting.

www.maison.haus

Please accept this free invitation to a no obligation valuation, curious what your property is worth?
Please call 01625 919 079

14 Castleton Hamlett

Castleton

OL11 2QH

Asking Price : £339,950

Tenure : Leasehold

Local Authority : Rochdale Council

EPC Rating : C

Important Notice :

Maison Haus Limited, their solicitors and any joint agents give notice that:

1. They are not authorised to make or give any representations or warranties in relation to the property either here or elsewhere, either on their own behalf or on behalf of their client or otherwise. They assume no responsibility for any statement that may be made in these particulars. These particulars do not form part of any offer or contract and must not be relied upon as statements or representation of fact.

2. Any areas, measurements or distances are approximate. The text, photographs and plans are for guidance only and are not necessarily comprehensive. It should not be assumed that the property has all necessary planning, building regulations or other consents and Maison Haus Limited have not tested any services, equipment or facilities. Purchasers must satisfy themselves by inspection or otherwise.

