



Woodford Road | Stockport





## Woodford Road | Stockport



- New Build
- 6 Bedrooms or 5 with Home Office
- High Specification
- Open Plan Living with Separate Family Room
- South Facing Garden
- Bramhall Village Location



Maison Haus are delighted to bring one of two new build properties to the market finished to an impeccable standard throughout, conveniently located within walking distance to Bramhall Village. Occupying a large mature south facing garden garden plot whilst enjoying pleasant view of Woodford Recreational Ground. The accommodation briefly comprises of open entrance hall, wc, utility room leading to the integral garage, family room/sitting room, large open plan living space with garden views and large form aluminium patio doors warmed by under floor heating and a log burning fire, fully fitted dining kitchen with Quartz work surfaces and a good range of Neff appliances, the oak and glass staircase leads to the six bedrooms on the upper two floors with the Master bedroom having fitted wardrobes and a four piece en-suite shower room with the five other bedrooms having the use of the two other four piece bathroom suites. All the bathrooms are Vitra sanitary ware the windows and doors are powder coated aluminium. The off road parking is ample with a block paved driveway for four cars and further space within the integral garage. Part exchange is considered and the property is offered with no chain. For a private showing please contact 01565 748748.





The oak and glass staircase leads to the six bedrooms on the upper two floors with the Master bedroom having fitted wardrobes and a four piece en-suite shower room with the five other bedrooms having the use of the two other four piece bathroom suites. All the bathrooms are Vitra sanitary ware the windows and doors are powder coated aluminium.

Externally, the off-road parking is ample with a block paved driveway for four cars and further space within the integral garage. To the rear, the property boasts a large garden, secured with wooden fence paneling for privacy and a stone terrace. Part exchange is considered, and the property is offered with no chain.

For a private showing please contact 01565 748748.



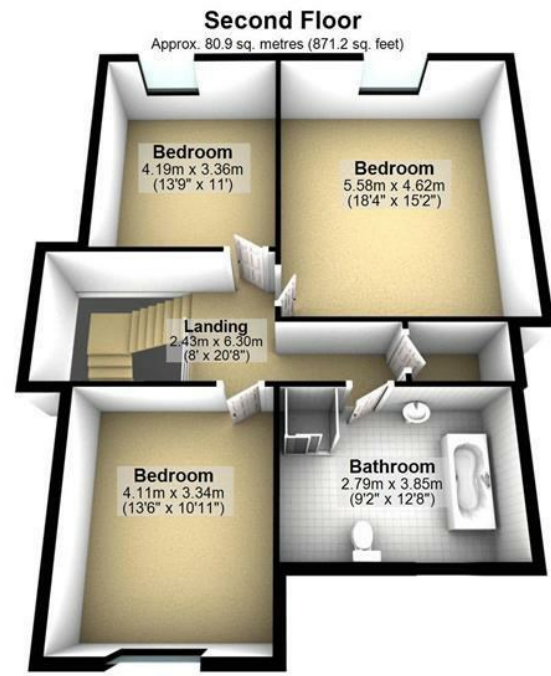

Total area: approx. 282.6 sq. metres (3042.2 sq. feet)

Woodford Road  
Stockport  
SK7 1PD

: £975,000  
Tenure: Freehold  
Local Authority: Stockport Council  
EPC Rating: B



IMPORTANT NOTICE: Maison Haus Limited, their solicitors and any joint agents give notice that: 1. They are not authorised to make or give any representations or warranties in relation to the property either here or elsewhere, either on their own behalf or on behalf of their client or otherwise. They assume no responsibility for any statement that may be made in these particulars. These particulars do not form part of any offer or contract and must not be relied upon as statements or representation of fact. 2. Any areas, measurements or distances are approximate. The text, photographs and plans are for guidance only and are not necessarily comprehensive. It should not be assumed that the property has all necessary planning, building regulations or other consents and Maison Haus Limited have not tested any services, equipment or facilities. Purchasers must satisfy themselves by inspection or otherwise.



Mill Lane, Alderley Edge, Cheshire SK9 7TY  
moving@maison.haus  
01625 919 079