



Ainsworth Road | Bury





Ainsworth Road | Bury



- New Build Home
- Open Plan Living
 - Four Double Bedrooms
- Highly Sought After Area
- Ample Off-Road Parking
- Close Proximity to Popular Schools



Maison Haus are excited to present Plot 1 Ainsworth Road. A well designed, modern new home in a highly desirable location. The accommodation in brief comprises of; Vaulted entrance hall, w.c, utility room with garage access, separate sitting and living room, to the rear is a modern, open plan living space comprising of a fully fitted dining kitchen with bifold doors and living room with garden views.

To the first floor are four double bedrooms, the master and second bedroom have use of en-suite facilities, with the remaining two bedrooms served by a large and impressive family bathroom suite. The two rear bedrooms also enjoy views of the garden through two Juliette balconies.

Externally, the property has ample parking for up to 3 cars including a space in the integral garage. The rear garden is well-landscaped and complete with a private mature border.

The property is conveniently positioned access to both Bury and Bolton Centre, with a range of local amenities and popular schools in close proximity, as well as being on the doorstep of the motorway network allowing easy commutes to Manchester, Liverpool and Leeds.

Further planning documents are available upon request with the option of a choice of bespoke designs. A site viewing is advised to fully appreciate the position and size of the plot.

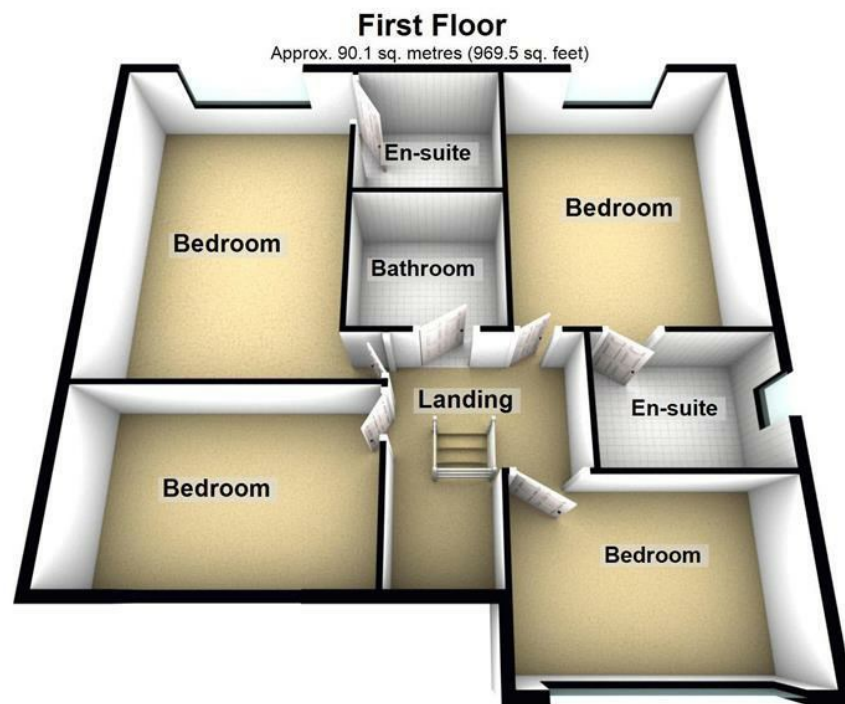
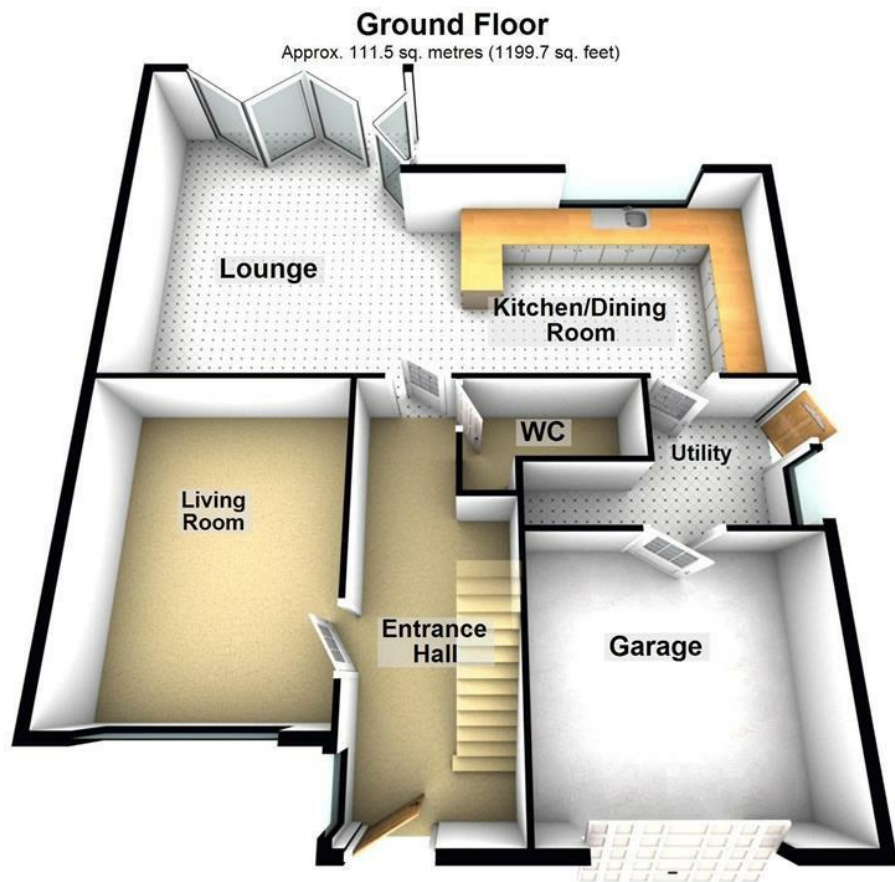

Total area: approx. 201.5 sq. metres (2169.3 sq. feet)

Ainsworth Road
Bury
BL8 2SB

: £595,000
Tenure: Freehold
Local Authority: Bury Council
EPC Rating:

IMPORTANT NOTICE: Maison Haus Limited, their solicitors and any joint agents give notice that: 1. They are not authorised to make or give any representations or warranties in relation to the property either here or elsewhere, either on their own behalf or on behalf of their client or otherwise. They assume no responsibility for any statement that may be made in these particulars. These particulars to not form part of any offer or contract and must not be relied upon as statements or representation of fact. 2. Any areas, measurements or distances are approximate. The text, photographs and plans are for guidance only and are not necessarily comprehensive. It should not be assumed that the property has all necessary planning, building regulations or other consents and Maison Haus Limited have not tested any services, equipment or facilities. Purchasers must satisfy themselves by inspection or otherwise.



Mill Lane, Alderley Edge, Cheshire SK9 7TY
moving@maison.haus

01625 919 079