



14 Wessex Close
Bridgwater, Somerset, TA6 4JY

Brightestmove

Brightest move

£160,000 (offers in excess of)



Brightestmove are delighted to present this spacious three-bedroom terraced home, located on the popular Sydenham Estate and offered to the market with no onward chain.

In need of modernisation throughout, this property offers fantastic potential and comprises a generous living room, kitchen, large utility area, family bathroom, and three well-proportioned bedrooms. Externally, the home benefits from an enclosed rear garden. This property is ideal for families or investment buyers.



Bridgwater is an emerging town situated in the heart of the borough of Sedgemoor and within 11 miles of Taunton and 38 miles of Bristol. The town which is famed for its annual carnival is a thriving place with many new jobs being created in recent years.

For more information or an appointment to view please contact the vendors sole agents.

SERVICES: Mains gas, electricity, water and drainage

HEATING: Gas fire in living room

TENURE: Freehold COUNCIL TAX BAND: A

GROUND FLOOR



1ST FLOOR

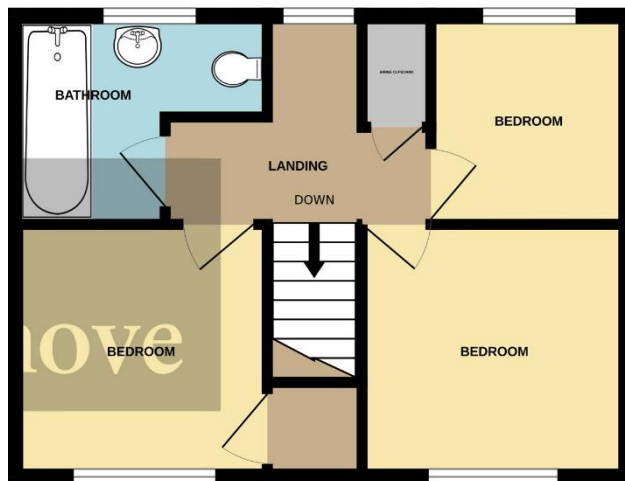

Living Room 18' 04" x 10' 04" (5.59m x 3.15m)

Kitchen 9' 07" x 9' 00" (2.92m x 2.74m)

Utility Room 8' 9" x 6' 11" (2.67m x 2.11m)

Bedroom One 12' 08" x 9' 07" (3.86m x 2.92m)

Bedroom Two 10' 08" x 9' 04" (3.25m x 2.84m)

Bedroom Three 8' 10" x 7' 08" (2.69m x 2.34m)

Score	Energy rating	Current	Potential
92+	A		
81-91	B		87 B
69-80	C		
55-68	D		
39-54	E		
21-38	F	27 F	
1-20	G		

No statement in these details is to be relied upon as representation of fact, and purchasers should satisfy themselves by inspection or otherwise as to the accuracy of the statements contained within. These details do not constitute any part of any offer or contract. CMH Southwest limited trading as Brightest Move and their employees and agents do not have any authority to give warranty or representation whatsoever in respect of this property. These details and all statements herein are provided without any responsibility on the part of CMH Southwest limited trading as Brightest Move or the vendors. CMH Southwest limited trading as Brightest Move has not tested the equipment or central heating system mentioned in these particulars and the purchasers are advised to satisfy themselves as to the working order and condition. Measurements: Great care is taken when measuring, but measurements should not be relied upon for ordering carpets, equipment, etc. This property sheet forms part of our database, and is protected by the database right and copyright laws. No unauthorised copying or distribution without permission.

28 High Street, Bridgwater, Somerset TA6 3BJ

Tel: 01278 420444

bridgwater@brightestmove.co.uk

www.brightestmove.co.uk

Brightest move