



4 Malvern Close  
Bridgwater, Somerset, TA6 4XJ

**Brightest**move



# Brightest move

£167,500



Brightestmove are pleased to welcome to the market this two bedroom terraced house on the Bower Manor estate. In need of modernisation, the property benefits from double glazed windows, off road parking and a good size garden with a shed.

The property briefly comprises of a porch upon entry, living room with a gas convection heater, kitchen with ample storage, a wood conservatory and garden. On the first floor, you are welcomed to two good sized bedrooms and family bathroom. There is off road parking to the rear of the property.





Bridgwater is an emerging town situated in the heart of the borough of Sedgemoor and within 11 miles of Taunton and 38 miles of Bristol. The town which is famed for its annual carnival is a thriving place with many new jobs being created in recent years.

For more information or an appointment to view please contact the vendors sole agents.

TENURE: Freehold

HEATING: Gas convection heater in living room

EPC: E

SERVICES: Mains electricity, water and drainage

TAX BAND: A

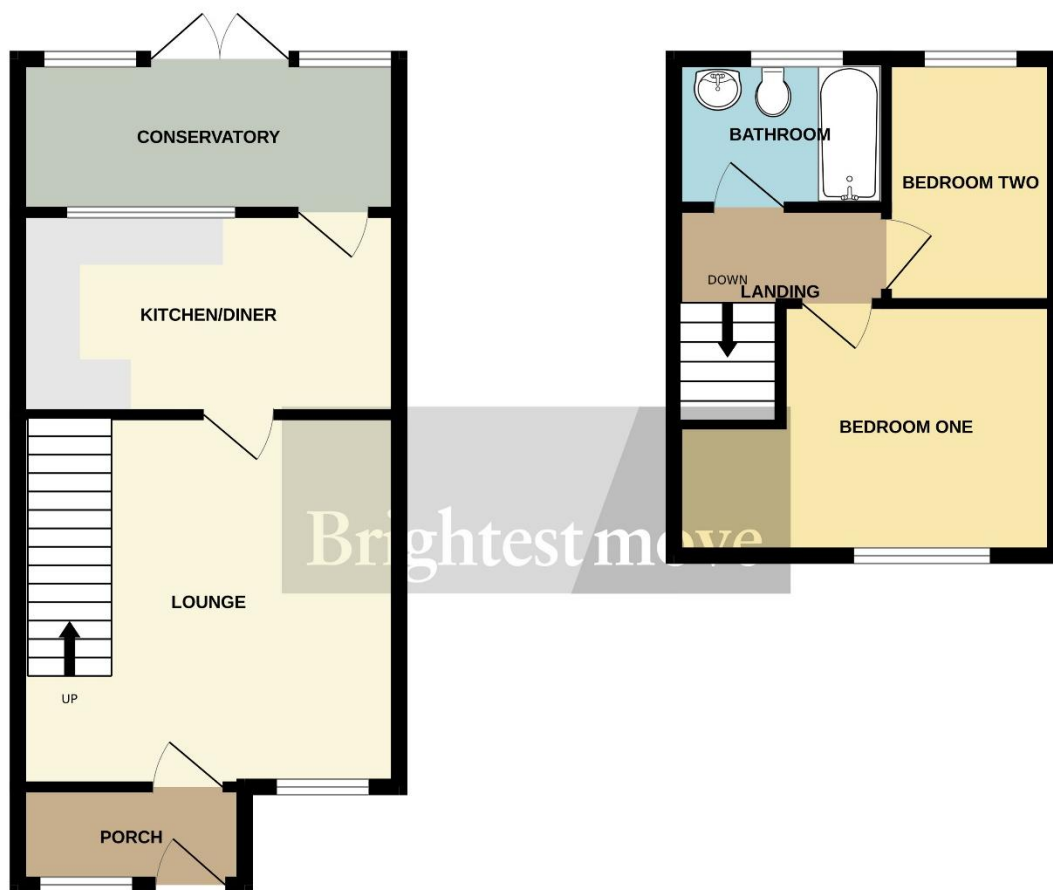

- Kitchen** 13' 03" x 7' 03" (4.04m x 2.21m)
- Bedroom One** 11' 00" x 10' 09" (3.35m x 3.28m)
- Bedroom Two** 8' 09" x 6' 0" (2.67m x 1.83m)
- Living Room** 13' 08" x 13' 04" (4.17m x 4.06m)
- Conservatory** 12' 08" x 5' 06" (3.86m x 1.68m)
- Approximate Total Floor Area** 106 Square Metres

Score	Energy rating	Current	Potential
92+	A		
81-91	B		82 B
69-80	C		
55-68	D		
39-54	E	42 E	
21-38	F		
1-20	G		

No statement in these details is to be relied upon as representation of fact, and purchasers should satisfy themselves by inspection or otherwise as to the accuracy of the statements contained within. These details do not constitute any part of any offer or contract. CMH Southwest limited trading as Brightest Move and their employees and agents do not have any authority to give warranty or representation whatsoever in respect of this property. These details and all statements herein are provided without any responsibility on the part of CMH Southwest limited trading as Brightest Move or the vendors. CMH Southwest limited trading as Brightest Move has not tested the equipment or central heating system mentioned in these particulars and the purchasers are advised to satisfy themselves as to the working order and condition. Measurements: Great care is taken when measuring, but measurements should not be relied upon for ordering carpets, equipment, etc. This property sheet forms part of our database, and is protected by the database right and copyright laws. No unauthorised copying or distribution without permission.