



Little Manor Barn
Fiddington, Somerset, TA5 1JQ

Brightest move

Brightest move

Starting Bid £230,000



Sold via Secure Sale online bidding. Terms & Conditions apply. Brightestmove are delighted to offer for sale this semi-detached barn conversion which is situated in this popular village close to the Quantock Hills and the North Somerset coast.

This spacious two bedroom home is accessed from a private drive on the outskirts of the village.

The accommodation is arranged on two floors with the spacious lounge/diner and kitchen on the first floor with both bedrooms (ensuite bathroom) and shower room on the lower floor.

The present vendors have installed a cast iron multi-fuel burner to supplement the oil fired central heating system and have also re fitted the kitchen which includes built in double oven with microwave, hob, fridge freezer, washing machine, tumble dryer and dishwasher.

The property measures 120 square metres overall and benefits from multiple parking on own drive to the side as well as a courtyard garden to the front.

This appealing character home is being sold with the added advantage of no onward chain.



The village of Nether Stowey (approximately four miles away) benefits from a number of amenities including a primary school, church, public houses, medical centre and a range of shops and cafés with Steart Marsh close by and a wider range of shops and amenities found in the town of Bridgwater.

Bridgwater is an emerging town situated in the heart of the borough of Sedgemoor and within 11 miles of Taunton and 38 miles of Bristol. The town which is famed for its annual carnival is a thriving place with many new jobs being created in recent years.

For more information or an appointment to view please contact the vendors sole agents.

SERVICES: Mains electricity, water and drainage. HEATING: Oil fired central heating system and under floor heating in kitchen.

TENURE: Freehold COUNCIL TAX BAND: D

GROUND FLOOR

1ST FLOOR

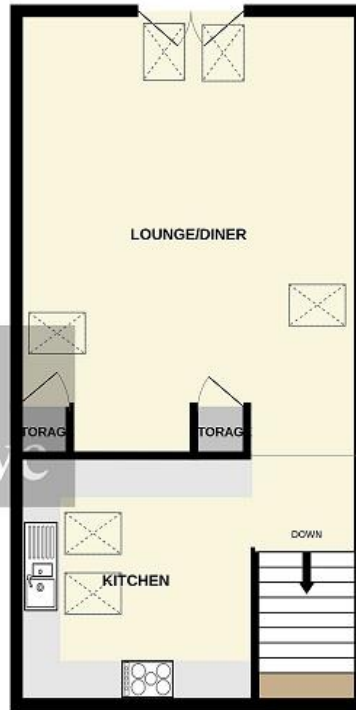

Lounge/Diner 20' 08" x 16' 02" (6.3m x 4.93m)

Kitchen 11' 07" x 11' (3.53m x 3.35m)

Bedroom One 13' 02" x 10' (4.01m x 3.05m)

Bedroom Two 13' 07" x 10' 08" (4.14m x 3.25m)

Sun Room 9' 08" x 7' 09" (2.95m x 2.36m)

Approximate Total Floor Area 120 Square Metres

Score	Energy rating	Current	Potential
92+	A		
81-91	B		83 B
69-80	C		
55-68	D		
39-54	E		
21-38	F	31 F	
1-20	G		

No statement in these details is to be relied upon as representation of fact, and purchasers should satisfy themselves by inspection or otherwise as to the accuracy of the statements contained within. These details do not constitute any part of any offer or contract. CMH Southwest limited trading as Brightest Move and their employees and agents do not have any authority to give warranty or representation whatsoever in respect of this property. These details and all statements herein are provided without any responsibility on the part of CMH Southwest limited trading as Brightest Move or the vendors. CMH Southwest limited trading as Brightest Move has not tested the equipment or central heating system mentioned in these particulars and the purchasers are advised to satisfy themselves as to the working order and condition. Measurements: Great care is taken when measuring, but measurements should not be relied upon for ordering carpets, equipment, etc. This property sheet forms part of our database, and is protected by the database right and copyright laws. No unauthorised copying or distribution without permission.