



16H Kingsleigh Road, Heaton Mersey, Stockport, SK4 3QG

JohnMellor



Must be viewed! A well appointed one bedroom modern flat securely situated on the second floor at the rear of the development with far reaching views. The flat is tastefully decorated throughout, and bright and airy rooms include a hall with storage off, a lounge, a modern kitchen, a double bedroom and a bathroom with a white suite. There are electric heaters, the windows are double glazed, and admittance is via a security entryphone system.



The communal gardens are neatly tended and the sale of this flat also includes one of the garages to the side. Kingsleigh Road is convenient for local amenities catering for most of the everyday wants and needs. The flat is leasehold for the remainder of a 999 year term from June 1976 and the service charge is £132.73 per calendar month (includes garage). Council tax band A. No chain involved!



Energy Efficiency Rating		
	Current	Potential
Very energy efficient – lower running costs		
(92 plus) A		
(81-91) B		
(69-80) C		78
(55-68) D	62	
(39-54) E		
(21-38) F		
(1-20) G		
Not energy efficient – higher running costs		
England & Wales	EU Directive 2002/91/EC	

Approx Gross Internal Area
35 sq m / 376 sq ft

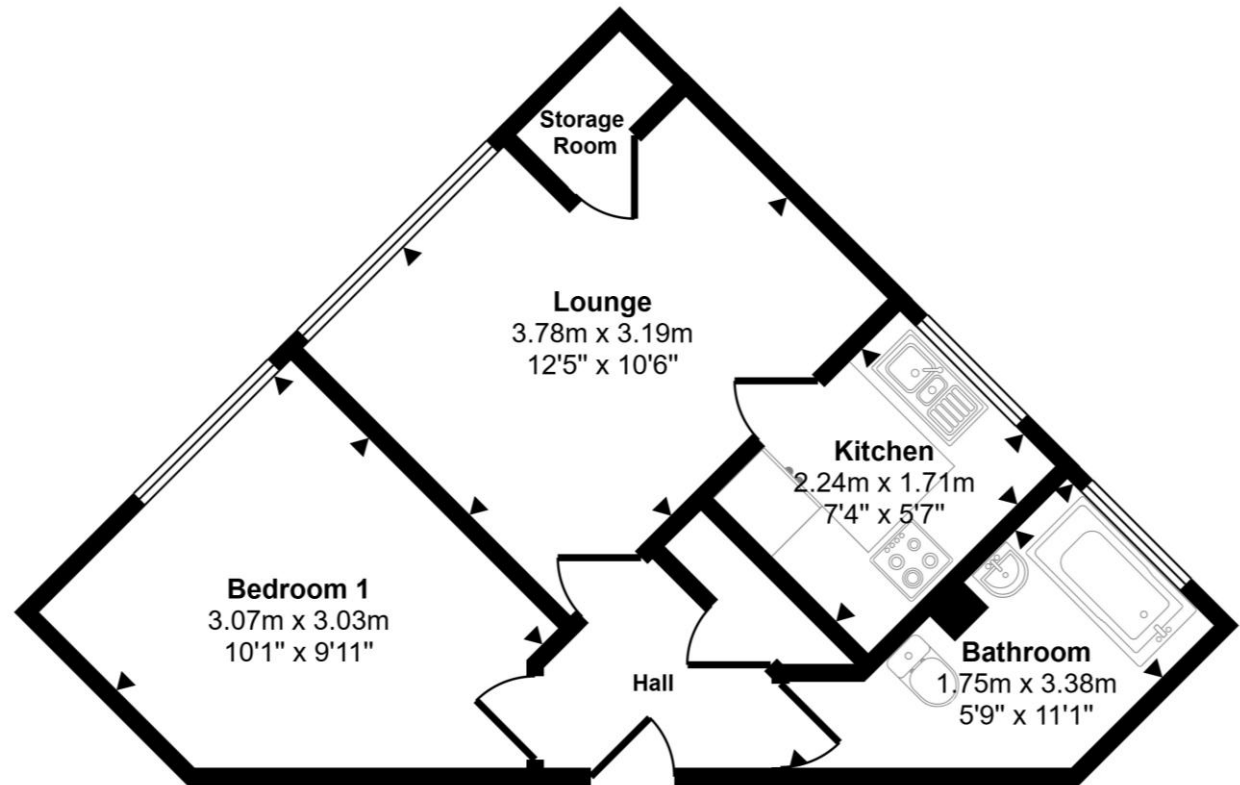

Second Floor

This floorplan is only for illustrative purposes and is not to scale. Measurements of rooms, doors, windows, and any items are approximate and no responsibility is taken for any error, omission or mis-statement. Icons of items such as bathroom suites are representations only and may not look like the real items. Made with Made Snappy 360.

JohnMellor

182 Heaton Moor Road, Heaton Moor,
Stockport, Cheshire, SK4 4DU
Tel: 0161 442 4142
sales@john-mellor.co.uk
www.john-mellor.co.uk

IMPORTANT! These particulars and floor plans are set out as a general outline only for the guidance of intending purchasers or lessees and do not constitute part of an offer or contract, nor may they be regarded as representations. All interested parties must themselves verify their accuracy. All measurements are approximate. The agents have not tested any apparatus, equipment, fixtures, fittings or services and so cannot verify that they are in working order, or fit for purpose. The buyer is advised to obtain verification from their solicitor or surveyor. J273