



To arrange a viewing
please call 01908 675747

This fantastic TWO DOUBLE BEDROOM property benefits from a EN SUITE SHOWER ROOM to the MASTER BEDROOM, an OFF ROAD ALLOCATED PARKING SPACE, a PRIVATE REAR GARDEN and it is also LOCATED WITHIN A FANTASTIC SCHOOL CATCHMENT....

In further detail this two bedroom end terraced briefly comprises of an entrance hall, a spacious living room and a good sized kitchen/diner. To the first floor there is two double bedrooms with an en-suite to master and a modern family bathroom.

The property benefits from a low maintenance rear garden and within a great school catchment.

This property is offered unfurnished and available start of May. EPC Rating: TBC

Minimum Contract Length: 6 months
Council Tax Band: B
Deposit equivalent to 5 weeks rent

- Two Double Bedrooms
- En Suite to Master Bedroom
- Allocated Parking

- Private Rear Garden
- Great School Catchment
- Available Start Of May

LOCATION: EMERSON VALLEY

Emerson Valley is a residential area situated in South West Milton Keynes. It takes its name from two farms called Emerson Farm and Valley Farm, which stood on the land before the new development. Emerson Valley encompasses paths and horse trails, streams, children's play areas, a viewing mound and a recently constructed rugby club with pitches. Schools within the area include Emerson Valley Combined School, with Lord Grey in Bletchley or Shenley Brook End School providing secondary education.

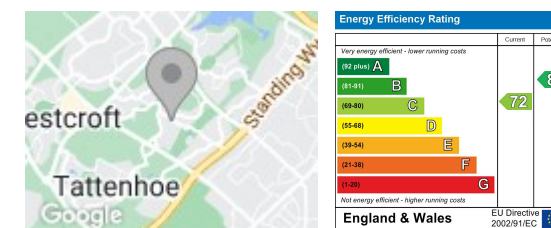
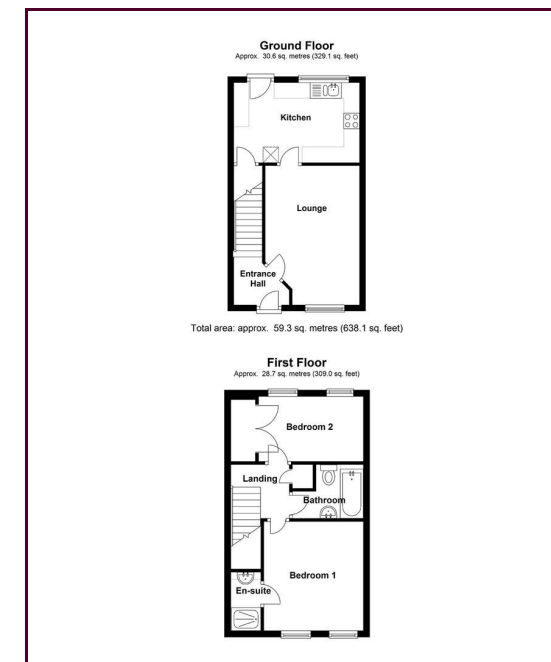

Draft Details

These details have been submitted to our clients but at the moment have not been approved by them. We therefore, cannot guarantee their accuracy and they are distributed on this basis. Please ensure you have a copy of our approved details before committing yourself to any expense.

Whilst we endeavour to make our sales details accurate and reliable, if there is any point which is of particular importance to you, please contact the office and we shall be pleased to check any information for you. Do so, especially if travelling any distance to view the property.

The mention of any appliances and/or services within these details does not imply they are in full and efficient working order.

Any plans included within these details are a GUIDE TO THE LAYOUT OF THE PROPERTY ONLY and are NOT DRAWN TO SCALE. Dimensions are approximate.

Mortgage Information

We can offer independent mortgage advice. Please call us to discuss your requirements. Your home may be repossessed if you do not keep up repayment on your mortgage or any loans secured on it.

Property Valuations

We have some of the most experienced property valuers in Milton Keynes and would welcome the opportunity to carry out a VALUATION and MARKET APPRAISAL of your home.

Viewing Arrangements

Please call us to make an appointment to view this property.

Monday to Friday 9.00 am - 6.00 pm
Saturday 9.00 am - 4.00 pm
Sunday CLOSED

