



To arrange a viewing  
please call 01908 675747



## BRAND NEW HOME.....

IMMACULATELY PRESENTED family home with EN-SUITE TO MASTER & BUILT IN WARDROBE, OPEN PLAN KITCHEN/DINER with SEPARATE UTILITY and SINGLE GARAGE.....

In further detail this brand new family home briefly comprises of a spacious entrance hall with built in storage, a downstairs cloakroom, and a large open plan kitchen/diner with integrated appliances and a separate utility room leading out to a private rear garden. To the first floor there is a large living room and the master bedroom benefitting from a built in wardrobe and a modern en-suite. To the second floor there is a further two double bedrooms, a good sized single and a family bathroom with a shower. This property is within close proximity to a great play park for children as well as great access to the M1.

Other benefits include driveway parking and a single garage.

This property is offered unfurnished & available mid July. EPC Rating: B

- Great Location

- New Build
- Modern Interior
- Spacious Living
- Built in Appliances
- En-suite to Master

## LOCATION: BROOKLANDS

Brooklands is one of the newer developments in MK, set in a fantastic location on the edge of the city. It offers the balance of lakes and peaceful open spaces, yet is close enough to the heart of Milton Keynes, to allow residents to enjoy the excellent transport and amenities the city has to offer. A new town square is to be built next to Brooklands, with shops, cafés and restaurants, and Brooklands Ridge offers green space with panoramic views & carefully designed landscaped pathways.

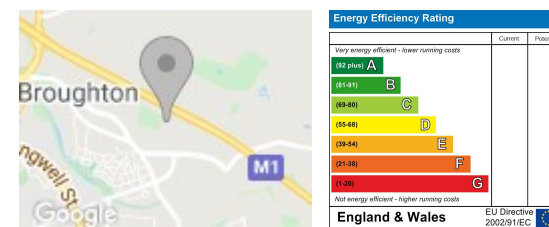
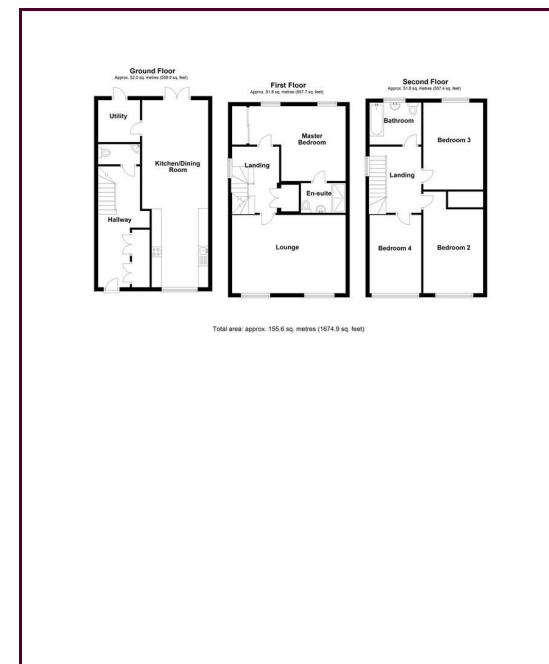

## Draft Details

These details have been submitted to our clients but at the moment have not been approved by them. We therefore, cannot guarantee their accuracy and they are distributed on this basis. Please ensure you have a copy of our approved details before committing yourself to any expense.

Whilst we endeavour to make our sales details accurate and reliable, if there is any point which is of particular importance to you, please contact the office and we shall be pleased to check any information for you. Do so, especially if travelling any distance to view the property.

The mention of any appliances and/or services within these details does not imply they are in full and efficient working order.

Any plans included within these details are a GUIDE TO THE LAYOUT OF THE PROPERTY ONLY and are NOT DRAWN TO SCALE. Dimensions are approximate.

## Mortgage Information

We can offer independent mortgage advice. Please call us to discuss your requirements. Your home may be repossessed if you do not keep up repayment on your mortgage or any loans secured on it.

## Property Valuations

We have some of the most experienced property valuers in Milton Keynes and would welcome the opportunity to carry out a VALUATION and MARKET APPRAISAL of your home.

## Viewing Arrangements

Please call us to make an appointment to view this property.

Monday to Friday 9.00 am - 6.00 pm  
 Saturday 9.00 am - 4.00 pm  
 Sunday CLOSED

