



**WOOD &
PILCHER**

Sales, Lettings, Land & New Homes



- Semi Detached Home
- Three Bedrooms
- Good Sized Rear Garden
- Re-Fitted Kitchen & Bathroom
- Driveway & Large Garage
- Energy Efficiency Rating: D

Beagles Wood Road, Pembury

GUIDE £475,000 - £495,000

woodandpilcher.co.uk

2 Beagles Wood Road, Pembury, Tunbridge Wells, TN2 4HX

Located in the sought after village of Pembury close to Royal Tunbridge Wells, this three bedroom semi detached home is situated at the beginning of a no through road on the outskirts of the village. The property itself is extremely well presented and has the benefit of off road parking, garage and well proportioned rooms with the living room having double glazed French doors opening to a large secluded rear garden. Internally the accommodation features a kitchen/dining room with contemporary styled units, complete with a selection of appliances. The living room as well as having French doors has been fitted with shelving and desk providing an ideal workspace. At first floor there are three bedrooms which have access to a bathroom fitted with a modern white suite. A particular feature of this property is the large private rear garden which is mainly lawned with attractive sleeper edged well stocked borders offering an ideal setting for outdoor relaxation or family activities. Homes in Pembury are always in strong demand, and we would encourage all interested parties to arrange an early viewing to fully appreciate everything that this home has to offer.

The accommodation comprises panelled entrance door with side window to:

ENTRANCE HALL:

Wood flooring, ceiling downlights, coat hanging space, double radiator, under stairs storage cupboard.

CLOAKROOM:

Fitted with a white low level WC, wash hand basin with mixer tap, tiled floor, dado rail, window to front.

KITCHEN/DINING ROOM:

Fitted with a range of wall and base units in high gloss white finish with wood effect worktops. Inset single drainer sink unit with mixer tap. Integrated dishwasher, space for a washing machine and space for fridge/freezer. Fitted electric oven and hob with filter hood above. Tiling adjacent to the work surfaces, tiled floor, radiator, coved ceiling with downlighting, 'Nest' central heating control. Window to front.

LIVING ROOM:

Wood flooring, built-in cupboards, shelving and desk. Double glazed French doors opening to the rear garden.

Stairs from entrance hall to FIRST FLOOR LANDING:

Power point, access to loft space being part boarded and fitted with light, cupboard housing a wall mounted 'Worcester' gas fired boiler and hot water tank.

BEDROOM 1:

Window to front with fitted blinds, single radiator, built-in double wardrobe, power points.



BEDROOM 2:

Window to rear with fitted blinds, single radiator, two double wardrobes, coved ceiling.

BEDROOM 3:

Window to rear, single radiator, power points.

BATHROOM:

White suite comprising of a shower bath with plumbed in shower over and tiled surrounds, wall mounted wash hand basin with mixer tap and cupboards beneath, low level WC. Wood effect flooring, towel rail/radiator, ceiling downlights, extractor fan. Window to front with fitted blinds.

OUTSIDE REAR:

A concrete patio area leads to an extensively lawned garden with sleeper edged, well stocked borders, outside tap and light. Combination of fencing and wall to boundary.

OUTSIDE FRONT:

A double width brick paved driveway with slate covered border leads to the property's entrance and garage. The garage has an up and over door, internal power and light, personal door giving access to rear garden.

SITUATION:

The property is located towards the outskirts of Pembury village. To this end it offers access not only to village facilities that include a number of stores for everyday purposes, a well regarded primary school and a number of public houses but also beautiful semi rural walks from the doorstep. Pembury is well located for access to the M25 as well as to Tunbridge Wells nearby with its fuller range of social, retail and educational facilities including a number of sports and social clubs, two theatres, a range of principally multiple retailers at the Royal Victoria Place and nearby North Farm and further independent offerings along Camden Road and between the Pantiles and Mount Pleasant. The area has a number of well regarded schools at all levels of which some are accessible from the property and two main line railway stations offering fast and frequent services to both London termini and the South Coast with other railway stations being found at nearby Paddock Wood and Tonbridge.

TENURE: Freehold

COUNCIL TAX BAND: D

VIEWING:

By appointment with Wood & Pilcher 01892 511211

ADDITIONAL INFORMATION:

Broadband Coverage search Ofcom checker

Mobile Phone Coverage search Ofcom checker

Flood Risk - Check flooding history of a property England - www.gov.uk

Services - Mains Water, Gas, Electricity & Drainage

Heating - Gas Fired Central Heating



Score	Energy rating	Current	Potential
92+	A		
81-91	B		86 B
69-80	C		
55-68	D	64 D	
39-54	E		
21-38	F		
1-20	G		



Ground Floor

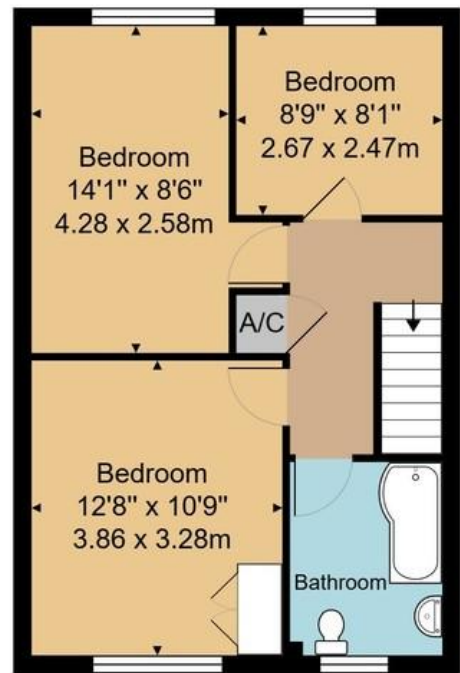

First Floor

House Approx. Gross Internal Area 941 sq. ft / 87.4 sq. m
 Approx. Gross Internal Area (Incl. Garage) 1174 sq. ft / 109.0 sq. m

Whilst every attempt has been made to ensure the accuracy of the floor plan contained here, measurements of doors, windows, rooms and any other items are approximate and no responsibility is taken for any error, omission, or mis-statement. This plan is for illustrative purposes only and should be used as such by any prospective purchaser or tenant. The services, systems and appliances shown have not been tested and no guarantee as to their operability or efficiency can be given.

Wood & Pilcher, their clients and any joint agents give notice that: They have no authority to make or give any representations or warranties in relation to the property. Any statements on which a purchaser or Tenant wishes to rely must be checked through their Solicitors or Conveyancers. These Particulars do not form part of any offer or contract and must be independently verified. The text, photographs and floor plans are for guidance only and are not necessarily comprehensive, please also note that not everything in the photographs may be included in the sale. It should not be assumed that the property has necessary planning, Building Regulations or other consents. We have not tested any appliances, services, facilities or equipment and Purchasers or Tenants must satisfy themselves as to their adequacy and condition. We have not investigated the Title, or their existence of any Covenants or other legal matters which may affect the property.

Heathfield 01435 862211
 Crowborough 01892 665666
 Southborough 01892 511311
 Tunbridge Wells 01892 511211
 Letting & Management 01892 528888
 Associate London Office 02070 791568

