



fosters
sales & lettings



2 Oak Road

Farnborough, GU14 7AQ

Asking Price £625,000

Recently refurbished to a very high standard is this well proportioned detached House situated in Oak Road within Farnborough Park, just a stones from the town centre and within walking distance to the mainline station.

To the ground floor you are greeted by a lovely entrance hall, a super 23' open plan Kitchen/Diner/Family Room, a downstairs Cloakroom and a cosy Living Room.

The first floor boasts 3 spacious double Bedrooms, with an en-suite to the Master along with a spacious Landing with space for an office area, and a newly fitted Bathroom. Outside, there's a detached garage with a Utility Room behind it, lots of off road parking and low maintenance Gardens to both front and the South facing Rear Gardens. The property is offered for sale with no chain, making the buying process smooth and hassle-free.

Farnborough offers easy access to many amenities, including shops, gyms, supermarkets and transportation links.

- Superb refurbished detached Home.
- 3 Double Bedrooms and en-suite.
- 23ft Kitchen/Family room.
- Feature hallways and landing.
- No onward chain.
- Parking/garage and utility room.
- South facing rear gardens.
- Potential to extend STPP.
- Council tax band. E
- EPC energy rating band (c) 71

Viewing

Please contact our Fosters Sales Office on 01252 344333 if you wish to arrange a viewing appointment for this property or require further information.



3



2



2



C

Floor Plan

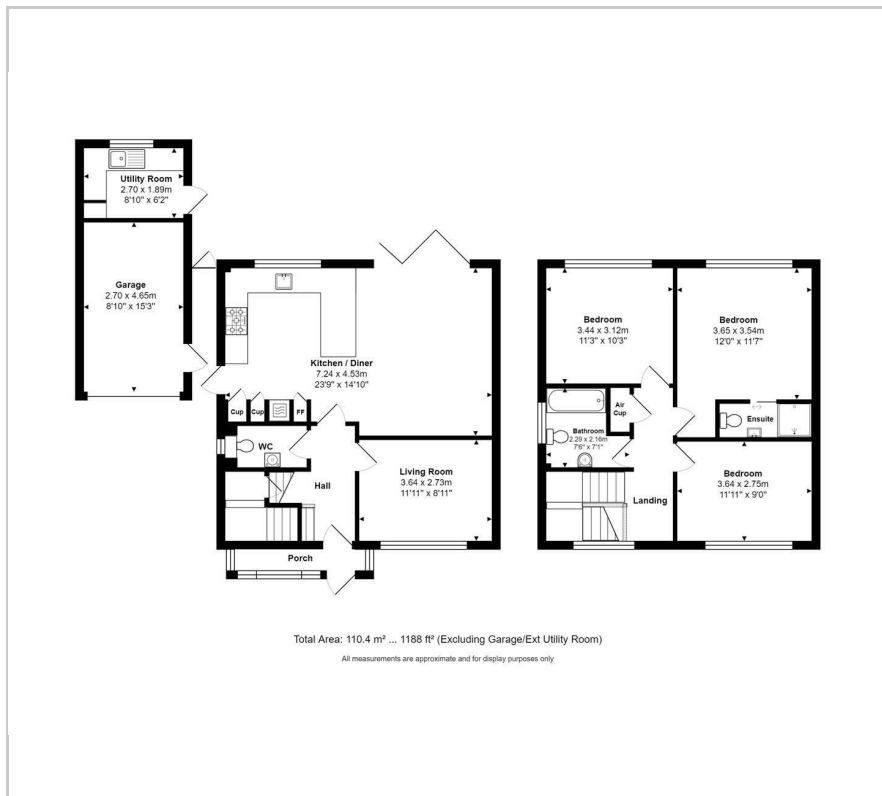

Area Map



Energy Efficiency Graph

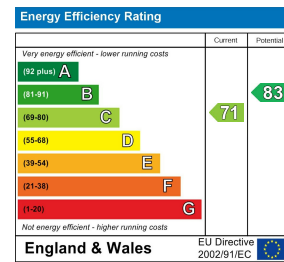

These particulars, whilst believed to be accurate are set out as a general outline only for guidance and do not constitute any part of an offer or contract. Intending purchasers should not rely on them as statements of representation of fact, but must satisfy themselves by inspection or otherwise as to their accuracy. No person in this firm's employment has the authority to make or give any representation or warranty in respect of the property.