



**fosters**  
sales & lettings



## Flat 5, Bembridge Court Ventnor Terrace, Newport Aldershot, GU12 4PD Asking Price £185,000

This Ground Floor Maisonette is very conveniently located within walking distance of Aldershot's Mainline Train Station and the Town Centre, as well as the popular Manor Park. For commuters it is also situated within very easy reach of the A331, A3 and M3.

The property boasts 2 double bedrooms, along with a generously sized lounge with separate kitchen and bathroom. There is Gas Central Heating throughout, and the flat is double glazed.

There is also allocated parking to the rear of the property.

This would make an ideal purchase for both investors and home buyers alike, so please call now to arrange an early viewing.

- Ground Floor Maisonette
- 2 Double Bedrooms
- Close to Aldershot Station and Town Centre
- Short Walk to Manor Park
- Allocated Parking
- 145 Year Lease
- Ground Rent Zero
- Annual Service Charge £850
- Council Tax Band C
- EPC C (75)

### Viewing

Please contact our Fosters Sales Office on 01252 344333 if you wish to arrange a viewing appointment for this property or require further information.



## Floor Plan

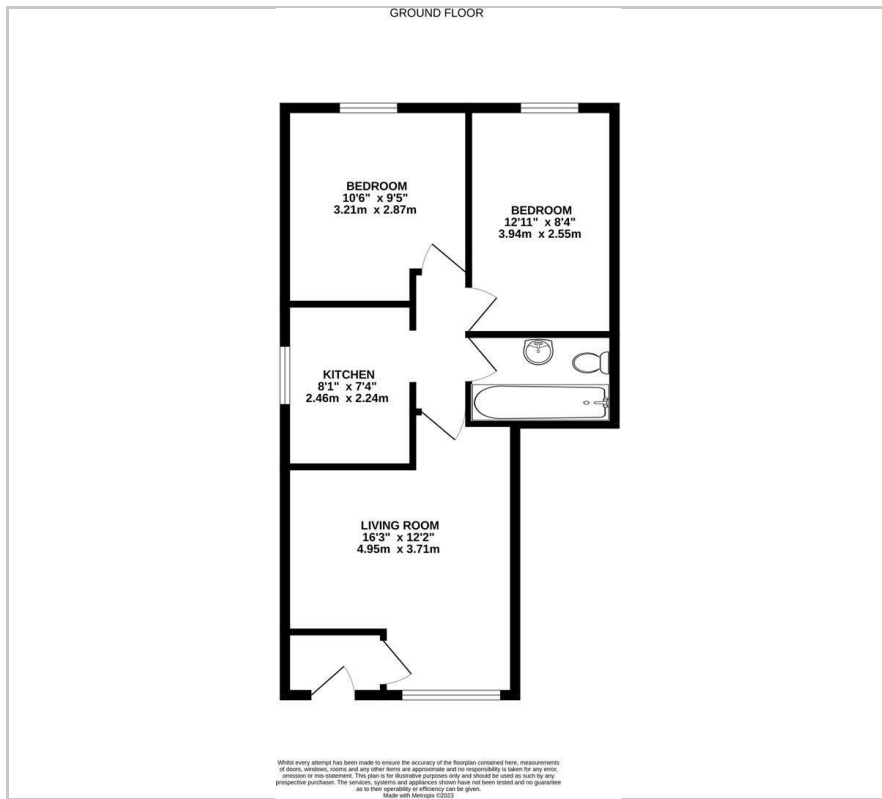

## Area Map

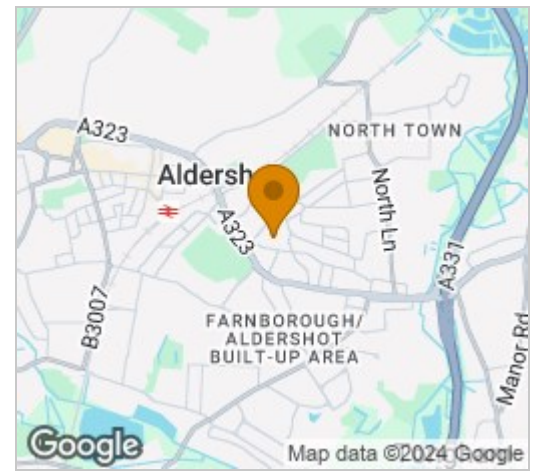

## Energy Efficiency Graph

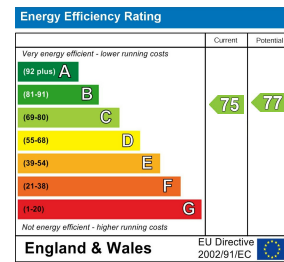

These particulars, whilst believed to be accurate are set out as a general outline only for guidance and do not constitute any part of an offer or contract. Intending purchasers should not rely on them as statements of representation of fact, but must satisfy themselves by inspection or otherwise as to their accuracy. No person in this firm's employment has the authority to make or give any representation or warranty in respect of the property.