



TO LET

Flat 6 80 - 82 Barton Road, Stretford, Manchester, M32 9AE
£825 Per Calendar Month pcm

www.jordanfishwick.co.uk

- AVAILABLE NOW
- One Bedroom Basement Flat
- Parking To The Rear
- EPC Rating E
- Close To Transport Links
- Tax Band A
- Private Entrance

THE PROPERTY

AVAILABLE NOW ... A one bedroom basement flat forming part of a converted period property. Close to good transport links. Lounge with separate kitchen with appliances. Double bedroom with adjoining shower room. Parking. EPC Rating E.

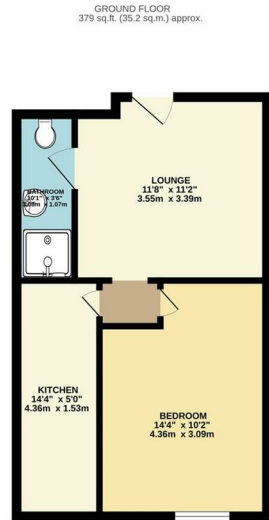

TOTAL FLOOR AREA: 379 sq.ft. (35.2 sq.m.) approx.
Measurements are approximate. Not to scale. Dimensions given are
Made with SketchUp 2022

Energy Efficiency Rating

	Current	Potential
<i>Very energy efficient - lower running costs</i>		
(92 plus) A		
(81-91) B		
(69-80) C		
(55-68) D		
(39-54) E	51	62
(21-38) F		
(1-20) G		
<i>Not energy efficient - higher running costs</i>		
England & Wales	EU Directive 2002/91/EC	