



jordanfishwick

Stuart Court
£795 PCM



Stuart Court, Macclesfield, SK10 3AZ £795 PCM



The Property

AVAILABLE NOW UNFURNISHED - VIEWING RECOMMENDED

Located on this quiet highly regarded road within walking distance of the town centre and hospital is this spacious ONE bedroom apartment. Local shops are within easy reach and The Bollin is also only a short walk away. With off road parking and double-glazed windows this ground floor apartment is ideal for the single professional or couple.

Communal entrance hall, private entrance hall, large open plan lounge/dining room, modern fitted kitchen with electric hob and oven, good sized double bedroom bathroom with shower over bath,

Contact Macclesfield office on 01625 502222. £795.00pcm

COUNCIL TAX A

EPC E

Directions

SK10 3AZ



- GROUND FLOOR APARTMENT
- ONE DOUBLE BEDROOM
- EASY REACH OF TOWN CENTRE
- SPACIOUS OPEN PLAN LIVING AREA
- OFF ROAD PARKING
- COUNCIL TAX A
- EPC E

Postcode - SK10 3AZ

EPC Rating - E

Floor Area - sq ft

Local Authority - Cheshire East

Council Tax - A



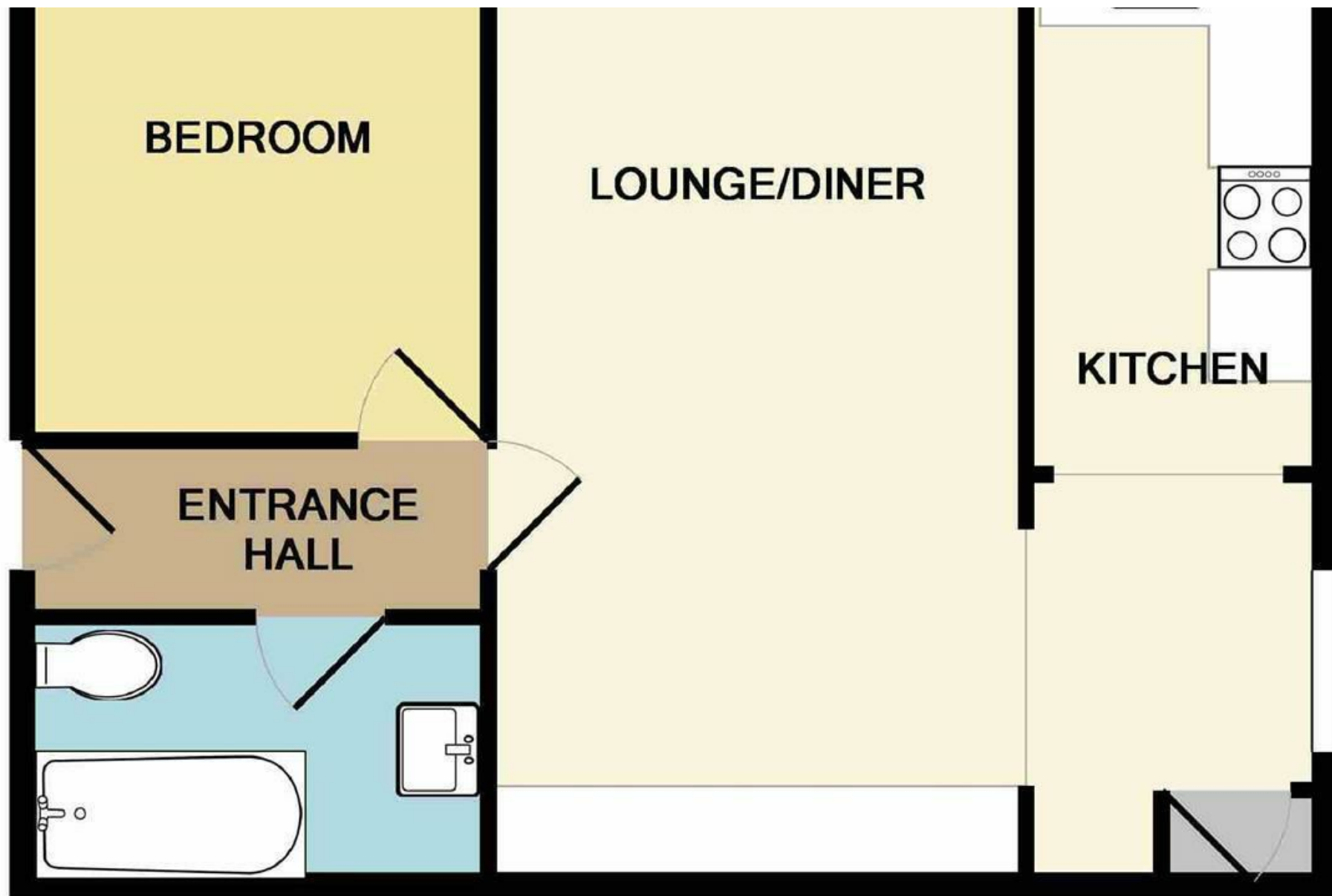

These particulars are believed to be accurate but they are not guaranteed and do not form a contract. Neither Jordan Fishwick nor the vendor or lessor accept any responsibility in respect of these particulars, which are not intended to be statements or representations of fact and any intending purchaser or lessee must satisfy himself by inspection or otherwise as to the correctness of each of the statements contained in these particulars. Any floorplans on this brochure are for illustrative purposes only and are not necessarily to scale.

Offices at: Chorlton, Didsbury, Disley, Hale, Glossop, Macclesfield, Manchester Deansgate, Manchester Whitworth Street, New Mills, Sale, Wilmslow and Withington

01625 502222