

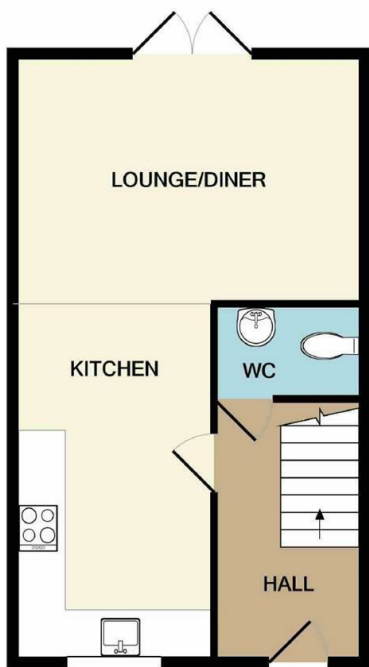

16A HATTON STREET MACCLESFIELD SK11 6RF

AVAILABLE EARLY AUGUST UNFURNISHED - VIEWING ESSENTIAL TO APPRECIATE - PLEASE NOTE PHOTOS PICTURED ARE OF THE SHOW HOME
 THREE DOUBLE BEDROOM town house complete with QUALITY KITCHEN, STYLISH BATHROOM AND EN-SUITE along with a ROOF TERRACE off the master bedroom, courtyard garden and PRIVATE PARKING for 2 cars.
 This select development of townhouses are set back from the road behind a dwarf wall and offer spacious modern and contemporary accommodation within walking distance of the town centre and train station.
 Entrance hall with under stairs storage, downstairs W.C, stylish fitted kitchen with electric hob and oven, washer dryer, dishwasher and fridge freezer. The elegant living area opens to the courtyard garden which leads to the allocated parking.
 To the first floor are two double bedrooms and a stylishly fitted bathroom with shower over bath.
 The second floor offers another spacious double bedroom with French doors opening out to the roof terrace and a stylish en-suite.
 Contact Macclesfield 01625 502222 £1395.00 pcm
 COUNCIL TAX C
 EPC C



GROUND FLOOR

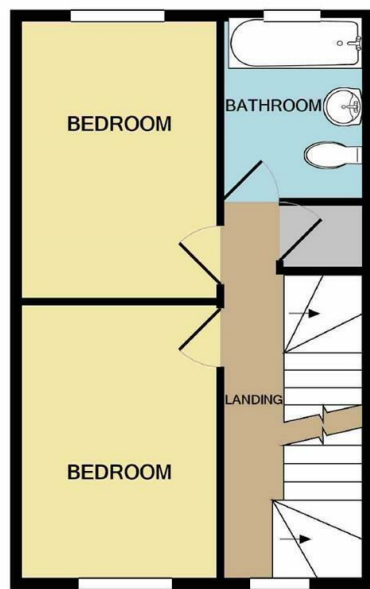

1ST FLOOR



2ND FLOOR

Measurements are approximate. Not to scale. Illustrative purposes only
 Made with Metropix ©2021

Energy Efficiency Rating		Current	Potential
Very energy efficient - lower running costs			
(92 plus) A			87
(81-91) B		71	
(69-80) C			
(55-68) D			
(39-54) E			
(21-38) F			
(1-20) G			
Not energy efficient - higher running costs			
England & Wales		EU Directive 2002/91/EC	