



jordan fishwick

7 Ploughmans Way, SK10 2UN
PCM £1,395 PCM



Ploughmans Way Macclesfield

£1,395 PCM



AVAILABLE NOW PART OR FURNISHED

This delightful family home is tucked away on a quiet road on the highly popular Tytherington Development.

Currently undergoing redecoration and some carpet replacement this super family home benefits from three bedrooms and two bathrooms along with off road parking and a sunny enclosed rear garden.

Entrance hall, downstairs WC, open plan lounge diner with doors to rear garden and understairs storage, fitted kitchen with gas hob and electric oven, washing machine and fridge and door to rear garden.

To the first floor three well proportioned bedrooms one with en suite shower room and family bathroom with shower over bath.

Contact Macclesfield 01625 502222 £1395.00pcm



- HIGHLY POPULAR LOCATION
- THREE BEDROOMS
- TWO BATHROOMS
- OFF ROAD PARKING
- EPC RATING D
- COUNCIL TAX C



Energy Efficiency Rating		
	Current	Potential
Very energy efficient - lower running costs		
(92 plus) A		
(81-91) B		82
(69-80) C	67	
(55-68) D		
(39-54) E		
(21-38) F		
(1-20) G		
Not energy efficient - higher running costs		
England & Wales	EU Directive 2002/91/EC 	



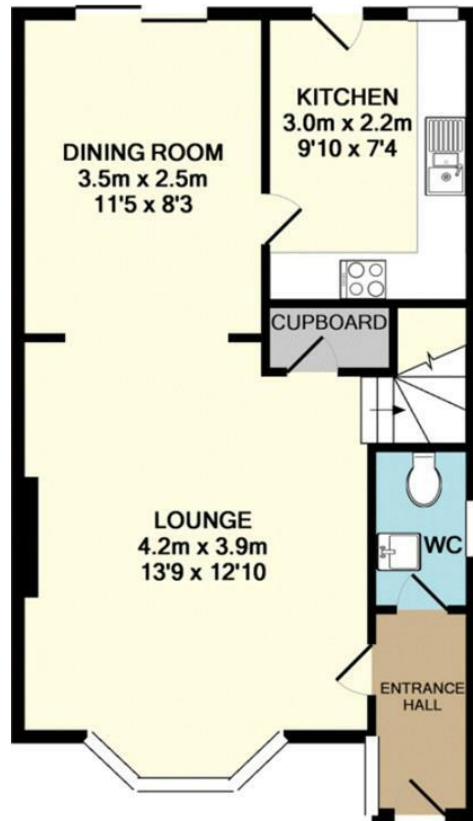

GROUND FLOOR
APPROX. FLOOR
AREA 42.1 SQ.M.
(453 SQ.FT.)



1ST FLOOR
APPROX. FLOOR
AREA 38.1 SQ.M.
(410 SQ.FT.)

TOTAL APPROX. FLOOR AREA 80.2 SQ.M. (863 SQ.FT.)

Whilst every attempt has been made to ensure the accuracy of the floor plan contained here, measurements of doors, windows, rooms and any other items are approximate and no responsibility is taken for any error, omission, or mis-statement. This plan is for illustrative purposes only and should be used as such by any prospective purchaser. The services, systems and appliances shown have not been tested and no guarantee as to their operability or efficiency can be given

Made with Metropix ©2018



These particulars are believed to be accurate but they are not guaranteed and do not form a contract. Neither Jordan Fishwick nor the vendor or lessor accept any responsibility in respect of these particulars, which are not intended to be statements or representations of fact and any intending purchaser or lessee must satisfy himself by inspection or otherwise as to the correctness of each of the statements contained in these particulars. Any floorplans on this brochure are for illustrative purposes only and are not necessarily to scale.

Offices at: Chorlton, Didsbury, Disley, Hale, Glossop, Macclesfield, Manchester Deansgate, Manchester Whitworth Street, New Mills, Sale, Wilmslow and Withington

84-86 Waters Green, Macclesfield, SK11 6LH

01625 502222

macc@jordanfishwick.co.uk

www.jordanfishwick.co.uk