



jordan fishwick

41 Alveston Drive, SK9 2GA
Guide Price £375,000



Alveston Drive Wilmslow SK9 2GA

Guide Price £375,000



Take a look into this beautiful three bedroom home which comprises many great features. The property is a short drive away from Wilmslow centre which offers a wide range of amenities, including a number of local shopping facilities, bars, restaurants and leisure centre. Wilmslow train station offers a direct service to London Euston and Manchester City centre and the location caters for many different needs. Within a 10 minute drive away there are many additional amenities such as fitness centres, golf courses, Marks and Spencer and John Lewis. The property is well placed for easy access to the M56 for commuters to Manchester and the North West commercial centres and Manchester Airport is less than 20 minutes away. The accommodation offers many modern and stylish features including the open plan kitchen diner with complementary wall and base mounted units and an island unit. The ground floor also benefits from a downstairs wc and living room with a beautiful electric living flame effect fire, surround and mantelpiece. To the first floor, the property has three bedrooms and a family bathroom which offers a modern fitted three piece suite. Externally there are two off-road parking spaces, well maintained front gardens and an enclosed private rear garden. Viewings essential.





- Semi Detached
- Popular Location
- Three Bedrooms
- Off Road Parking
- Open plan kitchen diner
- Enclosed garden space
- Downstairs WC
- UPVC double glazed



Energy Efficiency Rating		
	Current	Potential
Very energy efficient - lower running costs		
(92 plus) A		
(81-91) B		87
(69-80) C	75	
(55-68) D		
(39-54) E		
(21-38) F		
(1-20) G		
Not energy efficient - higher running costs		
England & Wales		EU Directive 2002/91/EC 



GROUND FLOOR



1ST FLOOR

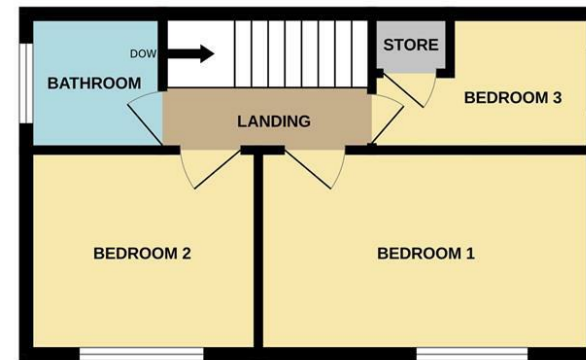

Measurements are approximate. Not to scale. Illustrative purposes only
Made with Metropix ©2024



These particulars are believed to be accurate but they are not guaranteed and do not form a contract. Neither Jordan Fishwick nor the vendor or lessor accept any responsibility in respect of these particulars, which are not intended to be statements or representations of fact and any intending purchaser or lessee must satisfy himself by inspection or otherwise as to the correctness of each of the statements contained in these particulars. Any floorplans on this brochure are for illustrative purposes only and are not necessarily to scale.

Offices at: Chorlton, Didsbury, Disley, Hale, Glossop, Macclesfield, Manchester Deansgate, Manchester Whitworth Street, New Mills, Sale, Wilmslow and Withington

36-38 Alderley Road, Wilmslow SK91JX
01625 532000

wilmslow@jordanfishwick.co.uk
www.jordanfishwick.co.uk