



jordanfishwick

10 Hough Lane

£3,750 PCM



10 Hough Lane, Wilmslow, SK9 2LQ

£3,750 PCM

AVAILABLE NOW - PART FURNISHED VIEWING
ESSENTIAL TO APPRECIATE

Kingsley Lodge is an outstanding, well proportioned, three bedroom, three bathroom property finished to an immaculate standard set behind a double gated driveway with gardens to front side and rear.

This stunning house is located on one of Wilmslows most highly regarded roads and is within easy walking distance of the town centre and train station

Private gated driveway with parking. Entrance hall with wc/shower room, Utility room. Third bedroom/study. Contemporary open-plan living space with impressive luxury fitted kitchen leading to lounge with doors to rear garden. The first floor features two double bedrooms each with its own en-suite bathroom. One of the bedrooms is the stunning master suite which has a separate dressing room area, Juliet balcony overlooking the rear garden. Decked patio and landscaped garden

Contact the Wilmslow Office 01625 536300
£3750.00pcm

COUNCIL TAX E

EPC C

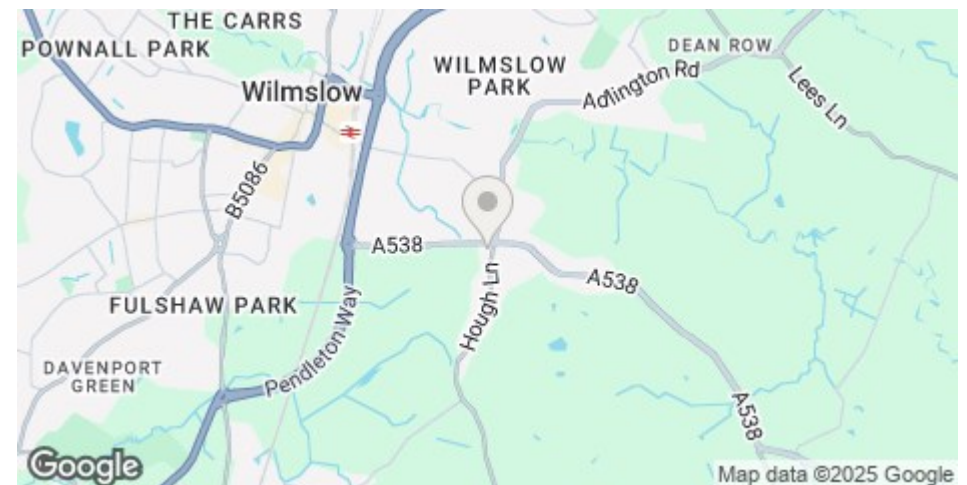

- THREE BEDROOMS
- THREE BATHROOMS
- TWO RECEPTION ROOMS
- FABULOUS GARDENS
- IMMACULATE CONDITON
- GATED
- CLOSE TO TOWN CENTRE AND TRAIN STATION
- COUNCIL TAX E
- EPC C

Postcode - SK9 2LQ

EPC Rating - C

Floor Area - sq ft

Local Authority - Cheshire East

Council Tax - E



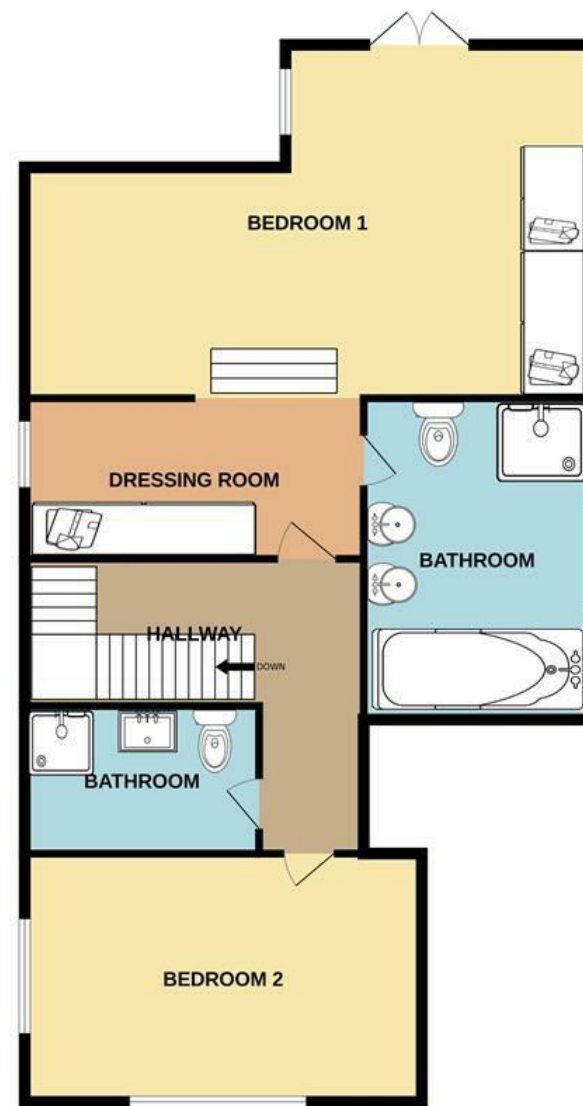

These particulars are believed to be accurate but they are not guaranteed and do not form a contract. Neither Jordan Fishwick nor the vendor or lessor accept any responsibility in respect of these particulars, which are not intended to be statements or representations of fact and any intending purchaser or lessee must satisfy himself by inspection or otherwise as to the correctness of each of the statements contained in these particulars. Any floorplans on this brochure are for illustrative purposes only and are not necessarily to scale.

Offices at: Offices at Chorlton, Didsbury, Disley, Hale, Glossop, Macclesfield, Manchester Deansgate, Manchester Whitworth Street, New Mills, Sale, Wilmslow and Withington

01619291994