



jordan fishwick

25 Burnside Close, SK9 1EL
Guide Price £225,750



Burnside Close Wilmslow SK9 1EL

Guide Price £225,750

This EXTENDED END mews property is part of the Cheshire East Council's covenant scheme and is offered at a 30% discounted price. Conditions apply as part of this shared EQUITY scheme with the advertising price representing 70% of the total value. The purpose of the scheme is to aid first time buyers living within the area who could not ordinarily afford to purchase. Located on Burnside Close this shared equity property consists in brief of an entrance porch, spacious living room with open plan staircase leading to the first floor accommodation. There is a fitted kitchen with space for a dining table and chair set and UPVC double glazed patio doors leading to the family room (extension). This family room offers an additional reception room and has a large set of Bi fold doors leading to the rear garden. Located on the first floor there are two double bedrooms and a family bathroom which is fitted with a three-piece white bathroom suite. Externally to the rear of the property there is a garden which is enclosed to the perimeter with fencing and is laid with artificial turf. There is a useful summer/play house for additional storage. The property also benefits from off-road parking to the side of the property.





- Shared Equity Scheme for Local people
- End Mews
- Extended to the rear
- Bi fold doors
- Two double bedrooms
- Modern Bathroom
- Off road parking



| Energy Efficiency Rating | | |
|---|---------|----------------------------|
| | Current | Potential |
| Very energy efficient - lower running costs | | |
| (92 plus) A | | |
| (81-91) B | | |
| (69-80) C | | |
| (55-68) D | | |
| (39-54) E | | |
| (21-38) F | | |
| (1-20) G | | |
| Not energy efficient - higher running costs | | |
| England & Wales | | EU Directive 2002/91/EC |
| | | |



GROUND FLOOR

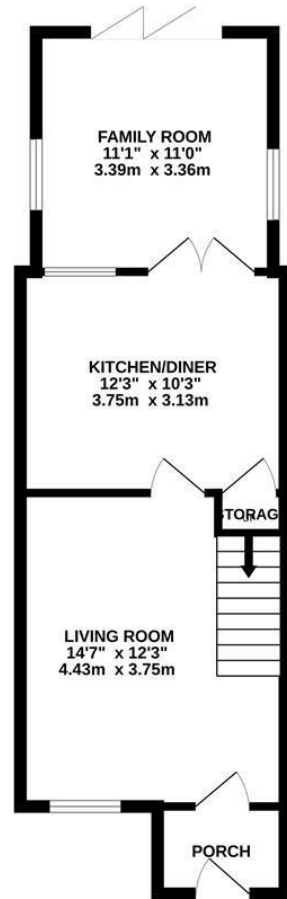

1ST FLOOR

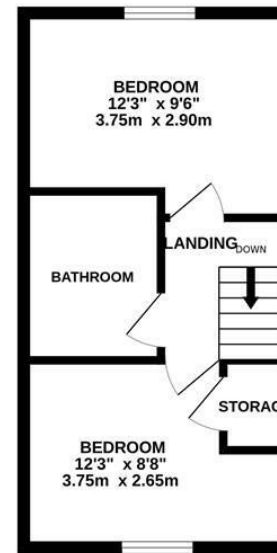

Measurements are approximate. Not to scale. Illustrative purposes only.
Made with Metropix ©2025



These particulars are believed to be accurate but they are not guaranteed and do not form a contract. Neither Jordan Fishwick nor the vendor or lessor accept any responsibility in respect of these particulars, which are not intended to be statements or representations of fact and any intending purchaser or lessee must satisfy himself by inspection or otherwise as to the correctness of each of the statements contained in these particulars. Any floorplans on this brochure are for illustrative purposes only and are not necessarily to scale.

Offices at: Chorlton, Didsbury, Disley, Hale, Glossop, Macclesfield, Manchester Deansgate, Manchester Whitworth Street, New Mills, Sale, Wilmslow and Withington

36-38 Alderley Road, Wilmslow, Cheshire, SK9 1JX

01625 532000

wilmslow@jordanfishwick.co.uk

www.jordanfishwick.co.uk