



jordan fishwick

162 Gillbent Road, SK8 6NJ
PCM £1,200 PCM



Gillbent Road Cheadle Hulme

£1,200 PCM



AVAILABLE EARLY JUNE UNFURNISHED - VIEWING HIGHLY RECOMMENDED

This refurbished two bedroom maisonette is located on this popular development close to the A34 and within easy reach of Wilmslow, Alderley Edge and Manchester International Airport.

Ideally suited to a professional couple or small family. Comprising of entrance hall with storage and stairs to first floor with good sized lounge, spacious kitchen with electric hob and oven.

To the second floor two double bedrooms and spacious bathroom with shower over bath.

Gas central heating, fully double glazed,

Contact Wilmslow 01625 536300 £1200.00pcm

COUNCIL TAX B

EPC C



- MAISONETTE
- TWO BEDROOMS
- POPULAR LOCATION
- SPACIOUS INTERIOR
- MODERN KITCHENS AND BATHROOMS
- COUNCIL TAX B
- EPC C



Energy Efficiency Rating		
	Current	Potential
Very energy efficient - lower running costs		
(92 plus) A		
(81-91) B	80	81
(69-80) C		
(55-68) D		
(39-54) E		
(21-38) F		
(1-20) G		
Not energy efficient - higher running costs		
England & Wales	EU Directive 2002/91/EC 	

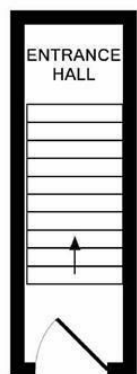

GROUND FLOOR

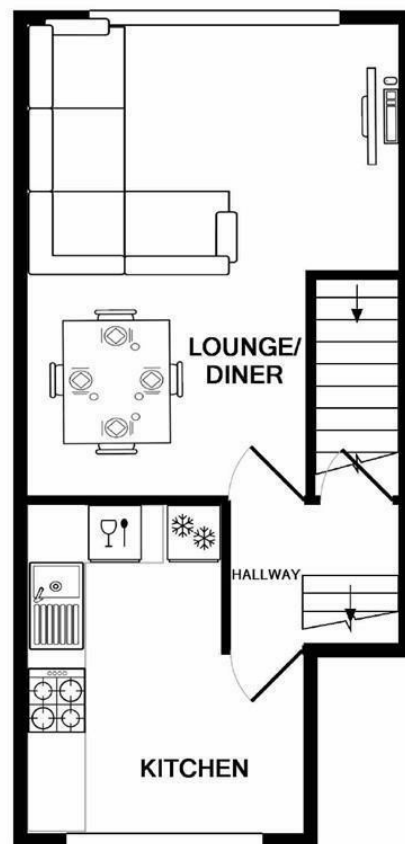

1ST FLOOR

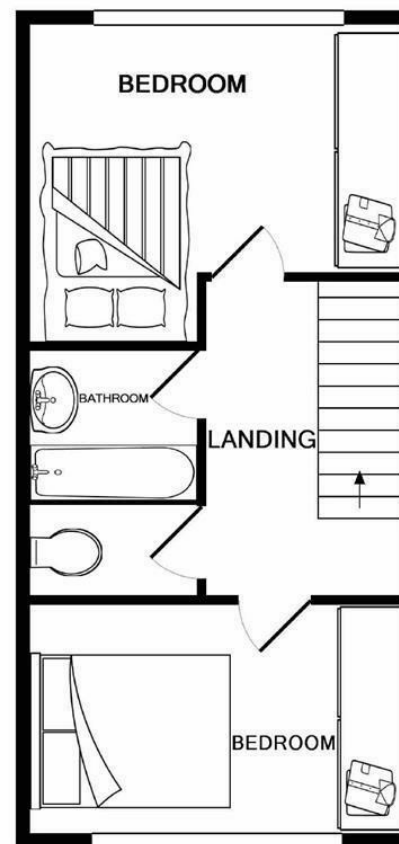

2ND FLOOR

Whilst every attempt has been made to ensure the accuracy of the floor plan contained here, measurements of doors, windows, rooms and any other items are approximate and no responsibility is taken for any error, omission, or mis-statement. This plan is for illustrative purposes only and should be used as such by any prospective purchaser. The services, systems and appliances shown have not been tested and no guarantee as to their operability or efficiency can be given
Made with Metropix ©2018



These particulars are believed to be accurate but they are not guaranteed and do not form a contract. Neither Jordan Fishwick nor the vendor or lessor accept any responsibility in respect of these particulars, which are not intended to be statements or representations of fact and any intending purchaser or lessee must satisfy himself by inspection or otherwise as to the correctness of each of the statements contained in these particulars. Any floorplans on this brochure are for illustrative purposes only and are not necessarily to scale.

Offices at: Chorlton, Didsbury, Disley, Hale, Glossop, Macclesfield, Manchester Deansgate, Manchester Whitworth Street, New Mills, Sale, Wilmslow and Withington

01625 536300

wilmslow@jordanfishwick.co.uk
www.jordanfishwick.co.uk