



jordan fishwick

2 Fieldview Mossways Park, SK9 5PA
Guide Price £135,000



Mossways Park Wilmslow SK9 5PA

Guide Price £135,000



NO CHAIN (Occupier's over 50's) Jordan Fishwick are delighted to offer this two bedroom park home which offers modernised accommodation boasting a beautiful rural setting whilst being in close proximity to Wilmslow. Set in the quiet location of Mobberley, popular towns in the surrounding areas include Knutsford, Wilmslow and Alderley Edge offering great local amenities and attractions in and around.

'The residential park home is immaculately presented and ready to move in to and in brief comprises a spacious living area offering ample room for entertaining and dining furniture, as well as featuring box bay windows to the front and side aspect. A sizeable kitchen that presents wall and floor fitted units with complementary worktops and multiple integrated appliances. Two double bedrooms are well presented, with bedroom one promoting a walk-in wardrobe and a modernised ensuite with shower cubicle, and bedroom two having fitted storage. The family bathroom comprises of a three piece white bathroom suite. Externally the home provides a private parking space at the rear of the property, space for outdoor seating, established low maintenance borders with no lawn to maintain, and is a stone's throw away from idyllic views. Viewing essential to appreciate'.



- Semi Rural Setting
- Two Double Bedroom Accommodation
- Ensuite
- Spacious Living Area
- Off Road Parking
- Mossways Park, Mobberley
- No Chain



GROUND FLOOR

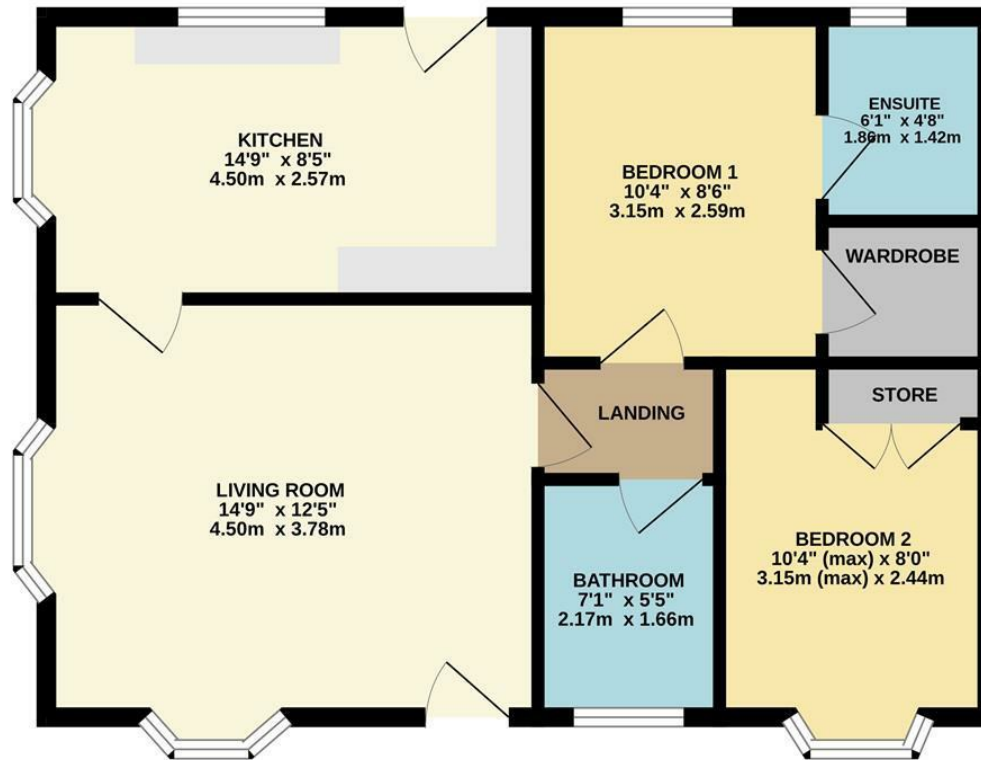

Measurements are approximate. Not to scale. Illustrative purposes only.
Made with Metropix ©2025



These particulars are believed to be accurate but they are not guaranteed and do not form a contract. Neither Jordan Fishwick nor the vendor or lessor accept any responsibility in respect of these particulars, which are not intended to be statements or representations of fact and any intending purchaser or lessee must satisfy himself by inspection or otherwise as to the correctness of each of the statements contained in these particulars. Any floorplans on this brochure are for illustrative purposes only and are not necessarily to scale.

Offices at: Chorlton, Didsbury, Disley, Hale, Glossop, Macclesfield, Manchester Deansgate, Manchester Whitworth Street, New Mills, Sale, Wilmslow and Withington

36-38 Alderley Road, Wilmslow SK91JX

01625 532000

wilmslow@jordanfishwick.co.uk

www.jordanfishwick.co.uk