



jordanfishwick

32 MOSSWAYS PARK WILMSLOW SK9 5PA
Price £164,950

32 MOSSWAYS PARK WILMSLOW SK9 5PA

(Occupiers Over 50's) Located within a beautiful rural setting whilst still enjoying close proximity to Wilmslow, take a look at this two double bedroom property which offers stylish and modernised accommodation. Set in the quiet location of Mobberley, popular towns in the surrounding areas include Knutsford, Wilmslow and Alderley Edge offering great local amenities and attractions in and around the area.

An attractive park home which internally comprises, a private and spacious entrance hallway. The kitchen offers multiple integrated appliances including dishwasher, fridge freezer and more. As well as enjoying the benefit of UPVC double glazing throughout. To the front aspect a spacious living/dining area comprises of multiple windows creating excellent natural light. Additionally the property offers two double bedrooms which have built in wardrobe/storage space, one bedroom provides a shower room/ en suite. There is also a modern three piece family bathroom suite, featuring heated towel rail and complementary splashback tiles. Externally, the home offers a good size low maintenance private plot including a shed for extra storage space.



GROUND FLOOR
676 sq.ft. (62.8 sq.m.) approx.

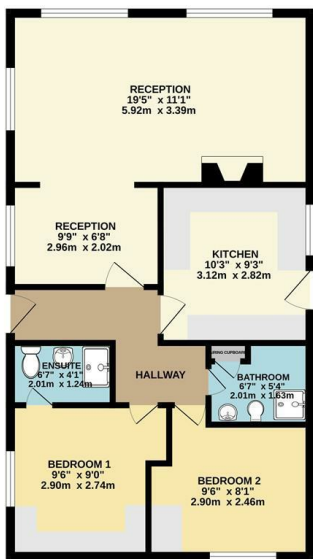

TOTAL FLOOR AREA - 676 sq.ft. (62.8 sq.m.) approx.
Measurements are approximate. Not to scale. Not for construction purposes only.
Made with Blueprints 2020.



- Park Home
- No Chain
- Two bedrooms
- Ensuite
- Parking
- Large open plan Living Dining Space
- Over 50's