





Introducing "Fortingall", a spacious four bedroom detached family home set behind electric gates, set on Hollin Lane in Styal, providing easy access to Wilmslow, the A34, M56 & M60, and being a short walk from Quarry Bank Mill. The property has been re-modelled by the current owners creating a light and airy home with generous rooms, all flooded with light and in excellent condition throughout. The accommodation briefly comprises, Entrance Hall, Cinema Room, Dining Room, a 34' x 18' open plan Lounge / Kitchen / Dining Room, Playroom, Cloakroom & Utility. To the first floor are four double bedrooms, two sharing a Jack & Jill En-Suite, and a Family Bathroom. The block paved driveway provides parking for 6-8 cars, and the rear garden is private, not overlooked and enclosed. The property further benefits from having planning consent granted for a two storey rear, and single storey side extension ( 22/2363M )



- Detached, Gated, Four Bedroom Family Home
- Re-modelled by current owners creating a modern, spacious home
- Cinema Room, Dining Room, Playroom & 34' x 18' Open Plan Kitchen/ Living Dining / Room
  - Parking for 6-8 cars. Rear garden, enclosed and not overlooked
- Easy access to Wilmslow, A34, Motorway Network and Manchester City Centre
  - Nearby Quarry Bank Mill Estate
- Planning Consent Granted for Two Storey Extension



Hollin Lane, Wilmslow  
Total Approx. Floor Area 2338 Sq.ft. (217.3 Sq.M.)

Surveyed and drawn by Lens Media for illustrative purposes only. Not to scale. Whilst every attempt was made to ensure the accuracy of the floor plan, all measurements are approximate and no responsibility is taken for any error.

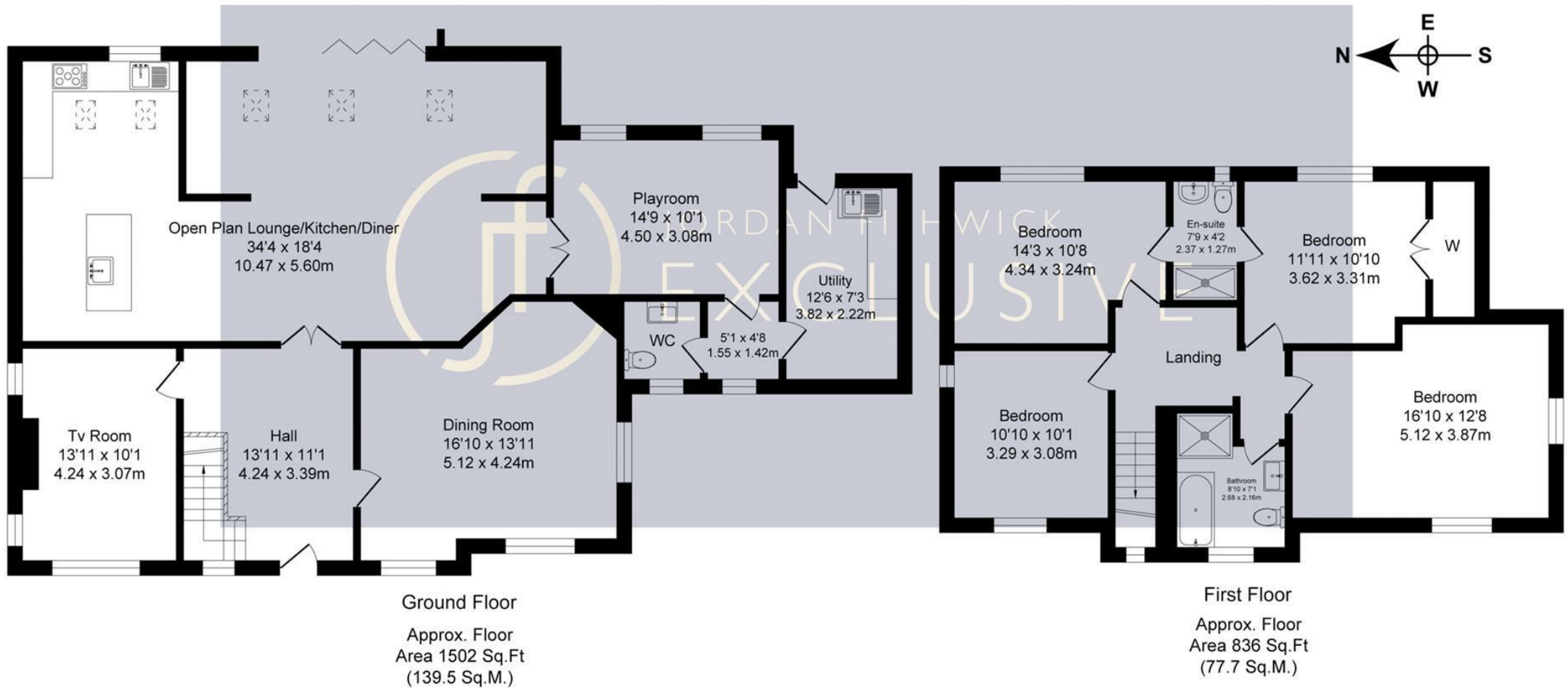

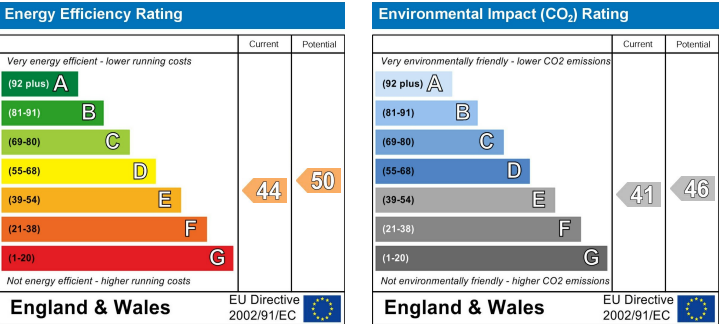

IMPORTANT: we would like to inform prospective purchasers that these sales particulars have been prepared as a general guide only. A detailed survey has not been carried out, nor the services, appliances and fittings tested. Room sizes should not be relied upon for furnishing purposes and are approximate. If floor plans are included, they are for guidance only and illustration purposes only and may not be to scale. If there are any important matters likely to affect your decision to buy, please contact us before viewing the property.



JORDAN FISHWICK  
EXCLUSIVE

Jordan Fishwick  
36-38 Alderley Road, Wilmslow, Cheshire, SK9 1JX  
01625 532000  
wilmslow@jordanfishwick.co.uk  
[www.jfexclusive.co.uk](http://www.jfexclusive.co.uk)