



*jordanfishwick*

Copperfields

£1,950 PCM





# Copperfields, Wilmslow, SK9 2JZ £1,950 PCM



## The Property

AVAILABLE LATE APRIL PART FURNISHED - EXCELLENT LOCATION

Situated within easy reach of the town centre and train station and located on this highly regarded road is this three-bedroom link detached property. Presented in immaculate order throughout and benefitting from front and rear gardens along with a single garage this property makes an ideal family home. Entrance hall, lounge with bay window with arch to dining room with doors to rear garden and leading to modern fitted kitchen with gas hob and electric oven, fridge freezer and dishwasher, good sized utility room with washing machine and dryer and door to garage, downstairs WC. To the first floor three good sized bedrooms two with fitted wardrobes, bathroom with separate shower cubicle. Fully enclosed rear garden. Off road parking. Garage.

Contact Wilmslow 01625 536300 £1950.00pcm VIEWING ESSENTIAL TO APPRECIATE.

## Directions

SK9 2JZ





- THREE BEDROOMS
- GARAGE
- CUL DE SAC LOCATION
- WALKING DISTANCE OF WILMSLOW
- EXTREMELY POPULAR LOCATION
- COUNCIL TAX E
- EPC C

Postcode - SK9 2JZ

EPC Rating - C

Floor Area - sq ft

Local Authority - Cheshire East

Council Tax - E





GROUND FLOOR

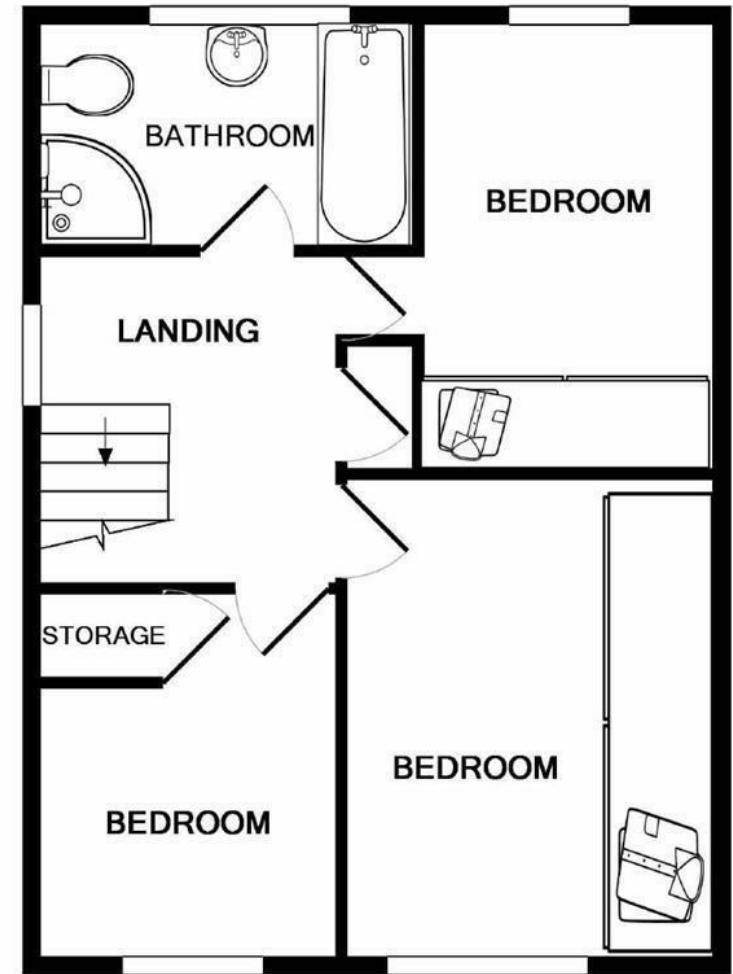

1ST FLOOR



These particulars are believed to be accurate but they are not guaranteed and do not form a contract. Neither Jordan Fishwick nor the vendor or lessor accept any responsibility in respect of these particulars, which are not intended to be statements or representations of fact and any intending purchaser or lessee must satisfy himself by inspection or otherwise as to the correctness of each of the statements contained in these particulars. Any floorplans on this brochure are for illustrative purposes only and are not necessarily to scale.

Offices at: Chorlton, Didsbury, Disley, Hale, Glossop, Macclesfield, Manchester Deansgate, Manchester Whitworth Street, New Mills, Sale, Wilmslow and Withington

01625 536300