



18, WOODVILLE AVENUE MOSSWAYS PARK WILMSLOW SK9 5PA

NO CHAIN. (Occupier's over 50's) Take a look at this two bedroom park home that offers stylish and modernised accommodation that boasts a beautiful rural setting whilst being in close proximity to Wilmslow. Set in the quiet location of Mobberley, popular towns in the surrounding areas include Knutsford, Wilmslow and Alderley Edge offering great local amenities and attractions in and around.

The well presented park home comprises in brief, an excellent sized open aspect living / dining area with feature electric fire media wall, UPVC sliding patio doors and plenty of windows let in natural light. The kitchen area promotes a stylist touch with matching wall and base unit's, complimentary worktop surfaces and multiple integrated appliances. Additionally the home offers two bedrooms, both with fitted wardrobe facilities and one which presents a contemporary en-suite shower room. The main family bathroom consists of a three piece white bathroom suite, with features of monochrome tiles and under sink vanity storage. Externally, the property offers a low maintenance and sociable garden space which is mostly laid to patio but also accommodates AstroTurf areas. Two off-road parking spaces can be found to the right aspect. Viewings essential.



GROUND FLOOR

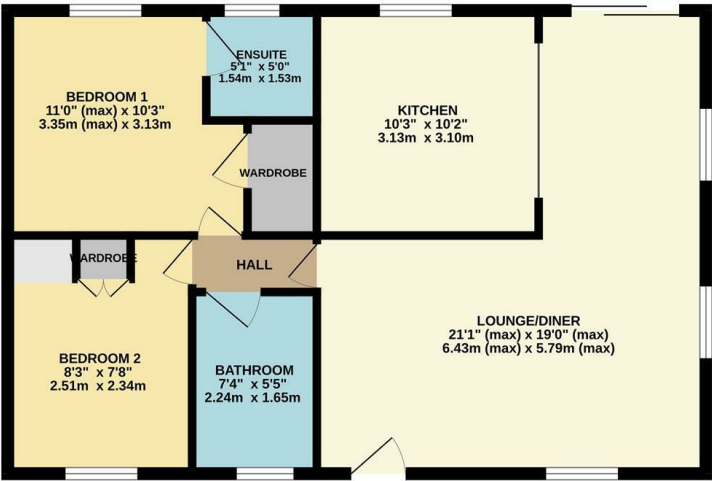

Measurements are approximate. Not to scale. Illustrative purposes only. Made with MetreXplore (2025)



- No Chain
- Semi Rural Setting
- Stylish Park Home Living
- Two Bedrooms
- Open Plan Living Dining Area
- Ensuite
- Off Road Parking
- Mossways Park, Mobberley

Energy Efficiency Rating		Current	Potential
Very energy efficient - lower running costs			
(92 plus)	A		
(81-91)	B		
(69-80)	C		
(55-68)	D		
(39-54)	E		
(21-38)	F		
(1-20)	G		
Not energy efficient - higher running costs			
England & Wales		EU Directive 2002/91/EC	

Environmental Impact (CO ₂) Rating		Current	Potential
Very environmentally friendly - lower CO ₂ emissions			
(92 plus)	A		
(81-91)	B		
(69-80)	C		
(55-68)	D		
(39-54)	E		
(21-38)	F		
(1-20)	G		
Not environmentally friendly - higher CO ₂ emissions			
England & Wales		EU Directive 2002/91/EC	