



*jordan fishwick*

Altrincham Road

£1,495 PCM





## Altrincham Road, Wilmslow, SK9 5NN £1,495 PCM



### The Property

AVAILABLE MID APRIL PART FURNISHED - VIEWING RECOMMENDED

Forming part of a small row of terraces is this refurbished and extremely spacious 3/4-bedroom property.

Located to the South of Wilmslow town centre but within easy walking distance of the train station and benefitting from off road parking to the rear and garage and only a short drive to Manchester International Airport and the motorway networks.

Entrance hall with stairs to first floor, fitted kitchen with electric hob and oven, fridge freezer, dishwasher and washer dryer, lounge with feature fireplace, two double bedrooms, bathroom with shower.

To the second floor two further good-sized bedrooms. Off road parking, Water included.

NO GARDEN BUT GARAGE AND AMPLE OFF-ROAD PARKING

Contact Wilmslow 01625 536300 £1495.00pcm

### Directions

SK9 5NN





- MID TERRACE
- GARAGE
- OFF ROAD PARKING
- THREE / FOUR BEDROOMS
- THREE RECEPTION ROOMS
- COUNCIL TAX C
- EPC E

Postcode - SK9 5NN

EPC Rating - E

Floor Area - sq ft

Local Authority - Cheshire East Council

Council Tax - C





1ST FLOOR  
APPROX. FLOOR  
AREA 1079 SQ.FT.  
(100.3 SQ.M.)

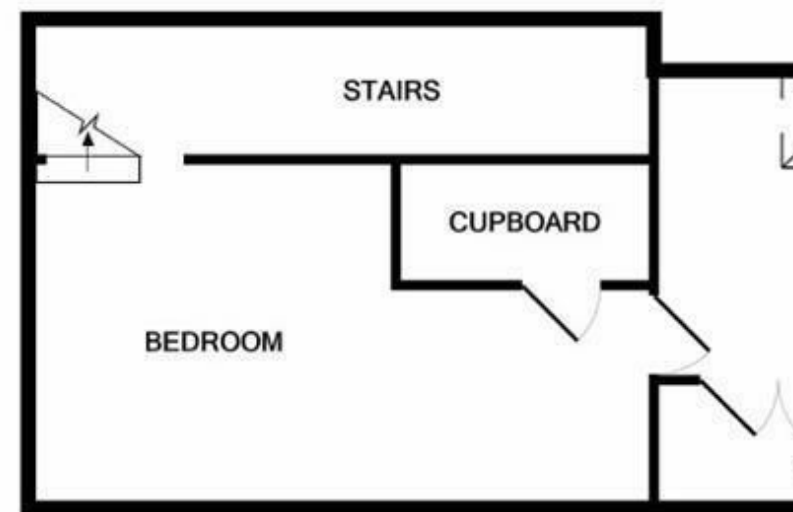

2ND FLR  
APPROX. FLOOR  
AREA 696  
(64.7 SQ.M.)

TOTAL APPROX. FLOOR AREA 1889 SQ.FT. (175.5 SQ.M.)  
Measurements are approximate. Not to scale. Illustrative purposes only  
Made with Metropix ©2020



These particulars are believed to be accurate but they are not guaranteed and do not form a contract. Neither Jordan Fishwick nor the vendor or lessor accept any responsibility in respect of these particulars, which are not intended to be statements or representations of fact and any intending purchaser or lessee must satisfy himself by inspection or otherwise as to the correctness of each of the statements contained in these particulars. Any floorplans on this brochure are for illustrative purposes only and are not necessarily to scale.

Offices at: Chorlton, Didsbury, Disley, Hale, Glossop, Macclesfield, Manchester Deansgate, Manchester Whitworth Street, New Mills, Sale, Wilmslow and Withington

01625 536300