



*Jordan fishwick*

WILMSLOW  
Ladyfield Terrace



# Ladyfield Terrace, Wilmslow, SK9 1BP

£1,300 PCM



## The Property

AVAILABLE NOW PART FURNISHED - VIEWING RECOMMENDED

Located on a quiet cul de sac in central Wilmslow this attractive mid terrace offers characterful and modern accommodation throughout. With the train station and town center both only a short walk away this spacious mid terrace is an ideal choice for the professional person or couple.

The ground floor comprises in brief: a well proportioned living room with feature open fireplace and a contemporary fitted dining kitchen.

The first floor comprises: two well proportioned bedrooms and a white four piece bathroom suite. To the front of the property there is a low maintenance garden area with brick wall, whilst to the rear there is a sunny landscaped pebbled courtyard garden.

Contact Wilmslow 01625 536300 £1300.00pcm

EPC C

COUNCIL TAX C

## Directions

SK9 1BP



Map data ©2024 Google

- MID TERRACE
- CENTRAL LOCATION
- TWO BEDROOMS
- WALKING DISTANCE OF TRAIN STATION
- SUNNY COURTYARD GARDEN TO THE REAR
- PERMIT PARKING
- COUNCIL TAX C
- EPC C

Postcode - SK9 1BP

EPC Rating - C

Floor Area - sq ft

Local Authority - Cheshire East

Council Tax - C



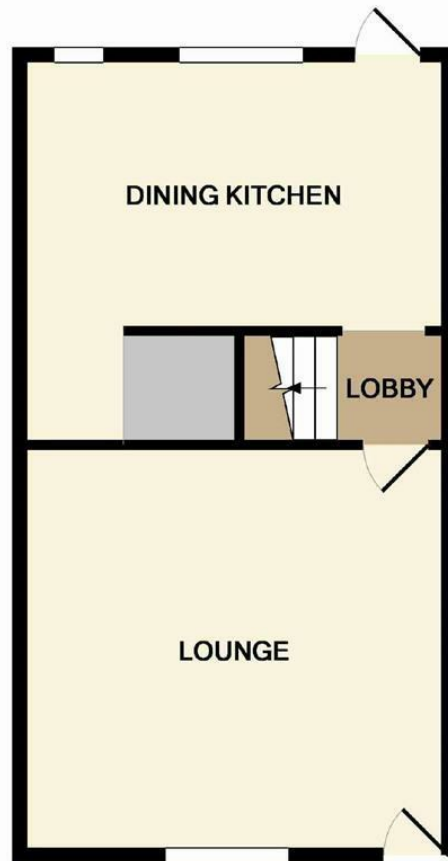

GROUND FLOOR

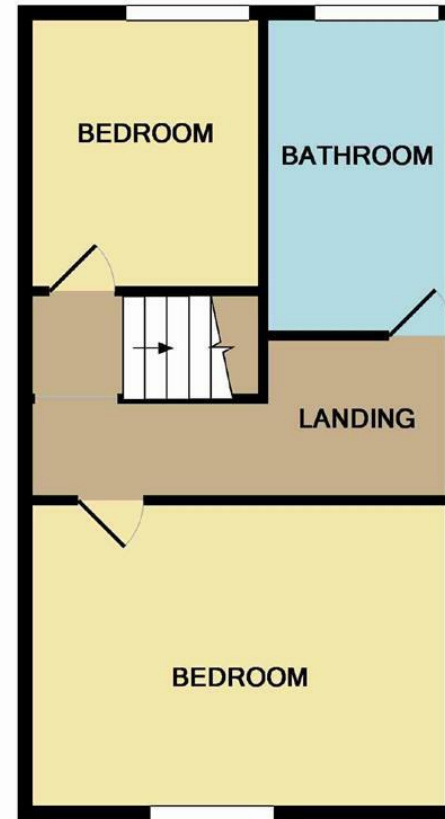

1ST FLOOR

Whilst every attempt has been made to ensure the accuracy of the floor plan contained here, measurements of doors, windows, rooms and any other items are approximate and no responsibility is taken for any error, omission, or mis-statement. This plan is for illustrative purposes only and should be used as such by any prospective purchaser. The services, systems and appliances shown have not been tested and no guarantee as to their operability or efficiency can be given  
 Made with Metropix ©2014.



These particulars are believed to be accurate but they are not guaranteed and do not form a contract. Neither Jordan Fishwick nor the vendor or lessor accept any responsibility in respect of these particulars, which are not intended to be statements or representations of fact and any intending purchaser or lessee must satisfy himself by inspection or otherwise as to the correctness of each of the statements contained in these particulars. Any floorplans on this brochure are for illustrative purposes only and are not necessarily to scale.

Offices at: Chorlton, Didsbury, Disley, Hale, Glossop, Macclesfield, Manchester Deansgate, Manchester Whitworth Street, New Mills, Sale, Wilmslow and Withington

01625 536300

wilmslow@jordanfishwick.co.uk  
 www.jordanfishwick.co.uk