



jordan fishwick

CHESHIRE
Orchard Close

Orchard Close, Cheshire, SK9 6AU

£1,695 PCM



The Property

AVAILABLE EARLY NOVEMBER PART FURNISHED - VIEWING ESSENTIAL TO APPRECIATE

This three bedroom mid mews is presented in IMMACULATE order. Located to the South of Wilmslow town centre and close to excellent local primary schools this attractive family home also benefits from a conservatory, garage and an enclosed courtyard garden to the rear.

Entrance hall, open plan lounge through diner leading to modern kitchen with appliances and pantry, conservatory with doors to enclosed sunny courtyard garden.

To the first floor two double bedrooms and good sized single bedroom with storage, modern bathroom with shower over bath.

Garage, off road parking

Contact Wilmslow 01625 536300 £1695.00pcm

COUNCIL TAX C

EPC D

Directions

SK9 6AU



Map data ©2024

- THREE BEDROOMS
- SOUTH WILMSLOW LOCATION
- WALKING DISTANCE OF LOCAL SHOPS
- GARAGE
- CONSERVATORY
- ENCLOSED COURTYARD GARDEN
- COUNCIL TAX C
- EPC D

Postcode - SK9 6AU

EPC Rating - D

Floor Area - sq ft

Local Authority - Cheshire East

Council Tax - C



GROUND FLOOR

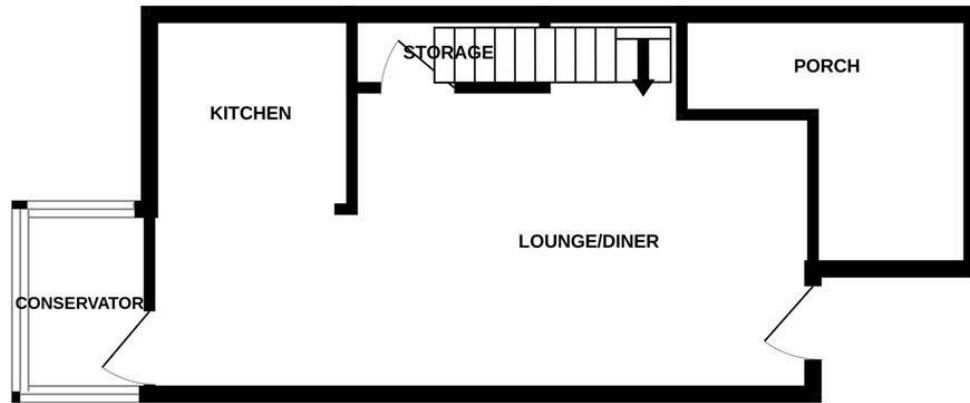

1ST FLOOR

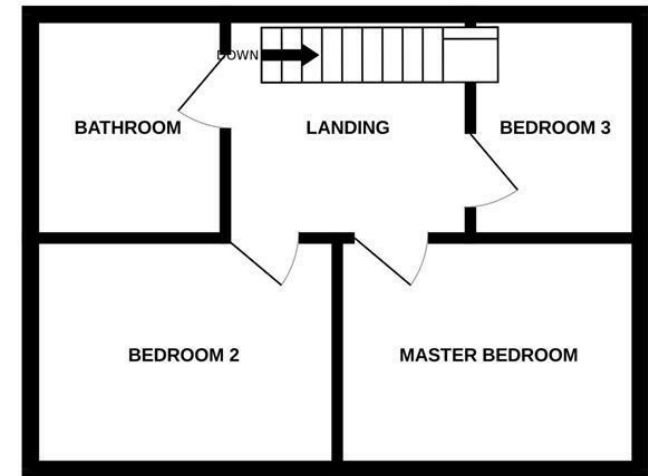

Measurements are approximate. Not to scale. Illustrative purposes only
Made with Metropix ©2024



These particulars are believed to be accurate but they are not guaranteed and do not form a contract. Neither Jordan Fishwick nor the vendor or lessor accept any responsibility in respect of these particulars, which are not intended to be statements or representations of fact and any intending purchaser or lessee must satisfy himself by inspection or otherwise as to the correctness of each of the statements contained in these particulars. Any floorplans on this brochure are for illustrative purposes only and are not necessarily to scale.

Offices at: Chorlton, Didsbury, Disley, Hale, Glossop, Macclesfield, Manchester Deansgate, Manchester Whitworth Street, New Mills, Sale, Wilmslow and Withington

01625 536300

wilmslow@jordanfishwick.co.uk
www.jordanfishwick.co.uk