



jordan fishwick

7 Chamberlain Drive, SK9 2SN
Guide Price £184,950

Chamberlain Drive Wilmslow

Guide Price £184,950



NO CHAIN. Two double bedroom ground floor apartment located a short drive away from Wilmslow centre. Wilmslow offers a wide range of shopping facilities, bars, restaurants, leisure centre and Wilmslow station which allows easy direct access to London Euston and Manchester City centre. The accommodation provides one off road parking space, communal hallways and private hallway, giving access to two double bedrooms and ample storage space. The apartment is UPVC double glazed and the generous sized living/dining space is complemented by a bay window to the front aspect. A modern three-piece suite bathroom and kitchen with matching wall and base mounted units. Locally there is a wide choice of schools, state and private, alongside beautiful countryside areas surrounding. Viewings essential.



- Ground Floor Accommodation
- Two Double Bedrooms
- Great Location
- Apartment
- Living/Dining Space
- Communal Gardens
- Parking



Energy Efficiency Rating		
	Current	Potential
Very energy efficient - lower running costs		
(92 plus) A		
(81-91) B		
(69-80) C	77	77
(55-68) D		
(39-54) E		
(21-38) F		
(1-20) G		
Not energy efficient - higher running costs		
England & Wales	EU Directive 2002/91/EC	

GROUND FLOOR

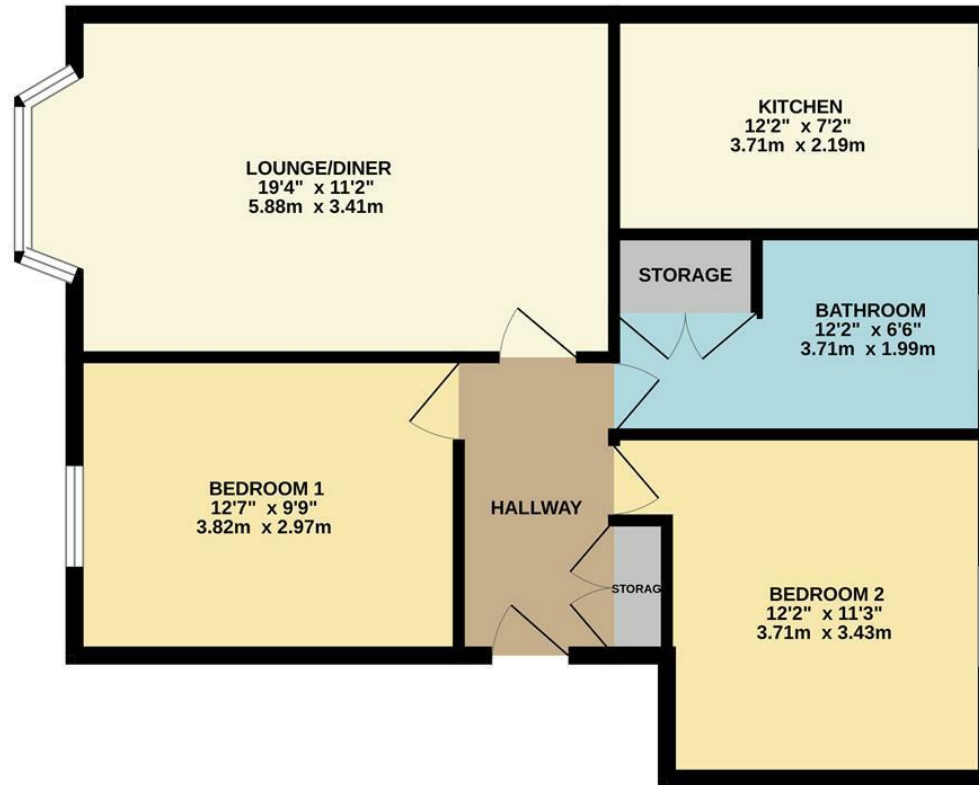

Measurements are approximate. Not to scale. Illustrative purposes only.
Made with Metropix ©2024



These particulars are believed to be accurate but they are not guaranteed and do not form a contract. Neither Jordan Fishwick nor the vendor or lessor accept any responsibility in respect of these particulars, which are not intended to be statements or representations of fact and any intending purchaser or lessee must satisfy himself by inspection or otherwise as to the correctness of each of the statements contained in these particulars. Any floorplans on this brochure are for illustrative purposes only and are not necessarily to scale.

Offices at: Chorlton, Didsbury, Disley, Hale, Glossop, Macclesfield, Manchester Deansgate, Manchester Whitworth Street, New Mills, Sale, Wilmslow and Withington

36-38 Alderley Road, Wilmslow, Cheshire, SK9 1JX

01625 532000

wilmslow@jordanfishwick.co.uk

www.jordanfishwick.co.uk